

# Total Soils Map

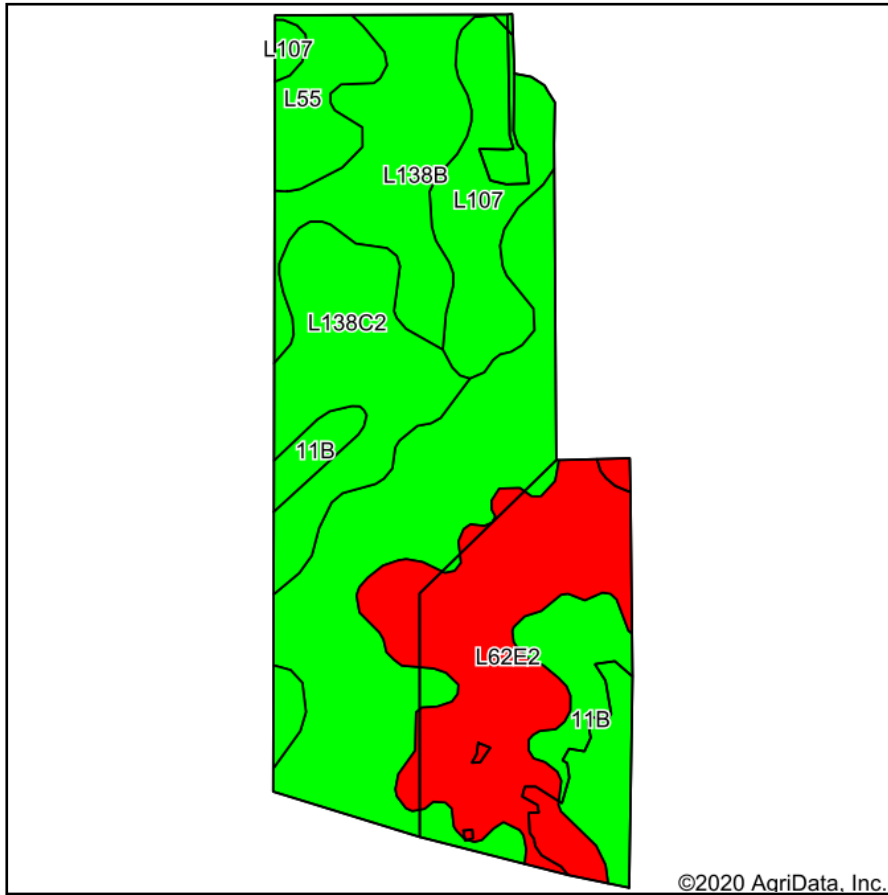

Soils data provided by USDA and NRCS.

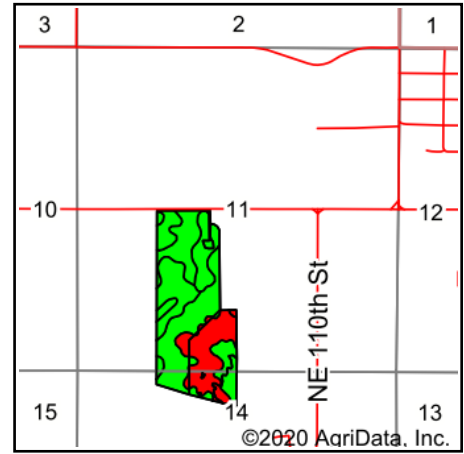

State: **Iowa**  
 County: **Polk**  
 Location: **11-79N-22W**  
 Township: **Beaver**  
 Acres: **79.52**  
 Date: **9/9/2020**

**PC PEOPLES**  
 COMPANY  
 INNOVATIVE. REAL ESTATE. SOLUTIONS.

Maps Provided By:

**surety**  
 CUSTOMIZED ONLINE MAPPING  
 © AgriData, Inc. 2020 www.AgriDataInc.com



Area Symbol: IA153. Soil Area Version: 22

Code	Soil Description	Acres	Percent of field	CSR2 Legend	Non-Irr Class *c	*i Cor n	*i Soybeans	CSR2**	CSR	*n NCCPI Overall
L138B	Clarion loam, Bemis moraine, 2 to 6 percent slopes	30.35	38.2%		Ile	80	23.2	88		80
L62E2	Storden loam, Bemis moraine, 10 to 22 percent slopes, moderately eroded	17.78	22.4%		IVe	0	0	32		59
L138C2	Clarion loam, Bemis moraine, 6 to 10 percent slopes, moderately eroded	11.18	14.1%		IIIe	0	0	83		67
L107	Webster clay loam, Bemis moraine, 0 to 2 percent slopes	8.65	10.9%		IIw	0	0	88		84
11B	Colo-Judson silty clay loams, 0 to 5 percent slopes, occasionally flooded	7.70	9.7%		IIw	216	62.6	80	68	87
L55	Nicollet loam, 1 to 3 percent slopes	3.86	4.9%		Ie	0	0	91		85
<b>Weighted Average</b>						<b>51.4</b>	<b>14.9</b>	<b>74.1</b>	<b>*-</b>	<b>*n 74.8</b>

\*\*IA has updated the CSR values for each county to CSR2.

\*- CSR weighted average cannot be calculated on the current soils data, use prior data version for csr values.

\*i Yield data provided by the ISPAID Database version 8.1.1 developed by IA State University.

\*n: The aggregation method is "Weighted Average using all components"

\*c: Using Capabilities Class Dominant Condition Aggregation Method

Soils data provided by USDA and NRCS.