

Soils Map

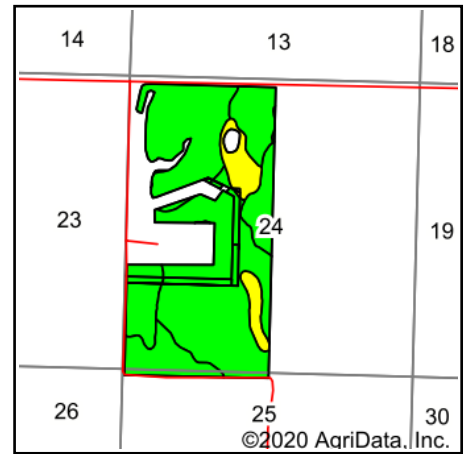

Soils data provided by USDA and NRCS.



State: **South Dakota**
 County: **Mellette**
 Location: **24-40N-32W**
 Township: **Blackpipe**
 Acres: **252.49**
 Date: **8/21/2020**

PC PEOPLES
 COMPANY
 INNOVATIVE. REAL ESTATE. SOLUTIONS.

Maps Provided By:

surety
 CUSTOMIZED ONLINE MAPPING
 © AgriData, Inc. 2020 www.AgriDataInc.com



Area Symbol: SD095, Soil Area Version: 19						
Code	Soil Description	Acres	Percent of field	PI Legend	Non-Irr Class *c	Productivity Index
HuB	Huggins-Kadoka silt loams, 2 to 5 percent slopes	102.82	40.7%		IIIe	73
Ka	Kadoka-Kube silt loams	90.20	35.7%		IIc	80
HuA	Huggins-Kadoka silt loams, 0 to 2 percent slopes	39.32	15.6%		IIIs	81
HnB	Huggins silt loam, 2 to 5 percent slopes	19.97	7.9%		IIIe	67
W	Water	0.18	0.1%		VIII	0
Weighted Average						76.2

*c: Using Capabilities Class Dominant Condition Aggregation Method
 Soils data provided by USDA and NRCS.