

# Est. Tillable Soils Map

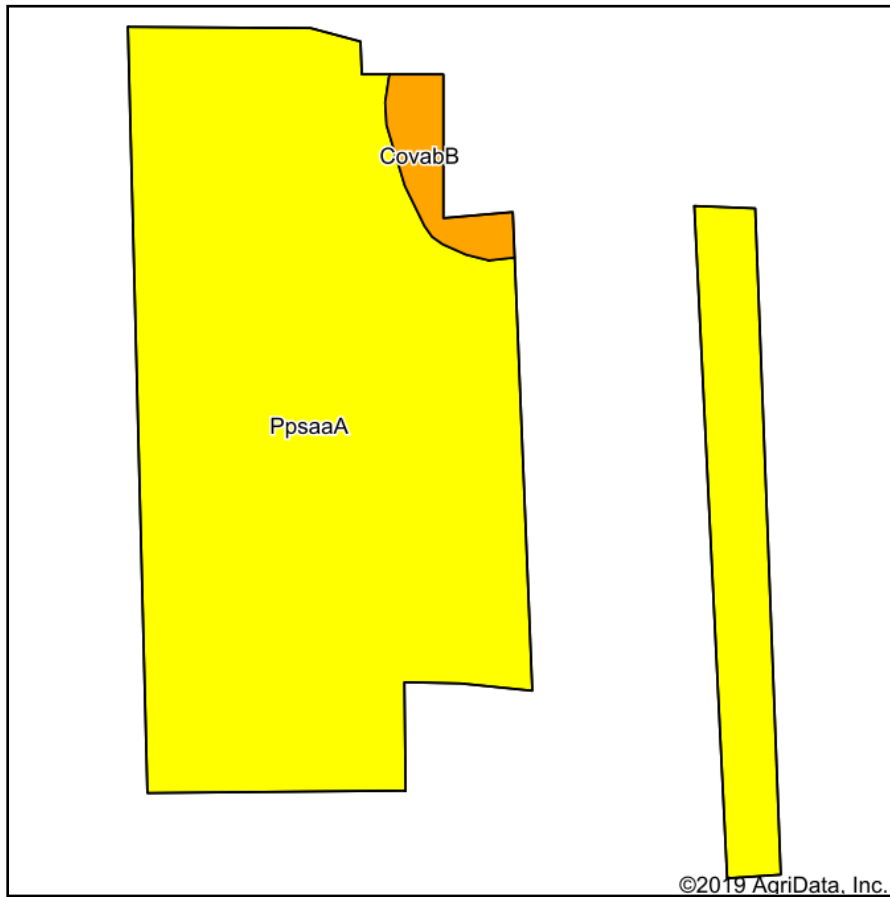

Soils data provided by USDA and NRCS.

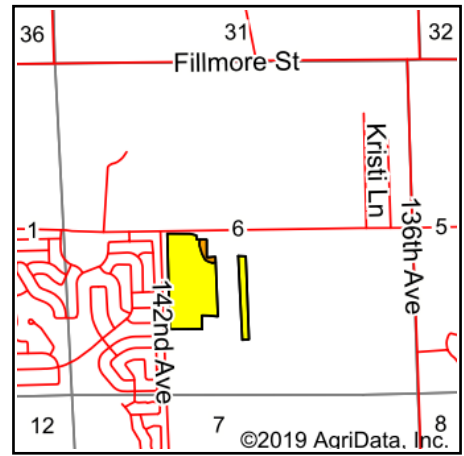

State: **Michigan**  
 County: **Ottawa**  
 Location: **6-6N-15W**  
 Township: **Olive**  
 Acres: **27.18**  
 Date: **3/12/2020**



Maps Provided By:



© AgriData, Inc. 2019

www.AgriDataInc.com



Area Symbol: M1139, Soil Area Version: 14

Code	Soil Description	Acres	Percent of field	Non-Irr Class Legend	Non-Irr Class *c	*n NCCPI Overall
PpsaaA	Pipestone-Covert-Saugatuck sands, 0 to 3 percent slopes	26.28	96.7%		IIIw	37
CovabB	Covert-Pipestone sands, 0 to 6 percent slopes	0.90	3.3%		IVs	31
<b>Weighted Average</b>						<b>*n 36.8</b>

\*n: The aggregation method is "Weighted Average using major components"

\*c: Using Capabilities Class Dominant Condition Aggregation Method

Soils data provided by USDA and NRCS.