

# Est. Tillable Soils Map

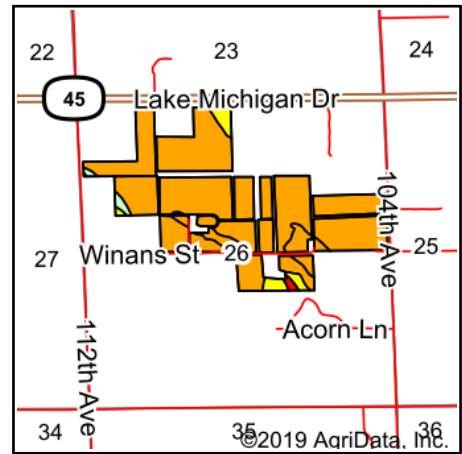

Soils data provided by USDA and NRCS.



State: **Michigan**  
 County: **Ottawa**  
 Location: **26-7N-15W**  
 Township: **Robinson**  
 Acres: **161.92**  
 Date: **3/11/2020**



Maps Provided By:



Area Symbol: M1139, Soil Area Version: 14

Code	Soil Description	Acres	Percent of field	Non-Irr Class Legend	Non-Irr Class *c	*n NCCPI Overall
Gm	Granby loamy sand, lake plain, 0 to 2 percent slopes	143.55	88.7%		IVw	40
CovabB	Covert-Pipestone sands, 0 to 6 percent slopes	9.64	6.0%		IVs	31
PpsaaA	Pipestone-Covert-Saugatuck sands, 0 to 3 percent slopes	6.36	3.9%		IIIw	37
WuC	Wind eroded land, sloping	1.61	1.0%			
PifabD	Plainfield sand, lake plain, 6 to 18 percent slopes	0.76	0.5%		VIIs	32
Weighted Average						*n 38.9

\*n: The aggregation method is "Weighted Average using major components"

\*c: Using Capabilities Class Dominant Condition Aggregation Method

Soils data provided by USDA and NRCS.