

Est. Tillable Soils Map

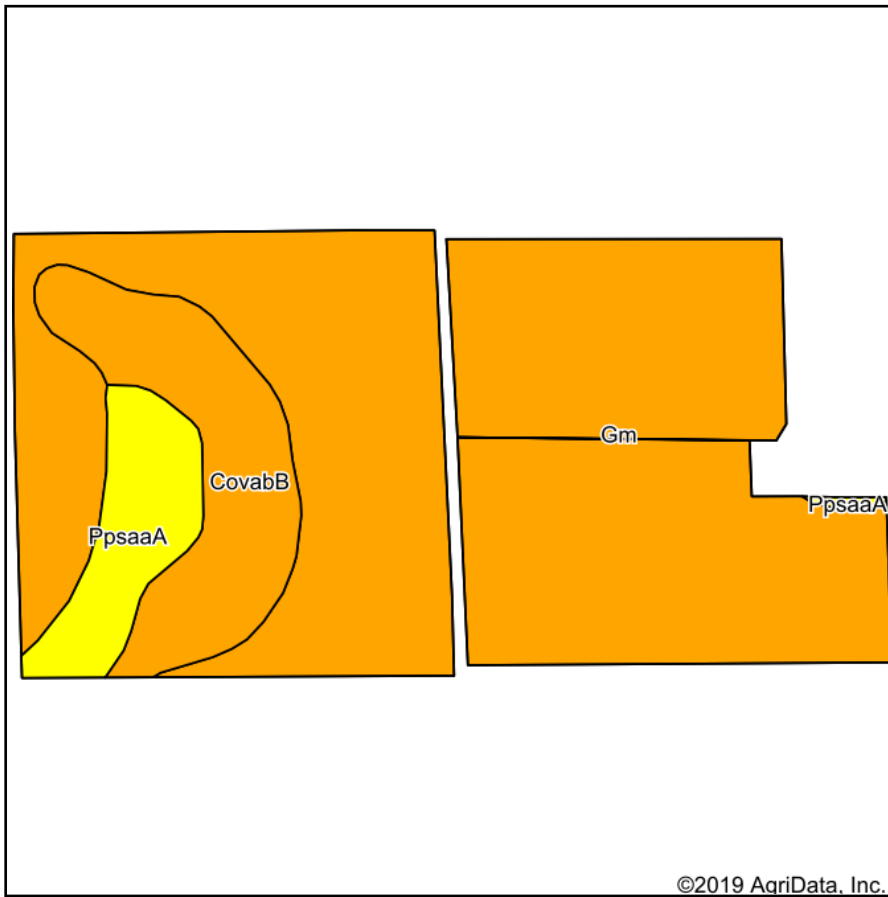

Soils data provided by USDA and NRCS.

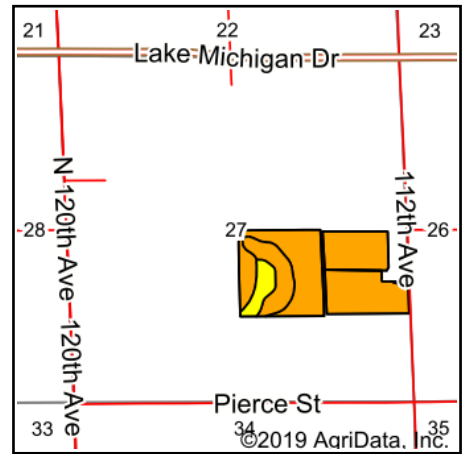

State: **Michigan**
 County: **Ottawa**
 Location: **27-7N-15W**
 Township: **Robinson**
 Acres: **71.55**
 Date: **3/11/2020**



Maps Provided By:



Area Symbol: M1139, Soil Area Version: 14

Code	Soil Description	Acres	Percent of field	Non-Irr Class Legend	Non-Irr Class *c	*n NCCPI Overall
Gm	Granby loamy sand, lake plain, 0 to 2 percent slopes	56.23	78.6%		IVw	40
CovabB	Covert-Pipestone sands, 0 to 6 percent slopes	9.92	13.9%		IVs	31
PpsaaA	Pipestone-Covert-Saugatuck sands, 0 to 3 percent slopes	5.40	7.5%		IIIw	37
Weighted Average						*n 38.5

*n: The aggregation method is "Weighted Average using major components"

*c: Using Capabilities Class Dominant Condition Aggregation Method

Soils data provided by USDA and NRCS.