

Total Soils Map

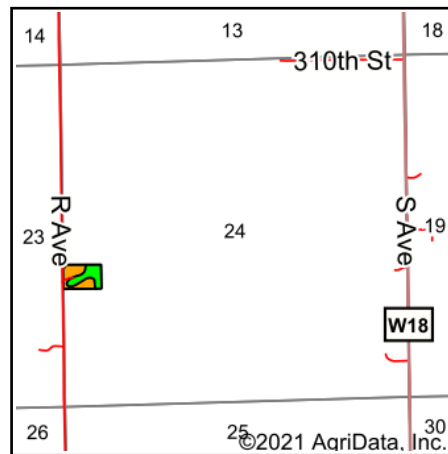

Soils data provided by USDA and NRCS.



State: **Iowa**
 County: **Iowa**
 Location: **24-78N-10W**
 Township: **Fillmore**
 Acres: **5**
 Date: **3/4/2021**



Maps Provided By:



Area Symbol: IA095, Soil Area Version: 30							
Code	Soil Description	Acres	Percent of field	CSR2 Legend	Non-Irr Class *c	CSR2**	CSR
76D2	Ladoga silt loam, 9 to 14 percent slopes, eroded	2.75	55.0%		IIIe	49	55
76C2	Ladoga silt loam, 5 to 9 percent slopes, eroded	2.25	45.0%		IIIe	75	65
Weighted Average						60.7	59.5

**IA has updated the CSR values for each county to CSR2.
 *c: Using Capabilities Class Dominant Condition Aggregation Method
 Soils data provided by USDA and NRCS.