

CRP Soils Map

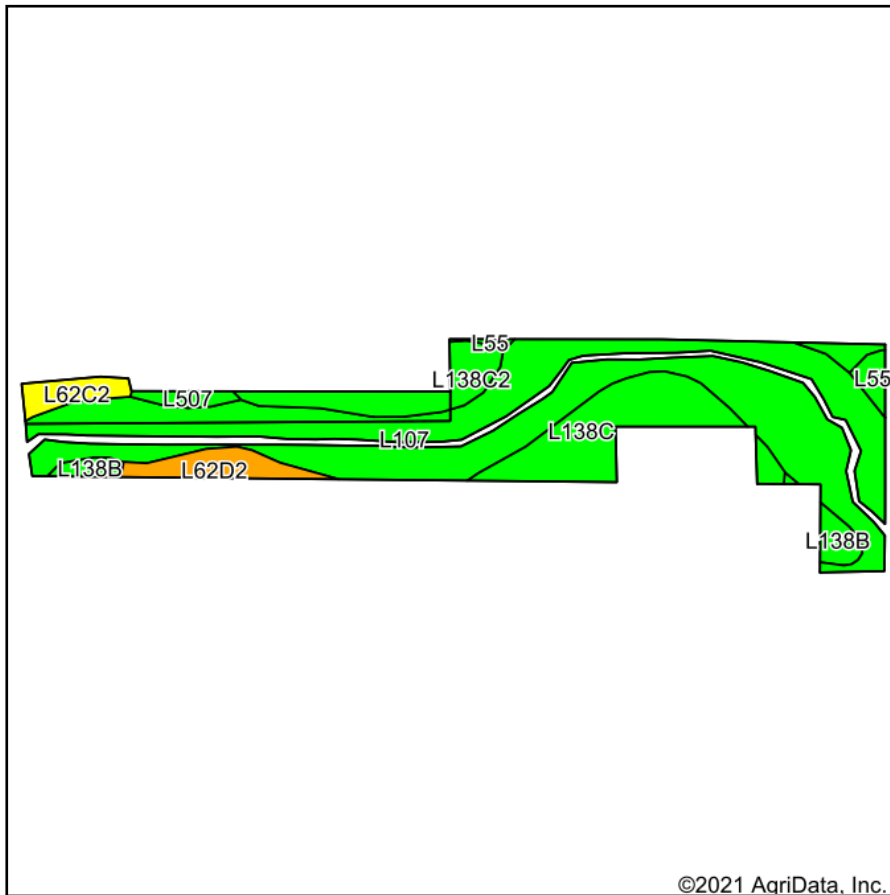

Soils data provided by USDA and NRCS.

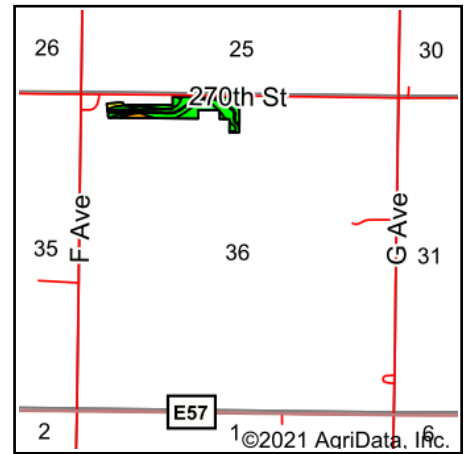

State: **Iowa**
 County: **Boone**
 Location: **36-83N-28W**
 Township: **Beaver**
 Acres: **13.75**
 Date: **6/15/2021**



Maps Provided By:



Area Symbol: IA015, Soil Area Version: 28

Code	Soil Description	Acres	Percent of field	CSR2 Legend	Non-Irr Class *c	*i Corn	*i Soybeans	CSR2**	*n NCCPI Overall
L107	Webster clay loam, Bemis moraine, 0 to 2 percent slopes	8.60	62.5%		IIw	0	0	88	84
L138C	Clarion loam, Bemis moraine, 6 to 10 percent slopes	2.03	14.8%		IIIe	0	0	84	77
L138C2	Clarion loam, Bemis moraine, 6 to 10 percent slopes, moderately eroded	1.01	7.3%		IIIe	0	0	83	67
L62D2	Storden loam, Bemis moraine, 10 to 16 percent slopes, moderately eroded	0.62	4.5%		IVe	0	0	41	65
L138B	Clarion loam, Bemis moraine, 2 to 6 percent slopes	0.45	3.3%		IIe	220.8	64	88	80
L62C2	Storden loam, Bemis moraine, 6 to 10 percent slopes, moderately eroded	0.41	3.0%		IIIe	0	0	64	68
L507	Canisteo clay loam, Bemis moraine, 0 to 2 percent slopes	0.39	2.8%		IIw	0	0	87	81
L55	Nicollet loam, 1 to 3 percent slopes	0.24	1.7%		Ie	0	0	91	85
Weighted Average						7.2	2.1	84.2	*n 80.2

**IA has updated the CSR values for each county to CSR2.

*i Yield data provided by the ISPAID Database version 8.1.1 developed by IA State University.

*n: The aggregation method is "Weighted Average using all components"

*c: Using Capabilities Class Dominant Condition Aggregation Method

Soils data provided by USDA and NRCS.