

# Tillable Soils Map

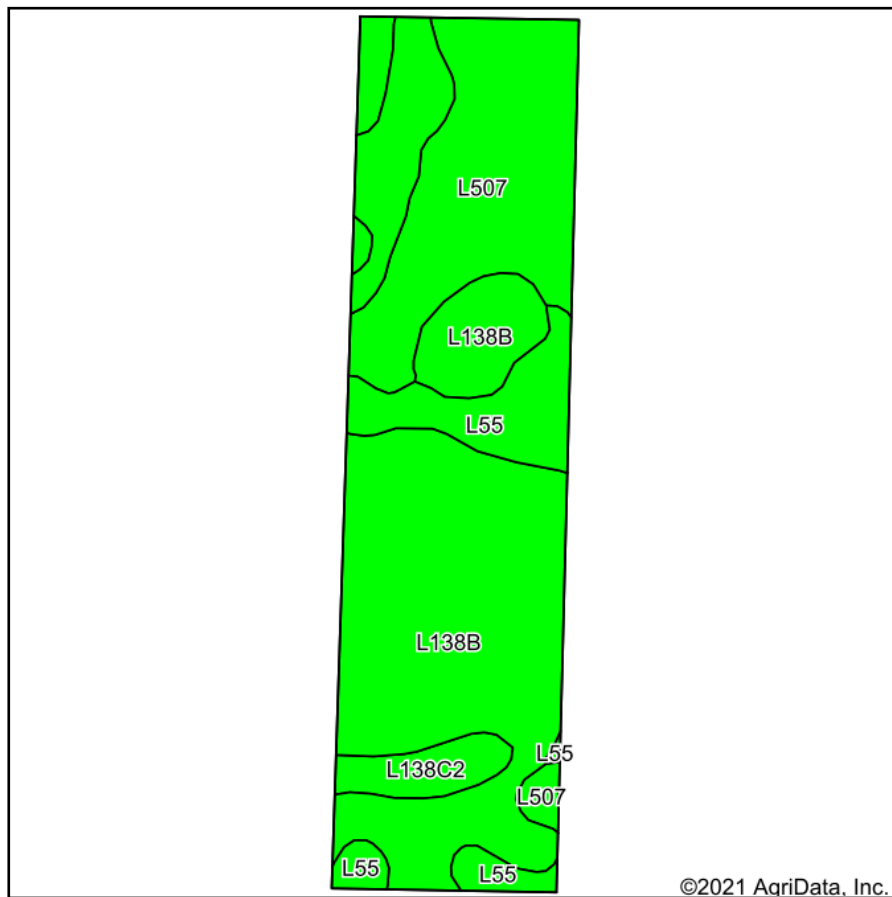

Soils data provided by USDA and NRCS.

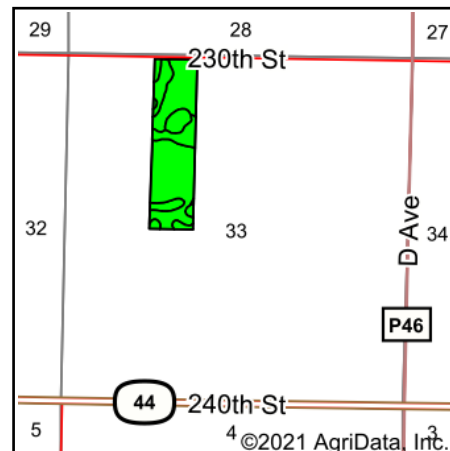

State: **Iowa**  
 County: **Dallas**  
 Location: **33-80N-29W**  
 Township: **Lincoln**  
 Acres: **39.5**  
 Date: **6/25/2021**

**PC PEOPLES**  
 COMPANY  
 INNOVATIVE. REAL ESTATE. SOLUTIONS.

Maps Provided By:

**surety**  
 CUSTOMIZED ONLINE MAPPING  
 © AgriData, Inc. 2021 www.AgriDataInc.com



Area Symbol: IA049, Soil Area Version: 26

Code	Soil Description	Acres	Percent of field	CSR2 Legend	Non-Irr Class *c	*i Corn	*i Soybeans	CSR2**	*n NCCPI Overall
L138B	Clarion loam, Bemis moraine, 2 to 6 percent slopes	20.33	51.5%		Ile	80	23.2	88	80
L507	Canisteo clay loam, Bemis moraine, 0 to 2 percent slopes	10.27	26.0%		Ilw	0	0	87	81
L55	Nicollet loam, 1 to 3 percent slopes	7.31	18.5%		Ie	0	0	91	85
L138C2	Clarion loam, Bemis moraine, 6 to 10 percent slopes, moderately eroded	1.59	4.0%		Ille	0	0	83	67
<b>Weighted Average</b>						<b>41.2</b>	<b>11.9</b>	<b>88.1</b>	<b>*n 80.7</b>

\*\*IA has updated the CSR values for each county to CSR2.

\*i Yield data provided by the ISPAID Database version 8.1.1 developed by IA State University.

\*n: The aggregation method is "Weighted Average using all components"

\*c: Using Capabilities Class Dominant Condition Aggregation Method

Soils data provided by USDA and NRCS.