

# Current Tillable Soils Map

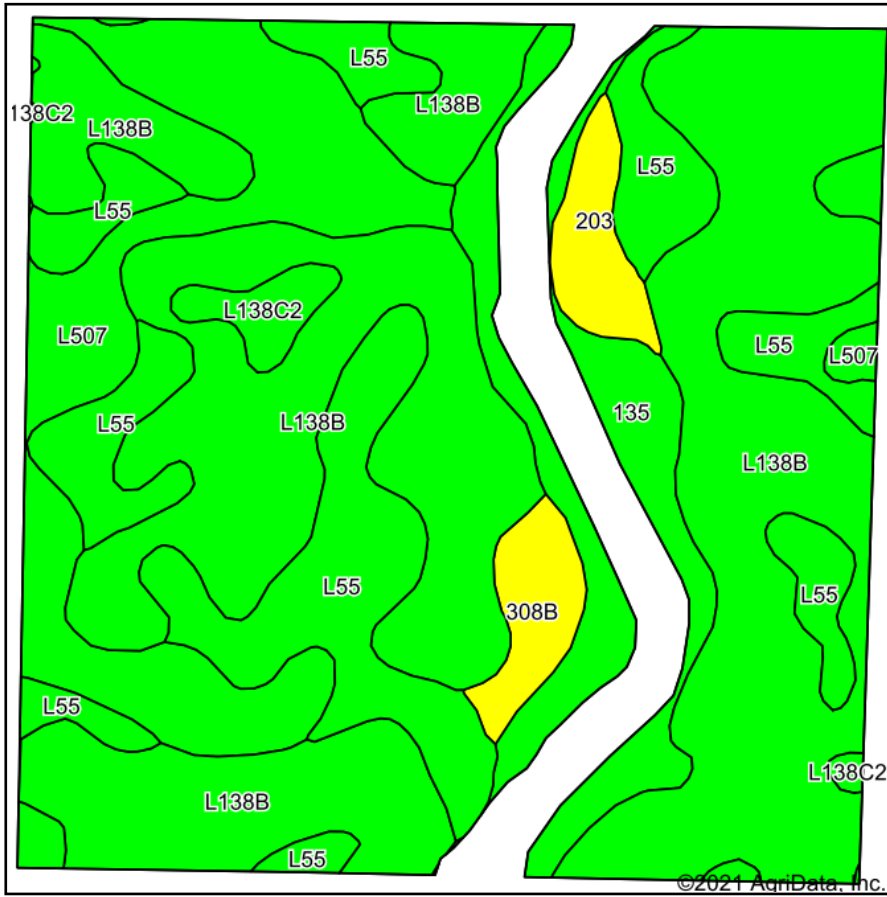

Soils data provided by USDA and NRCS.

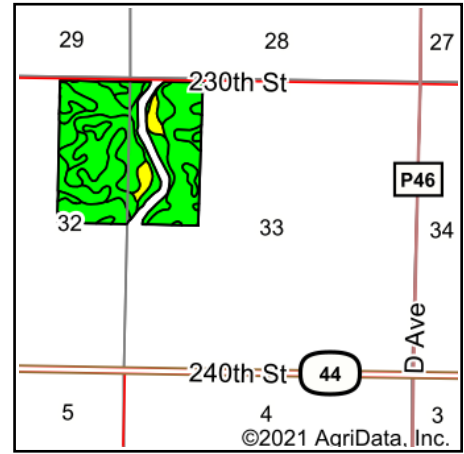

State: **Iowa**  
 County: **Dallas**  
 Location: **33-80N-29W**  
 Township: **Lincoln**  
 Acres: **142.27**  
 Date: **6/25/2021**

**PC PEOPLES**  
 COMPANY  
 INNOVATIVE. REAL ESTATE. SOLUTIONS.

Maps Provided By:

**surety**  
 CUSTOMIZED ONLINE MAPPING  
 © AgriData, Inc. 2021 www.AgriDataInc.com



Area Symbol: IA049, Soil Area Version: 26

Code	Soil Description	Acres	Percent of field	CSR2 Legend	Non-Irr Class *c	*i Corn	*i Soybeans	CSR2**	CSR	*n NCCPI Overall
L138B	Clarion loam, Bemis moraine, 2 to 6 percent slopes	73.39	51.6%		Ile	80	23.2	88		80
L55	Nicollet loam, 1 to 3 percent slopes	28.88	20.3%		Ie	0	0	91		85
L507	Canisteo clay loam, Bemis moraine, 0 to 2 percent slopes	19.82	13.9%		Ilw	0	0	87		81
135	Coland clay loam, 0 to 2 percent slopes, occasionally flooded	11.74	8.3%		Ilw	198.4	57.5	76	80	83
308B	Wadena loam, 2 to 6 percent slopes	3.18	2.2%		Ile	80	23.2	52	68	63
203	Cylinder loam, 0 to 2 percent slopes	3.13	2.2%		IlS	80	23.2	58	80	73
L138C2	Clarion loam, Bemis moraine, 6 to 10 percent slopes, moderately eroded	2.13	1.5%		Ille	0	0	83		67
Weighted Average						61.2	17.7	85.9	*-	*n 80.7

\*\*IA has updated the CSR values for each county to CSR2.

\*- CSR weighted average cannot be calculated on the current soils data, use prior data version for csr values.

\*i Yield data provided by the ISPAID Database version 8.1.1 developed by IA State University.

\*n: The aggregation method is "Weighted Average using all components"

\*c: Using Capabilities Class Dominant Condition Aggregation Method

Soils data provided by USDA and NRCS.