

# Tillable Soils Map

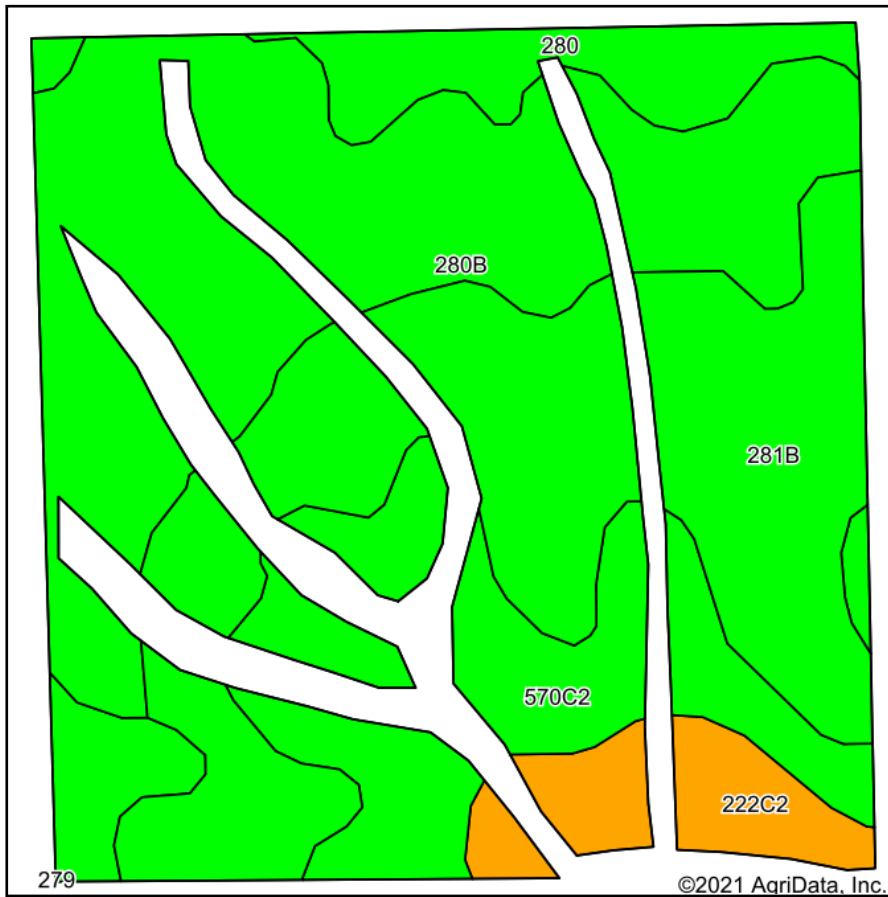

Soils data provided by USDA and NRCS.

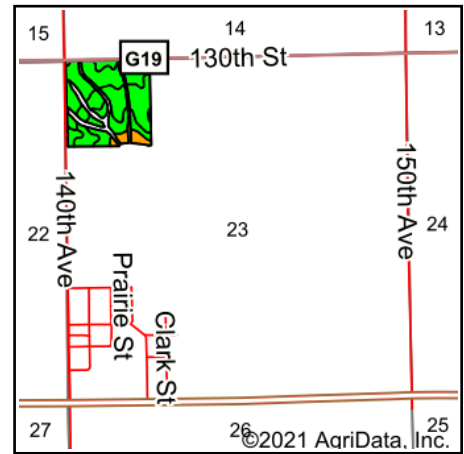

State: **Iowa**  
 County: **Keokuk**  
 Location: **23-77N-13W**  
 Township: **Prairie**  
 Acres: **34.12**  
 Date: **8/5/2021**

**PC PEOPLES**  
 COMPANY  
 INNOVATIVE. REAL ESTATE. SOLUTIONS.

Maps Provided By:

**surety**  
 CUSTOMIZED ONLINE MAPPING  
 © AgriData, Inc. 2021 www.AgriDataInc.com



Area Symbol: IA107, Soil Area Version: 25

Code	Soil Description	Acres	Percent of field	CSR2 Legend	Non-Irr Class *c	CSR2**	CSR
280B	Mahaska silty clay loam, 2 to 5 percent slopes	11.62	34.1%		Ile	89	90
281B	Otley silty clay loam, 2 to 5 percent slopes	11.53	33.8%		Ile	91	90
570C2	Nira silty clay loam, 5 to 9 percent slopes, moderately eroded	5.63	16.5%		IIle	71	67
280	Mahaska silty clay loam, 0 to 2 percent slopes	3.31	9.7%		Iw	94	95
222C2	Clarinda silty clay loam, 5 to 9 percent slopes, moderately eroded	2.03	5.9%		IVw	42	25
Weighted Average						<b>84.4</b>	<b>82.8</b>

\*\*IA has updated the CSR values for each county to CSR2.

\*c: Using Capabilities Class Dominant Condition Aggregation Method

Soils data provided by USDA and NRCS.