

Tillable Soils Map

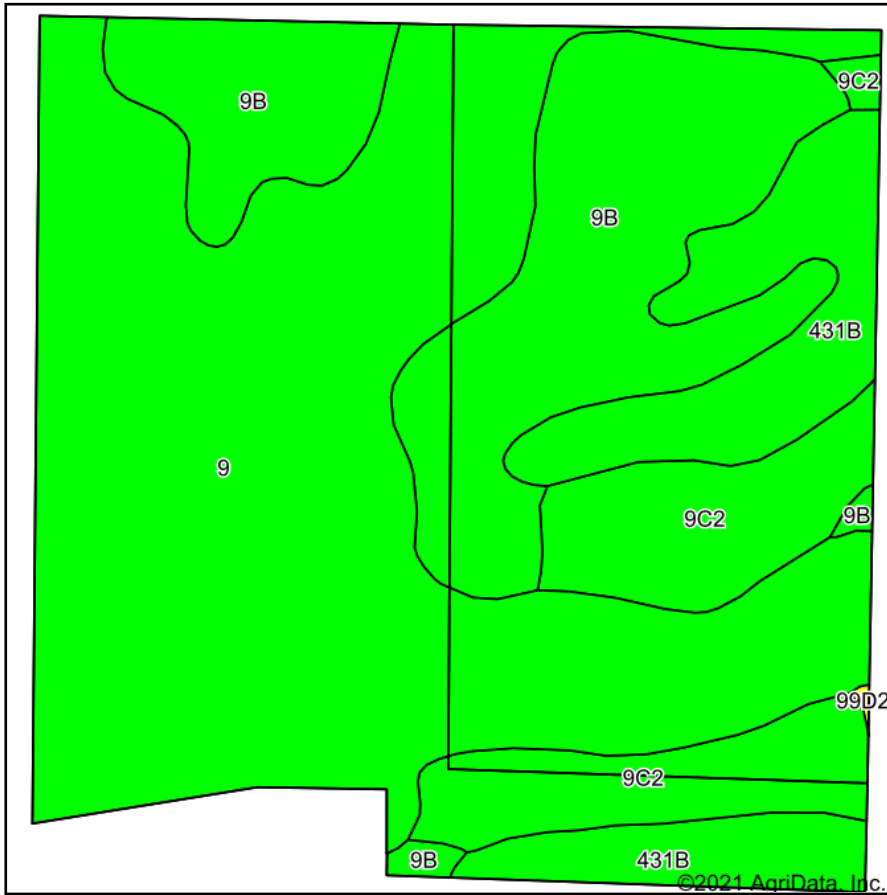

Soils data provided by USDA and NRCS.

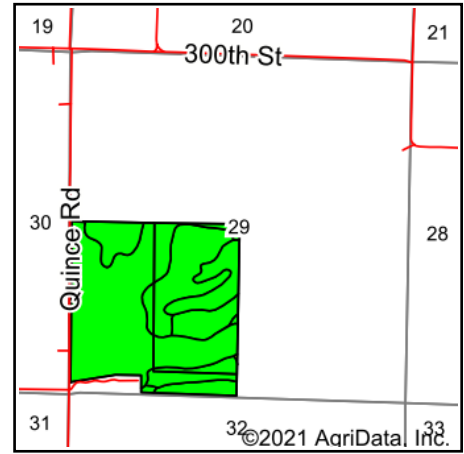

State: **Iowa**
 County: **Shelby**
 Location: **29-78N-38W**
 Township: **Monroe**
 Acres: **151.04**
 Date: **9/9/2021**

PC PEOPLES
 COMPANY
 INNOVATIVE. REAL ESTATE. SOLUTIONS.

Maps Provided By:

surety
 CUSTOMIZED ONLINE MAPPING
 © AgriData, Inc. 2021 www.AgriDataInc.com



Area Symbol: IA165, Soil Area Version: 27

Code	Soil Description	Acres	Percent of field	CSR2 Legend	Non-Irr Class *c	*i Corn	*i Soybeans	CSR2**	CSR	*n NCCPI Overall
9	Marshall silty clay loam, 0 to 2 percent slopes	79.73	52.8%		Iw	240	69.6	98	88	98
9B	Marshall silty clay loam, 2 to 5 percent slopes	35.57	23.6%		Ile	232	67.3	95	83	89
9C2	Marshall silty clay loam, 5 to 9 percent slopes, eroded	18.28	12.1%		IIle	211.2	61.2	87	66	91
431B	Judson-Ackmore-Colo, overwash complex, 1 to 5 percent slopes	17.38	11.5%		Ile	208	60.3	81	83	85
99D2	Exira silty clay loam, 9 to 14 percent slopes, eroded	0.08	0.1%		IIle	177.6	51.5	59	56	85
Weighted Average						230.9	67	94	83.6	*n 93.5

**IA has updated the CSR values for each county to CSR2.

*i Yield data provided by the ISPAID Database version 8.1.1 developed by IA State University.

*n: The aggregation method is "Weighted Average using all components"

*c: Using Capabilities Class Dominant Condition Aggregation Method

Soils data provided by USDA and NRCS.