

Soils Map

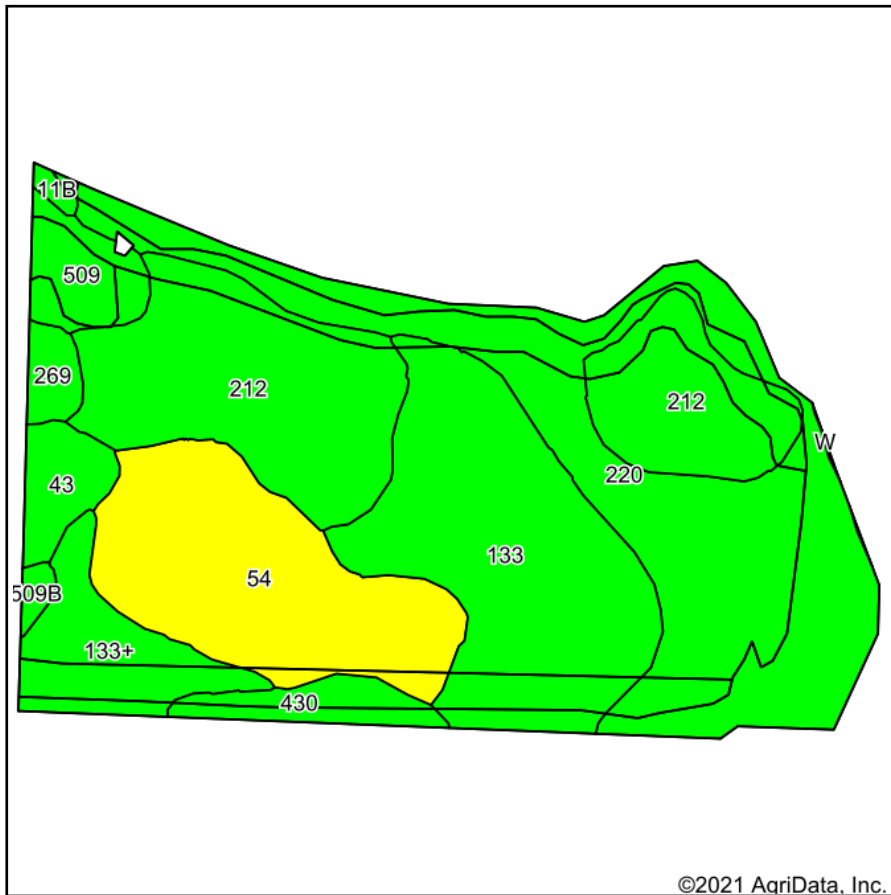

Soils data provided by USDA and NRCS.

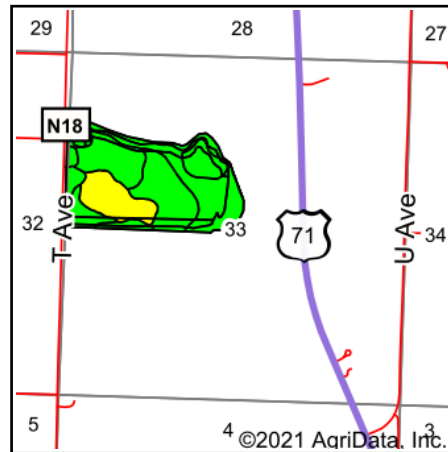

State: **Iowa**
 County: **Montgomery**
 Location: **33-72N-36W**
 Township: **Washington**
 Acres: **87.12**
 Date: **9/2/2021**



Maps Provided By:



Area Symbol: IA137, Soil Area Version: 28

Code	Soil Description	Acres	Percent of field	CSR2 Legend	Non-Irr Class *c	CSR2**	CSR	*n NCCPI Overall
220	Nodaway silt loam, 0 to 2 percent slopes, occasionally flooded	23.64	27.1%		Ilw	82	85	96
212	Kennebec silt loam, 0 to 2 percent slopes, occasionally flooded	19.06	21.9%		lw	91	86	95
133	Colo silty clay loam, deep loess, 0 to 2 percent slopes, occasionally flooded	16.94	19.4%		Ilw	78	80	81
54	Zook silty clay loam, 0 to 2 percent slopes, occasionally flooded	13.47	15.5%		Ilw	67	70	63
133+	Colo silt loam, deep loess, 0 to 2 percent slopes, overwash, occasionally flooded	5.07	5.8%		Ilw	78	85	85
509	Marshall silty clay loam, terrace, 0 to 2 percent slopes	2.71	3.1%		le	99	90	97
43	Bremer silty clay loam, 0 to 2 percent slopes, occasionally flooded	2.17	2.5%		Ilw	74	80	85
430	Ackmore silt loam, 0 to 2 percent slopes, occasionally flooded	2.17	2.5%		Ilw	77	83	90
269	Humeston silt loam, 0 to 2 percent slopes	1.14	1.3%		Illw	72	58	80
509B	Marshall silty clay loam, terrace, 2 to 5 percent slopes	0.41	0.5%		Ile	94	85	96
11B	Ackmore-Colo-Judson complex, 2 to 5 percent slopes	0.34	0.4%		Ilw	79	68	86
Weighted Average						80.8	81.5	*n 86.5

**IA has updated the CSR values for each county to CSR2.

*n: The aggregation method is "Weighted Average using all components"

*c: Using Capabilities Class Dominant Condition Aggregation Method

Soils data provided by USDA and NRCS.