

Soils Map

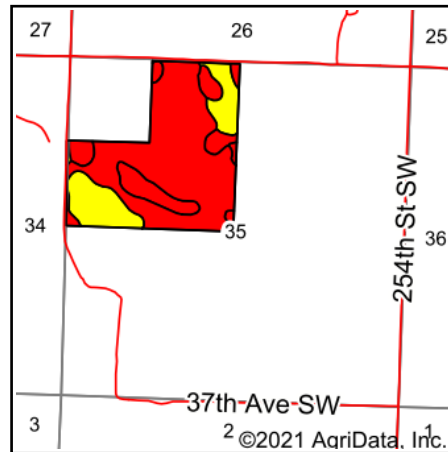

State: **North Dakota**
 County: **Ward**
 Location: **35-155N-86W**
 Township: **Mandan**
 Acres: **120**
 Date: **9/8/2021**

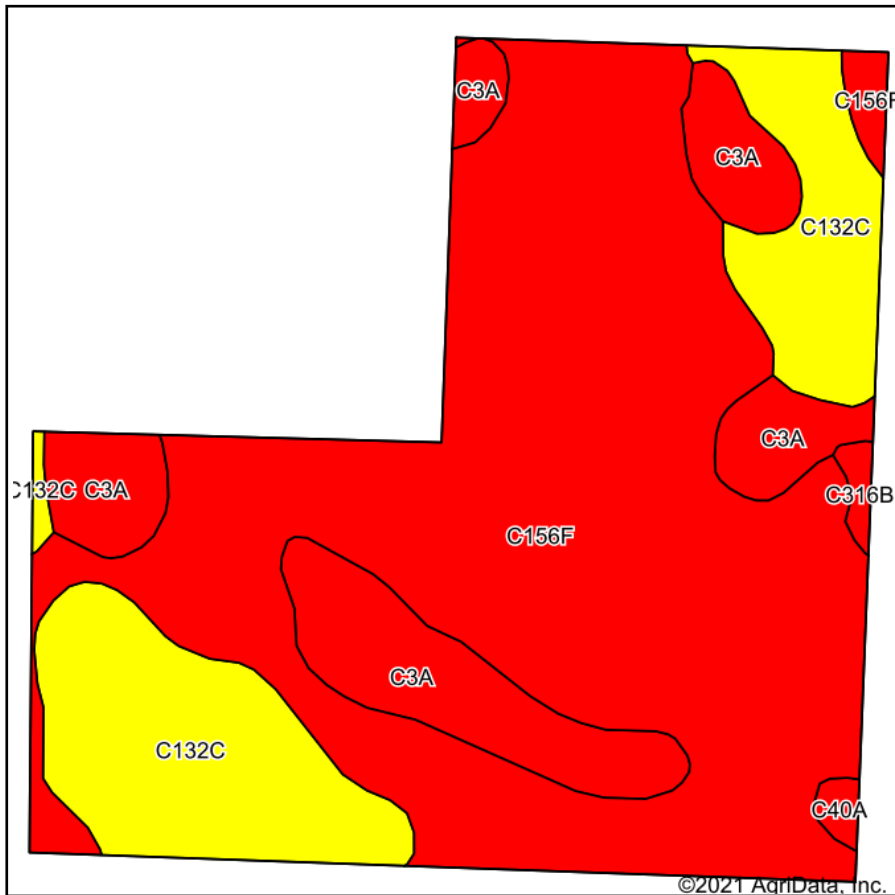

Soils data provided by USDA and NRCS.

Area Symbol: ND101, Soil Area Version: 20

Code	Soil Description	Acres	Percent of field	PI Legend	Non-Irr Class *c	Range Production (lbs/acre/yr)	Productivity Index	*n NCCPI Overall	*n NCCPI Corn	*n NCCPI Small Grains	*n NCCPI Soybeans
C156F	Zahl-Max-Bowbells loams, 6 to 35 percent slopes	76.49	63.7%		Vllc	2422	36	25	15	15	24
C132C	Williams-Zahl-Zahill complex, 6 to 9 percent slopes	24.07	20.1%		lllc	2433	61	52	26	28	52
C3A	Parnell silty clay loam, 0 to 1 percent slopes	18.28	15.2%		Vw	5939	20	21	3	21	4
C316B	Lihen-Telfer fine sandy loams, 2 to 6 percent slopes	0.60	0.5%		lllc	2500	47	27	20	22	27
C40A	Arveson loam, 0 to 1 percent slopes	0.56	0.5%		IVw	4457	30	39	12	25	37
Weighted Average						2969.8	38.6	*n 29.9	*n 15.4	*n 18.6	*n 26.6

*n: The aggregation method is "Weighted Average using all components"

*c: Using Capabilities Class Dominant Condition Aggregation Method

Soils data provided by USDA and NRCS.