

Soils Map

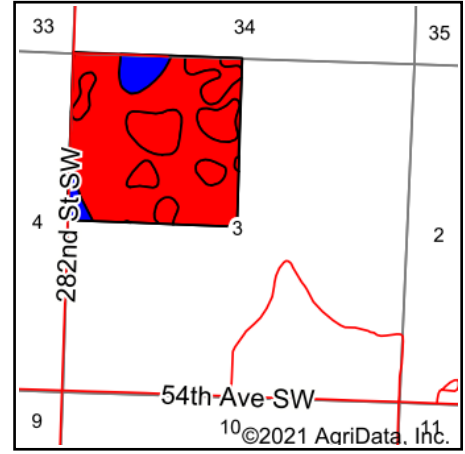

State: **North Dakota**
 County: **Ward**
 Location: **3-154N-86W**
 Township: **Tolgen**
 Acres: **160**
 Date: **9/8/2021**

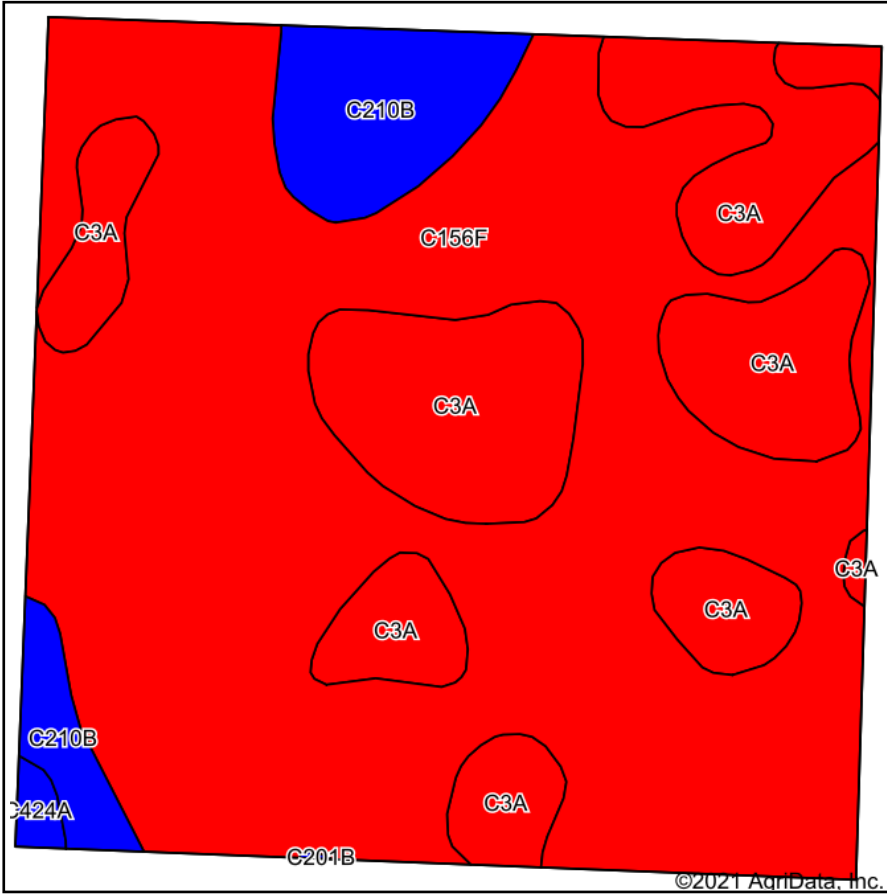

Maps Provided By:



Soils data provided by USDA and NRCS.

Area Symbol: ND101, Soil Area Version: 20

| Code | Soil Description | Acres | Percent of field | PI Legend | Non-Irr Class *c | Range Production (lbs/acre/yr) | Productivity Index | *n NCCPI Overall | *n NCCPI Corn | *n NCCPI Small Grains | *n NCCPI Soybeans |
|-------------------------|---|--------|------------------|-----------|------------------|--------------------------------|--------------------|------------------|----------------|-----------------------|-------------------|
| C156F | Zahl-Max-Bowbells loams, 6 to 35 percent slopes | 108.83 | 68.0% | | Vlle | 2422 | 36 | 25 | 15 | 15 | 24 |
| C3A | Parnell silty clay loam, 0 to 1 percent slopes | 39.03 | 24.4% | | Vw | 5939 | 20 | 21 | 3 | 21 | 4 |
| C210B | Williams-Bowbells loams, 3 to 6 percent slopes | 11.35 | 7.1% | | lle | 2876 | 83 | 53 | 27 | 30 | 53 |
| C424A | Minot silty clay, 0 to 2 percent slopes | 0.79 | 0.5% | | lls | 2344 | 84 | 40 | 20 | 23 | 40 |
| Weighted Average | | | | | | 3311.7 | 35.7 | *n 26.1 | *n 12.9 | *n 17.6 | *n 21.3 |

*n: The aggregation method is "Weighted Average using all components"

*c: Using Capabilities Class Dominant Condition Aggregation Method

Soils data provided by USDA and NRCS.