

Soils Map

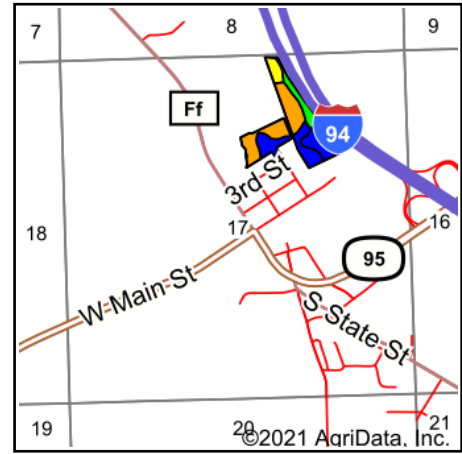

Soils data provided by USDA and NRCS.



State: **Wisconsin**
 County: **Jackson**
 Location: **17-22N-5W**
 Township: **Hixton**
 Acres: **24.08**
 Date: **9/8/2021**



Maps Provided By:



Area Symbol: WI053, Soil Area Version: 19

Code	Soil Description	Acres	Percent of field	NCCPI Overall Legend	Non-Irr Class *c	*n NCCPI Overall
1715D2	Council and Seaton soils, 12 to 20 percent slopes, moderately eroded	8.74	36.3%		IVe	67
424B	Merit silt loam, 1 to 6 percent slopes	5.74	23.8%		Ile	74
741B	Sebbo loam, 1 to 6 percent slopes	5.10	21.2%		Ile	74
626A	Arenzville silt loam, 0 to 3 percent slopes, occasionally flooded	2.74	11.4%		IIw	88
224D2	Elevasil sandy loam, 12 to 20 percent slopes, moderately eroded	1.65	6.9%		IVe	43
115vC2	Seaton silt loam, driftless valley, 6 to 12 percent slopes, moderately eroded	0.11	0.5%		IIle	80
Weighted Average						*n 71

*n: The aggregation method is "Weighted Average using all components"

*c: Using Capabilities Class Dominant Condition Aggregation Method

Soils data provided by USDA and NRCS.