

Soils Map

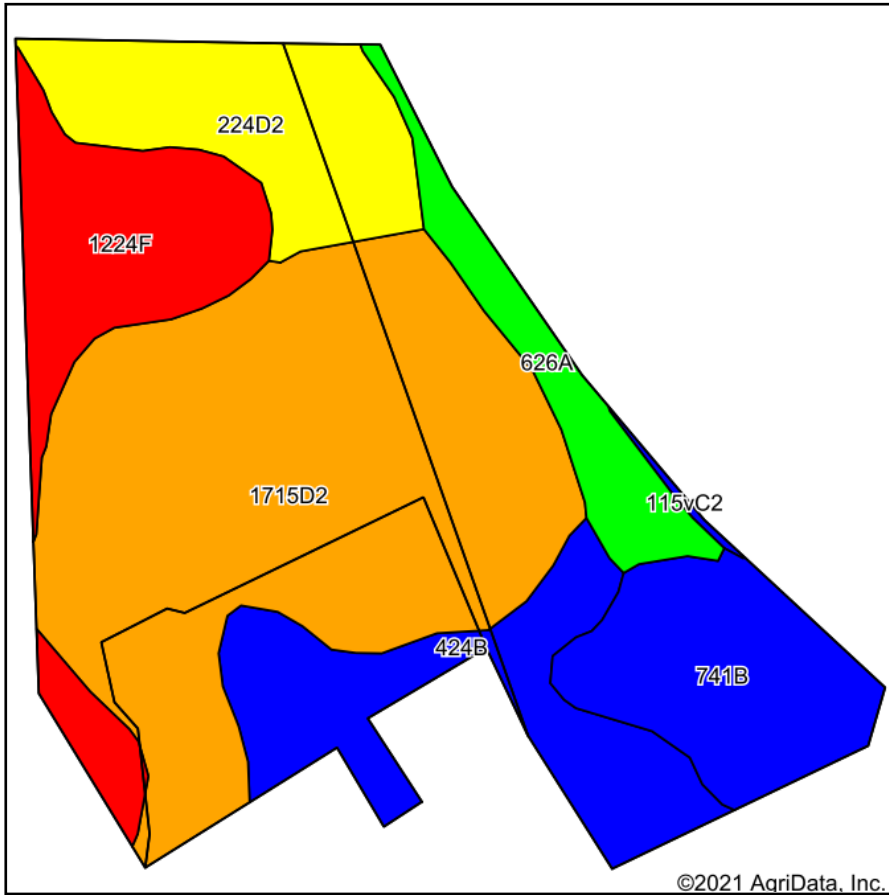

Soils data provided by USDA and NRCS.

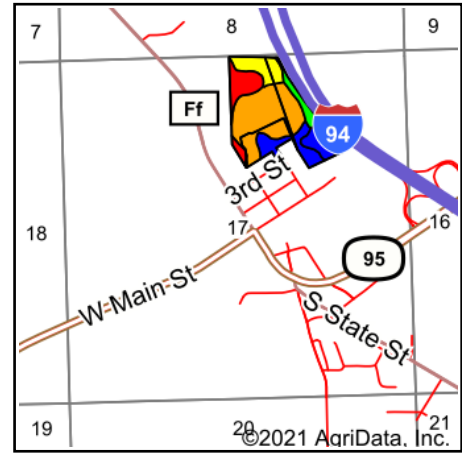

State: **Wisconsin**
 County: **Jackson**
 Location: **17-22N-5W**
 Township: **Hixton**
 Acres: **44.49**
 Date: **9/8/2021**



Maps Provided By:



Area Symbol: WI053, Soil Area Version: 19

Code	Soil Description	Acres	Percent of field	NCCPI Overall Legend	Non-Irr Class *c	*n NCCPI Overall
1715D2	Council and Seaton soils, 12 to 20 percent slopes, moderately eroded	19.76	44.4%		IVe	67
424B	Merit silt loam, 1 to 6 percent slopes	5.84	13.1%		Ile	74
1224F	Boone-Elevasil complex, 15 to 50 percent slopes	5.71	12.8%		VIIIs	9
224D2	Elevasil sandy loam, 12 to 20 percent slopes, moderately eroded	5.23	11.8%		IVe	43
741B	Sebbo loam, 1 to 6 percent slopes	5.10	11.5%		Ile	74
626A	Arenzville silt loam, 0 to 3 percent slopes, occasionally flooded	2.74	6.2%		IIW	88
115vC2	Seaton silt loam, driftless valley, 6 to 12 percent slopes, moderately eroded	0.11	0.2%		IIle	80
Weighted Average						*n 59.8

*n: The aggregation method is "Weighted Average using all components"

*c: Using Capabilities Class Dominant Condition Aggregation Method

Soils data provided by USDA and NRCS.