

Current Tillable Soils Map

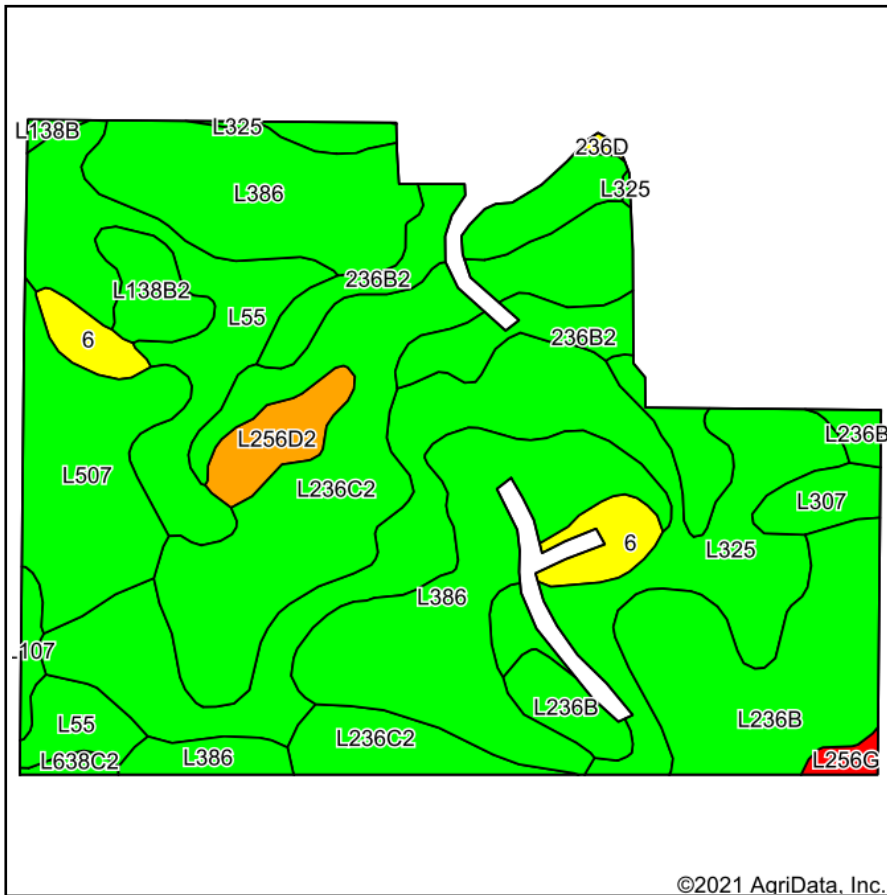

Soils data provided by USDA and NRCS.

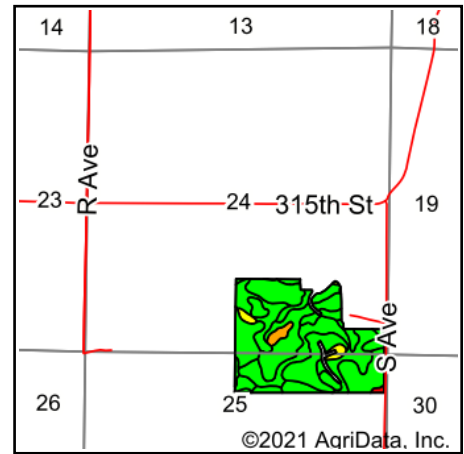

State: **Iowa**
 County: **Greene**
 Location: **24-82N-30W**
 Township: **Franklin**
 Acres: **98.91**
 Date: **9/13/2021**

PC PEOPLES
 COMPANY
 INNOVATIVE. REAL ESTATE. SOLUTIONS.

Maps Provided By:

surety
 CUSTOMIZED ONLINE MAPPING
 © AgriData, Inc. 2021 www.AgriDataInc.com



Area Symbol: IA073, Soil Area Version: 26

Code	Soil Description	Acres	Percent of field	CSR2 Legend	Non-Irr Class *c	*i Corn	*i Soybeans	CSR2**	CSR	*n NCCPI Overall
L325	Le Sueur loam, Bemis moraine, 1 to 3 percent slopes	19.36	19.6%		Ie	0	0	78		92
L386	Cordova clay loam, Bemis moraine, 0 to 2 percent slopes	19.17	19.4%		Ilw	0	0	77		86
L236C2	Lester loam, Bemis moraine, 6 to 10 percent slopes, moderately eroded	17.33	17.5%		Ille	0	0	77		74
L236B	Lester loam, Bemis moraine, 2 to 6 percent slopes	10.89	11.0%		Ile	0	0	85		89
L55	Nicollet loam, 1 to 3 percent slopes	9.35	9.5%		Ie	0	0	91		85
L507	Canisteo clay loam, Bemis moraine, 0 to 2 percent slopes	7.03	7.1%		Ilw	0	0	87		81
236B2	Lester loam, Bemis moraine, 2 to 6 percent slopes, moderately eroded	6.50	6.6%		Ile	208	60.3	81	76	75
6	Okoboji silty clay loam, 0 to 1 percent slopes	2.47	2.5%		Illw	185.6	53.8	59	58	76
L256D2	Lester-Storden complex, Bemis moraine, 10 to 16 percent slopes, moderately eroded	1.95	2.0%		IVe	0	0	45		70
L138B2	Clarion loam, Bemis moraine, 2 to 6 percent slopes, moderately eroded	1.77	1.8%		Ile	0	0	85		72
L307	Dundas silt loam, Bemis moraine, 0 to 2 percent slopes	1.38	1.4%		Ilw	0	0	81		88
L107	Webster clay loam, Bemis moraine, 0 to 2 percent slopes	0.60	0.6%		Ilw	0	0	88		84
L256G	Lester-Belview complex, Bemis moraine, 22 to 40 percent slopes	0.45	0.5%		Vlle	0	0	9		24
L638C2	Clarion-Storden complex, Bemis moraine, 6 to 10 percent slopes, moderately eroded	0.34	0.3%		Ille	0	0	75		70
L138B	Clarion loam, Bemis moraine, 2 to 6 percent slopes	0.20	0.2%		Ile	220.8	64	88		80
236D	Lester loam, Bemis moraine, 10 to 16 percent slopes	0.12	0.1%		IVe	168	48.7	53		78
Weighted Average						19	5.5	79.2	*-	*n 83.1

**IA has updated the CSR values for each county to CSR2.

*- CSR weighted average cannot be calculated on the current soils data, use prior data version for csr values.

*i Yield data provided by the ISPAID Database version 8.1.1 developed by IA State University.

*n: The aggregation method is "Weighted Average using all components"

*c: Using Capabilities Class Dominant Condition Aggregation Method

Soils data provided by USDA and NRCS.