

FSA Tillable Soils Map

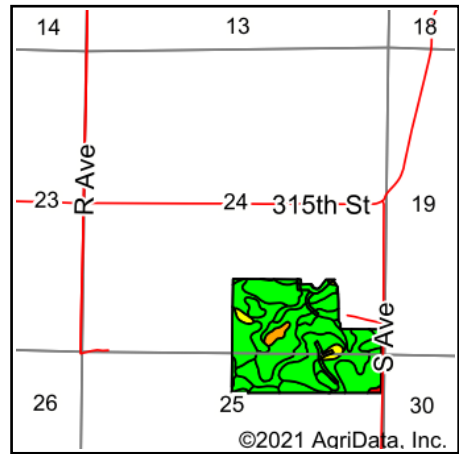

State: **Iowa**
 County: **Greene**
 Location: **24-82N-30W**
 Township: **Franklin**
 Acres: **102.31**
 Date: **9/13/2021**

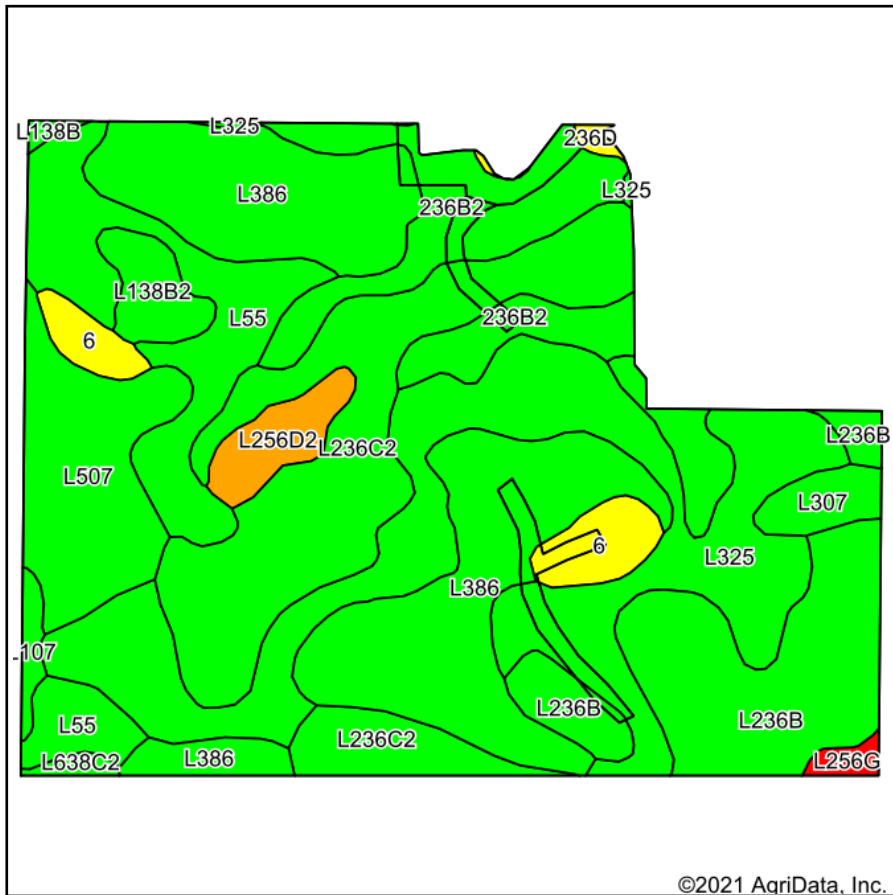

Soils data provided by USDA and NRCS.

©2021 AgriData, Inc.

© AgriData, Inc. 2021

www.AgriDataInc.com

Area Symbol: IA073, Soil Area Version: 26

Code	Soil Description	Acres	Percent of field	CSR2 Legend	Non-Irr Class *c	*i Corn	*i Soybeans	CSR2**	CSR	*n NCCPI Overall
L325	Le Sueur loam, Bemis moraine, 1 to 3 percent slopes	19.94	19.5%			le	0	0	78	92
L386	Cordova clay loam, Bemis moraine, 0 to 2 percent slopes	19.66	19.2%			llw	0	0	77	86
L236C2	Lester loam, Bemis moraine, 6 to 10 percent slopes, moderately eroded	17.55	17.2%			llle	0	0	77	74
L236B	Lester loam, Bemis moraine, 2 to 6 percent slopes	10.96	10.7%			lle	0	0	85	89
L55	Nicollet loam, 1 to 3 percent slopes	9.35	9.1%			le	0	0	91	85
236B2	Lester loam, Bemis moraine, 2 to 6 percent slopes, moderately eroded	8.11	7.9%			lle	208	60.3	81	76
L507	Canisteo clay loam, Bemis moraine, 0 to 2 percent slopes	7.03	6.9%			llw	0	0	87	81
6	Okoboji silty clay loam, 0 to 1 percent slopes	2.76	2.7%			lllw	185.6	53.8	59	58
L256D2	Lester-Storden complex, Bemis moraine, 10 to 16 percent slopes, moderately eroded	1.95	1.9%			lVe	0	0	45	70
L138B2	Clarion loam, Bemis moraine, 2 to 6 percent slopes, moderately eroded	1.77	1.7%			lle	0	0	85	72
L307	Dundas silt loam, Bemis moraine, 0 to 2 percent slopes	1.38	1.3%			llw	0	0	81	88
L107	Webster clay loam, Bemis moraine, 0 to 2 percent slopes	0.60	0.6%			llw	0	0	88	84
L256G	Lester-Belview complex, Bemis moraine, 22 to 40 percent slopes	0.45	0.4%			Vlle	0	0	9	24
L638C2	Clarion-Storden complex, Bemis moraine, 6 to 10 percent slopes, moderately eroded	0.34	0.3%			llle	0	0	75	70
236D	Lester loam, Bemis moraine, 10 to 16 percent slopes	0.26	0.3%			lVe	168	48.7	53	78
L138B	Clarion loam, Bemis moraine, 2 to 6 percent slopes	0.20	0.2%			lle	220.8	64	88	80
Weighted Average						22.4	6.5	79.2	*-	*n 83

**IA has updated the CSR values for each county to CSR2.

*- CSR weighted average cannot be calculated on the current soils data, use prior data version for csr values.

*i Yield data provided by the ISPAID Database version 8.1.1 developed by IA State University.

*n: The aggregation method is "Weighted Average using all components"

*c: Using Capabilities Class Dominant Condition Aggregation Method

Soils data provided by USDA and NRCS.