

# FSA Tillable Soils Map

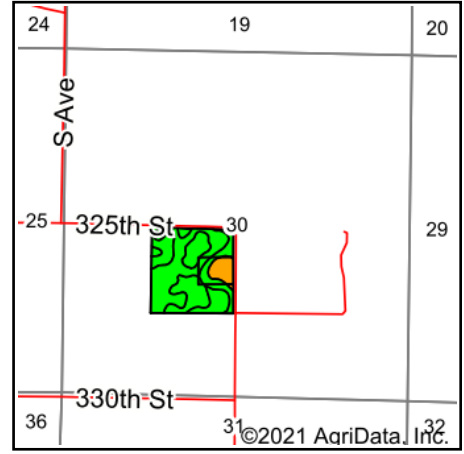

State: **Iowa**  
 County: **Greene**  
 Location: **30-82N-29W**  
 Township: **Washington**  
 Acres: **37.16**  
 Date: **9/13/2021**

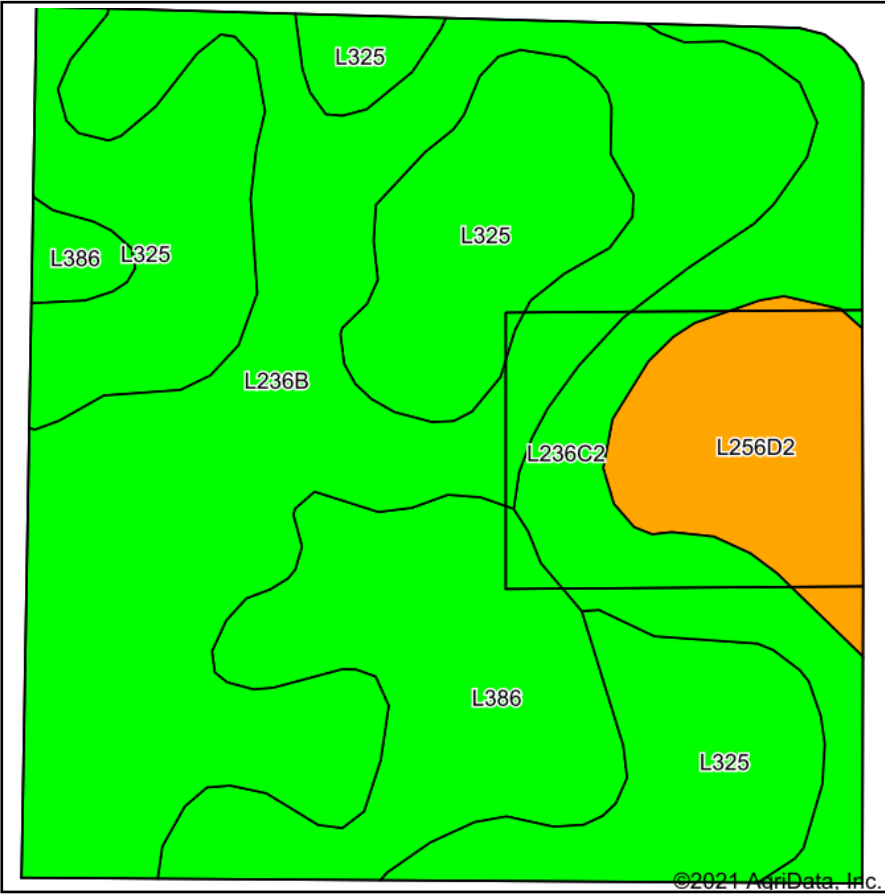

Maps Provided By:



© AgriData, Inc. 2021

www.AgriDataInc.com



Area Symbol: IA073, Soil Area Version: 26

Code	Soil Description	Acres	Percent of field	CSR2 Legend	Non-Irr Class *c	*i Corn	*i Soybeans	CSR2**	*n NCCPI Overall
L236B	Lester loam, Bemis moraine, 2 to 6 percent slopes	13.72	36.9%		Ile	0	0	85	89
L325	Le Sueur loam, Bemis moraine, 1 to 3 percent slopes	10.15	27.3%		Ie	0	0	78	92
L386	Cordova clay loam, Bemis moraine, 0 to 2 percent slopes	5.86	15.8%		IIw	0	0	77	86
L236C2	Lester loam, Bemis moraine, 6 to 10 percent slopes, moderately eroded	4.31	11.6%		IIIe	0	0	77	74
L256D2	Lester-Storden complex, Bemis moraine, 10 to 16 percent slopes, moderately eroded	3.12	8.4%		IVe	0	0	45	70
<b>Weighted Average</b>						*-	*-	<b>77.5</b>	<b>*n 86</b>

\*\*IA has updated the CSR values for each county to CSR2.

\*i Yield data provided by the ISPAID Database version 8.1.1 developed by IA State University.

\*n: The aggregation method is "Weighted Average using all components"

\*c: Using Capabilities Class Dominant Condition Aggregation Method

Soils data provided by USDA and NRCS.