

Soils Map

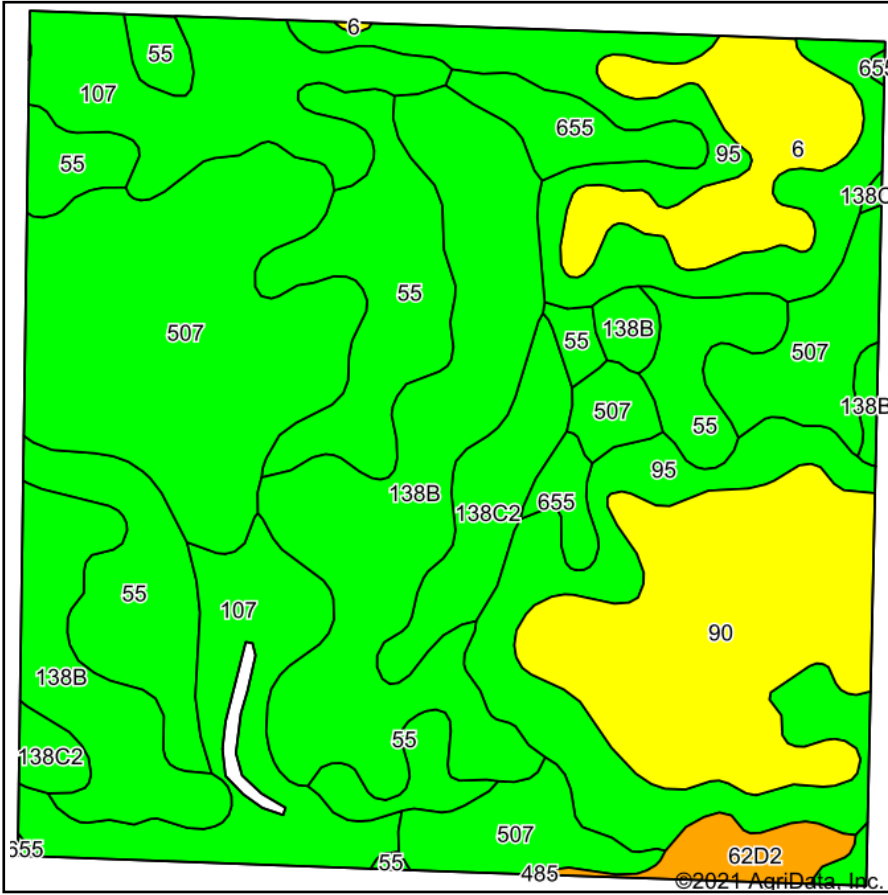

Soils data provided by USDA and NRCS.

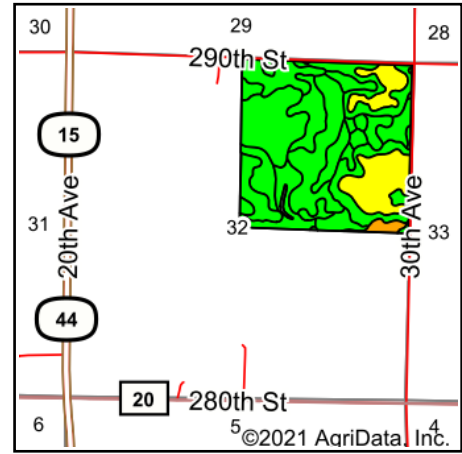

State: **Iowa**
 County: **Kossuth**
 Location: **32-97N-30W**
 Township: **Fenton**
 Acres: **157.88**
 Date: **8/24/2021**



Maps Provided By:



Area Symbol: IA109, Soil Area Version: 27

Code	Soil Description	Acres	Percent of field	CSR2 Legend	Non-Irr Class *c	CSR2**	CSR	*n NCCPI Overall
507	Canisteo clay loam, 0 to 2 percent slopes	29.23	18.5%	 	IIw	84	75	81
138B	Clarion loam, 2 to 6 percent slopes	27.25	17.3%	 	Ile	89	77	84
95	Harps clay loam, 0 to 2 percent slopes	23.14	14.7%	 	IIw	72	60	82
55	Nicollet clay loam, 1 to 3 percent slopes	22.62	14.3%	 	Iw	89	85	82
107	Webster clay loam, 0 to 2 percent slopes	18.16	11.5%	 	IIw	86	80	83
90	Okoboji mucky silt loam, 0 to 1 percent slopes	17.09	10.8%	 	IIIw	56	56	71
6	Okoboji silty clay loam, 0 to 1 percent slopes	7.74	4.9%	 	IIIw	59	54	76
138C2	Clarion loam, 6 to 10 percent slopes, moderately eroded	6.23	3.9%	 	IIIe	83	62	73
655	Crippin loam, 1 to 3 percent slopes	4.13	2.6%	 	Ie	91	80	87
62D2	Storden loam, 10 to 16 percent slopes, moderately eroded	2.29	1.5%	 	IVe	41	39	67
Weighted Average						79.3	71.2	*n 80.3

**IA has updated the CSR values for each county to CSR2.

*n: The aggregation method is "Weighted Average using all components"

*c: Using Capabilities Class Dominant Condition Aggregation Method

Soils data provided by USDA and NRCS.