

Tillable Soils Map

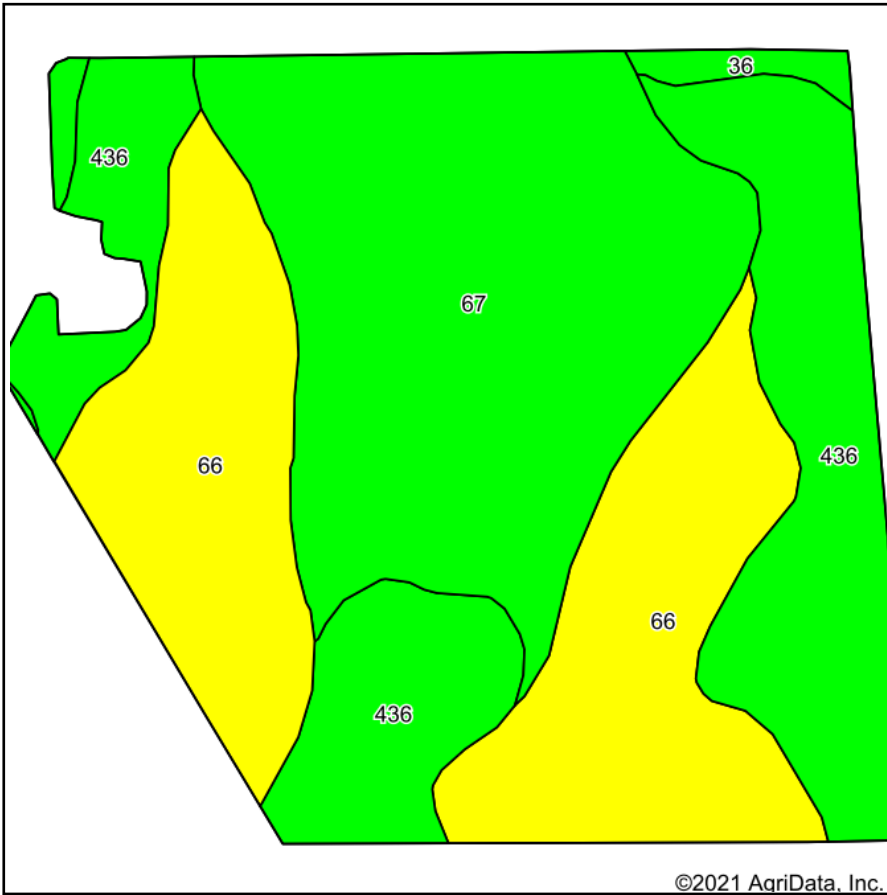

Soils data provided by USDA and NRCS.

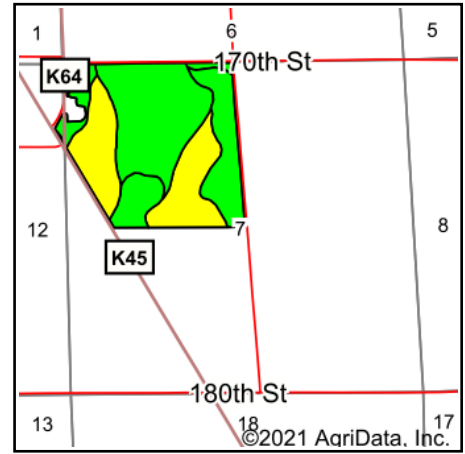

State: **Iowa**
 County: **Monona**
 Location: **7-84N-45W**
 Township: **Ashton**
 Acres: **149.8**
 Date: **9/23/2021**



Maps Provided By:



Area Symbol: IA133, Soil Area Version: 32

Code	Soil Description	Acres	Percent of field	CSR2 Legend	Non-Irr Class *c	Irr Class *c	CSR2**	*n NCCPI Overall
67	Woodbury silty clay, 0 to 2 percent slopes, rarely flooded	54.23	36.2%		IIIw		70	53
66	Luton silty clay, 0 to 2 percent slopes, rarely flooded	48.82	32.6%		IIIw		57	50
436	Lakeport silty clay loam, 0 to 2 percent slopes, rarely flooded	44.04	29.4%		I		88	71
36	Salix silty clay loam, 0 to 2 percent slopes, rarely flooded	2.71	1.8%		I	I	100	94
Weighted Average							71.6	*n 58.1

**IA has updated the CSR values for each county to CSR2.

*n: The aggregation method is "Weighted Average using all components"

*c: Using Capabilities Class Dominant Condition Aggregation Method

Soils data provided by USDA and NRCS.