

Soils Map

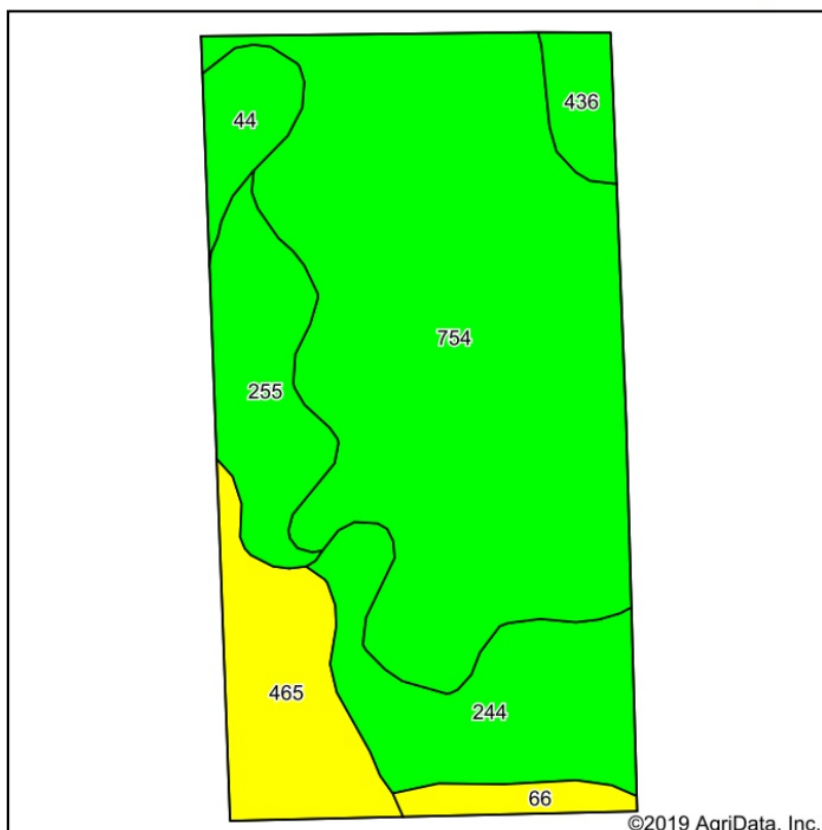

Soils data provided by USDA and NRCS.

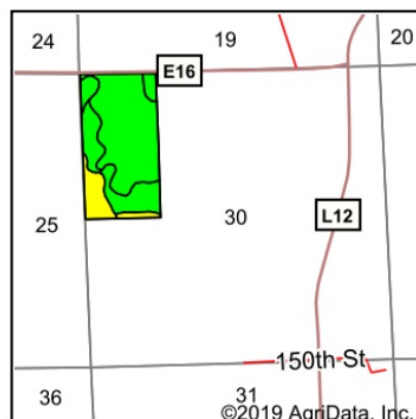

State: **Iowa**
 County: **Monona**
 Location: **30-85N-44W**
 Township: **Grant**
 Acres: **79.34**
 Date: **4/23/2020**



Area Symbol: IA133, Soil Area Version: 31							
Code	Soil Description	Acres	Percent of field	CSR2 Legend	Non-Irr Class *c	CSR2**	CSR
754	Larpenteur silt loam, 0 to 2 percent slopes, rarely flooded	45.21	57.0%		I	100	80
244	Blend silty clay, 0 to 2 percent slopes, rarely flooded	11.21	14.1%		IIIw	81	51
465	Tieville silty clay, 0 to 2 percent slopes, rarely flooded	8.44	10.6%		IIIw	62	35
255	Cooper silty clay loam, 0 to 2 percent slopes, rarely flooded	7.50	9.5%		IIw	85	70
44	Blencoe silt clay, 0 to 2 percent slopes, rarely flooded	2.94	3.7%		IIw	87	70
436	Lakeport silty clay loam, 0 to 2 percent slopes, rarely flooded	2.30	2.9%		I	88	80
66	Luton silty clay, 0 to 2 percent slopes, rarely flooded	1.74	2.2%		IIIw	57	40
Weighted Average						90.1	68.9

**IA has updated the CSR values for each county to CSR2.
 *c: Using Capabilities Class Dominant Condition Aggregation Method
 Soils data provided by USDA and NRCS.