

Total Soils Map

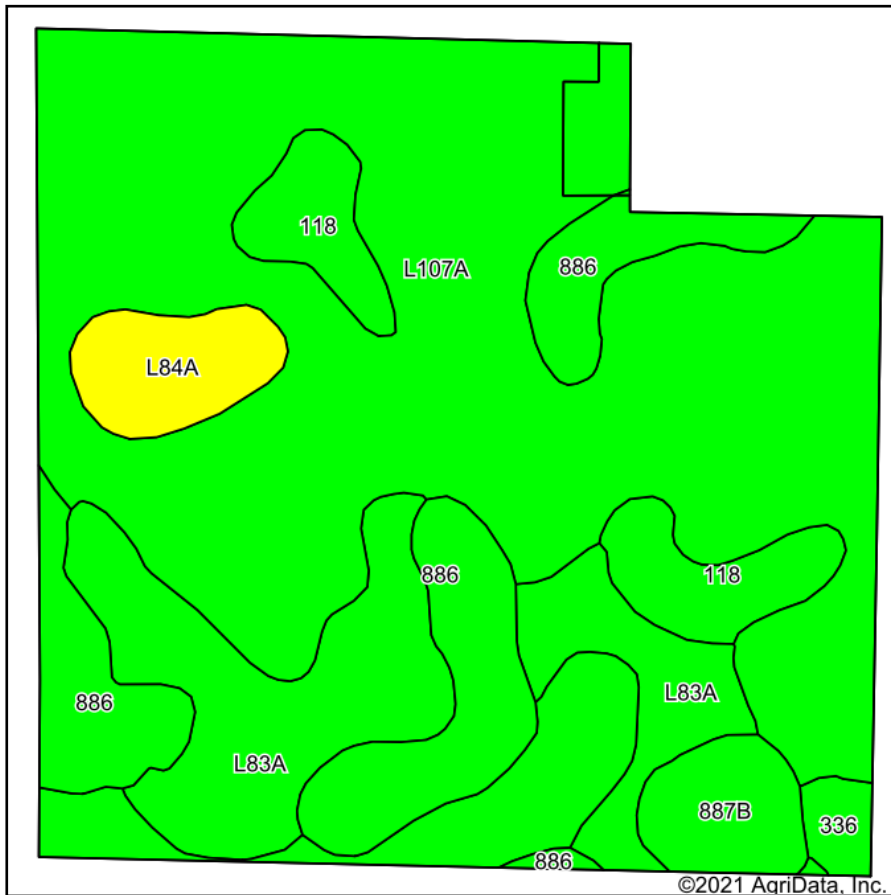

Soils data provided by USDA and NRCS.

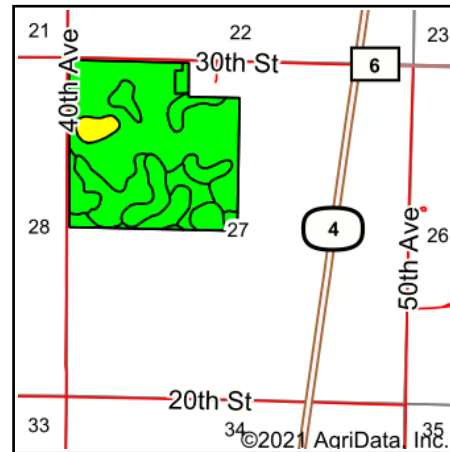

State: **Minnesota**
 County: **Martin**
 Location: **27-101N-33W**
 Township: **Lake Fremont**
 Acres: **148.92**
 Date: **9/27/2021**



Maps Provided By:



Area Symbol: MN091, Soil Area Version: 17

Code	Soil Description	Acres	Percent of field	Non-Irr Class Legend	Non-Irr Class *c	Productivity Index	*n NCCPI Overall
L107A	Canisteo-Glencoe complex, 0 to 2 percent slopes	90.34	60.7%		IIw	91	81
L83A	Webster clay loam, 0 to 2 percent slopes	21.54	14.5%		IIw	93	83
886	Nicollet-Crippin complex	18.04	12.1%		I	100	83
118	Crippin loam, 1 to 3 percent slopes	8.25	5.5%		Ie	100	87
L84A	Glencoe clay loam, 0 to 1 percent slopes	4.91	3.3%		IIIw	86	77
887B	Clarion-Swanlake complex, 2 to 6 percent slopes	4.42	3.0%		Ile	92	83
336	Delft clay loam, 0 to 2 percent slopes	1.42	1.0%		IIw	94	79
Weighted Average						92.8	*n 81.8

*n: The aggregation method is "Weighted Average using all components"

*c: Using Capabilities Class Dominant Condition Aggregation Method

Soils data provided by USDA and NRCS.