

Tillable Soils Map

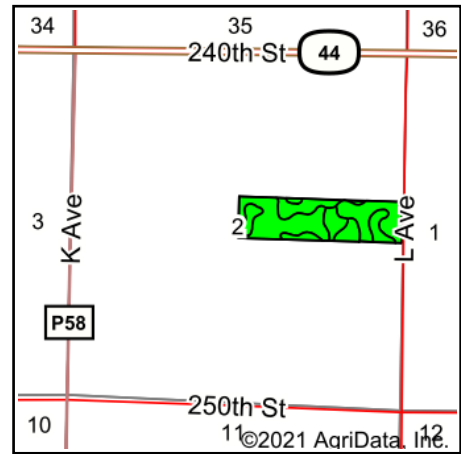

State: **Iowa**
 County: **Dallas**
 Location: **2-79N-28W**
 Township: **Colfax**
 Acres: **39.16**
 Date: **10/4/2021**

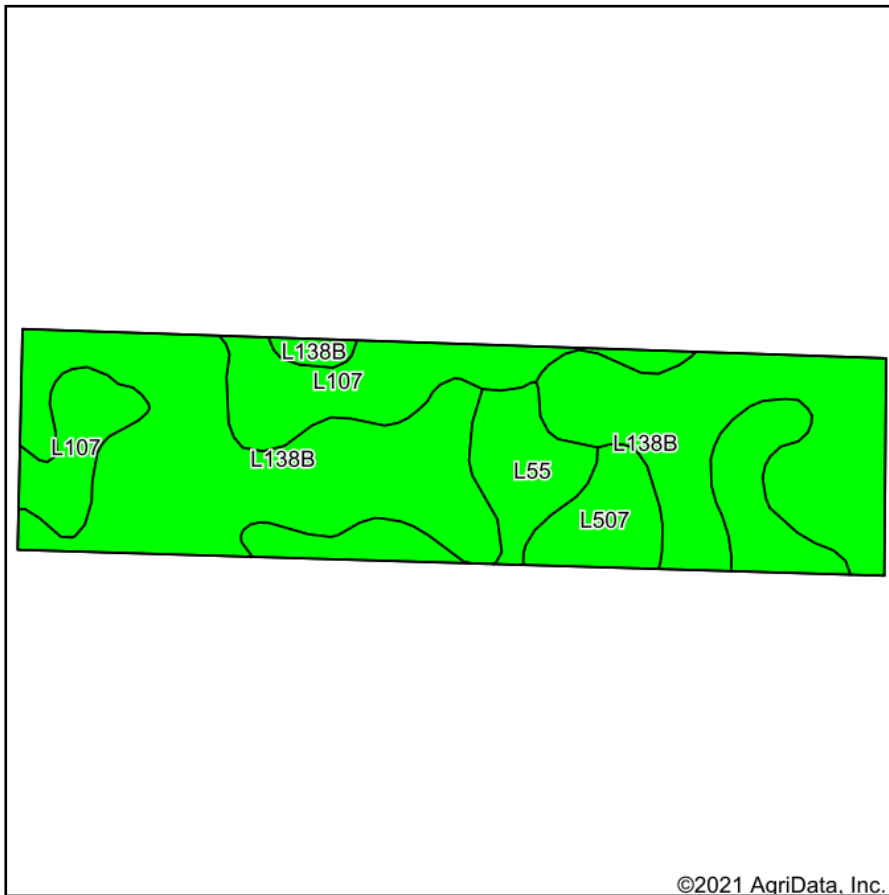

Maps Provided By:



Soils data provided by USDA and NRCS.

©2021 AgriData, Inc.

Area Symbol: IA049, Soil Area Version: 26

Code	Soil Description	Acres	Percent of field	CSR2 Legend	Non-Irr Class *c	*i Corn	*i Soybeans	CSR2**	*n NCCPI Overall
L138B	Clarion loam, Bemis moraine, 2 to 6 percent slopes	23.28	59.4%		Ile	80	23.2	88	80
L107	Webster clay loam, Bemis moraine, 0 to 2 percent slopes	6.99	17.8%		Ilw	0	0	88	84
L55	Nicollet loam, 1 to 3 percent slopes	6.54	16.7%		Ie	0	0	91	85
L507	Canisteo clay loam, Bemis moraine, 0 to 2 percent slopes	2.35	6.0%		Ilw	0	0	87	81
Weighted Average						47.6	13.8	88.4	*n 81.6

**IA has updated the CSR values for each county to CSR2.

*i Yield data provided by the ISPAID Database version 8.1.1 developed by IA State University.

*n: The aggregation method is "Weighted Average using all components"

*c: Using Capabilities Class Dominant Condition Aggregation Method

Soils data provided by USDA and NRCS.