

Tillable Soils Map

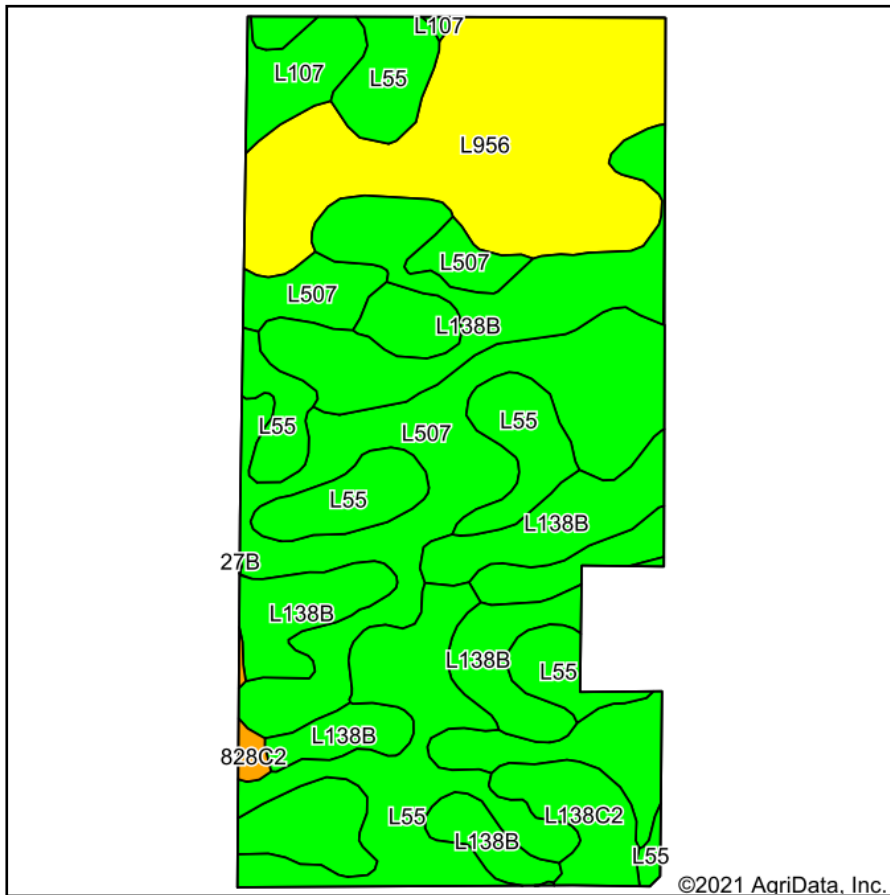

Soils data provided by USDA and NRCS.

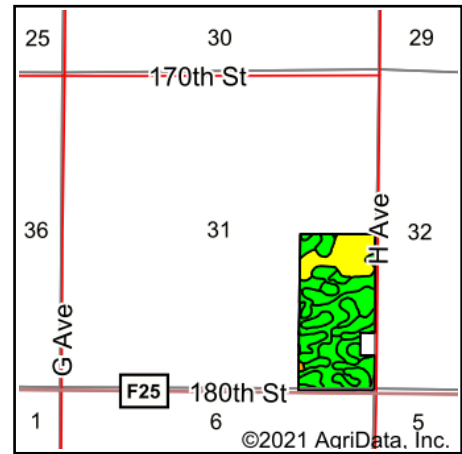

State: **Iowa**
 County: **Dallas**
 Location: **31-81N-28W**
 Township: **Spring Valley**
 Acres: **74.43**
 Date: **10/1/2021**



Maps Provided By:



© AgriData, Inc. 2021

www.AgriDataInc.com



Area Symbol: IA049, Soil Area Version: 26

Code	Soil Description	Acres	Percent of field	CSR2 Legend	Non-Irr Class *c	*i Corn	*i Soybeans	CSR2**	CSR	*n NCCPI Overall
L507	Canisteo clay loam, Bemis moraine, 0 to 2 percent slopes	20.28	27.2%		llw	0	0	87		81
L138B	Clarion loam, Bemis moraine, 2 to 6 percent slopes	17.48	23.5%		lle	80	23.2	88		80
L55	Nicollet loam, 1 to 3 percent slopes	16.41	22.0%		le	0	0	91		85
L956	Harps-Okoboji complex, Bemis moraine, 0 to 2 percent slopes	14.41	19.4%		llw	0	0	69		79
L138C2	Clarion loam, Bemis moraine, 6 to 10 percent slopes, moderately eroded	3.49	4.7%		llle	0	0	83		67
L107	Webster clay loam, Bemis moraine, 0 to 2 percent slopes	2.02	2.7%		llw	0	0	88		84
828C2	Zenor sandy loam, 5 to 9 percent slopes, moderately eroded	0.34	0.5%		llle	80	23.2	45	31	49
Weighted Average						19.2	5.6	84.3	*-	*n 80.5

**IA has updated the CSR values for each county to CSR2.

*- CSR weighted average cannot be calculated on the current soils data, use prior data version for csr values.

*i Yield data provided by the ISPAID Database version 8.1.1 developed by IA State University.

*n: The aggregation method is "Weighted Average using all components"

*c: Using Capabilities Class Dominant Condition Aggregation Method

Soils data provided by USDA and NRCS.