

Tillable Soils Map

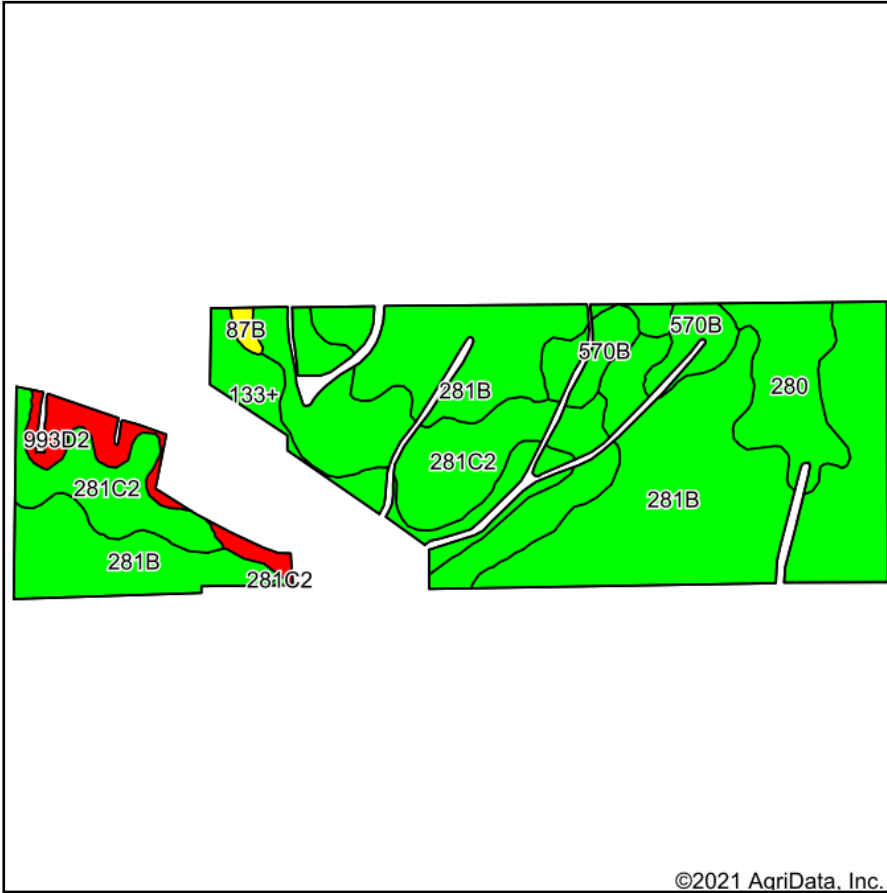

Soils data provided by USDA and NRCS.

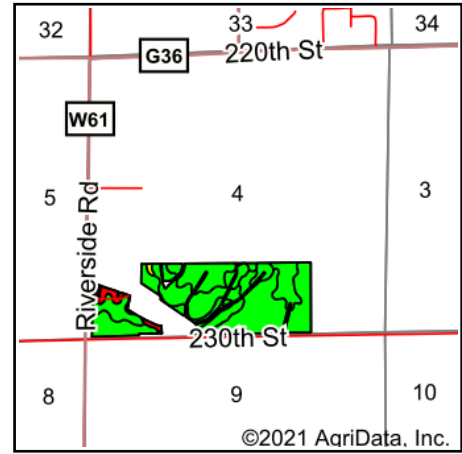

State: **Iowa**
 County: **Washington**
 Location: **4-75N-7W**
 Township: **Washington**
 Acres: **86.61**
 Date: **10/4/2021**



Maps Provided By:



© AgriData, Inc. 2021

www.AgriDataInc.com



Area Symbol: IA183, Soil Area Version: 27

Code	Soil Description	Acres	Percent of field	CSR2 Legend	Non-Irr Class *c	CSR2**	CSR
281B	Otley silty clay loam, 2 to 5 percent slopes	44.94	51.9%		Ile	91	90
281C2	Otley silty clay loam, 5 to 9 percent slopes, eroded	21.44	24.8%		IIIe	82	70
280	Mahaska silty clay loam, 0 to 2 percent slopes	6.71	7.7%		Iw	94	95
133+	Colo silt loam, 0 to 2 percent slopes, occasionally flooded, overwash	5.43	6.3%		IIw	78	85
570B	Nira silty clay loam, 2 to 5 percent slopes	4.44	5.1%		Ile	81	87
993D2	Gara-Armstrong complex, 9 to 14 percent slopes, moderately eroded	3.24	3.7%		IVe	33	20
87B	Colo-Zook silty clay loams, 0 to 3 percent slopes	0.41	0.5%		IIw	68	60
Weighted Average						85.4	82.2

**IA has updated the CSR values for each county to CSR2.

*c: Using Capabilities Class Dominant Condition Aggregation Method
 Soils data provided by USDA and NRCS.