

Total Soils Map

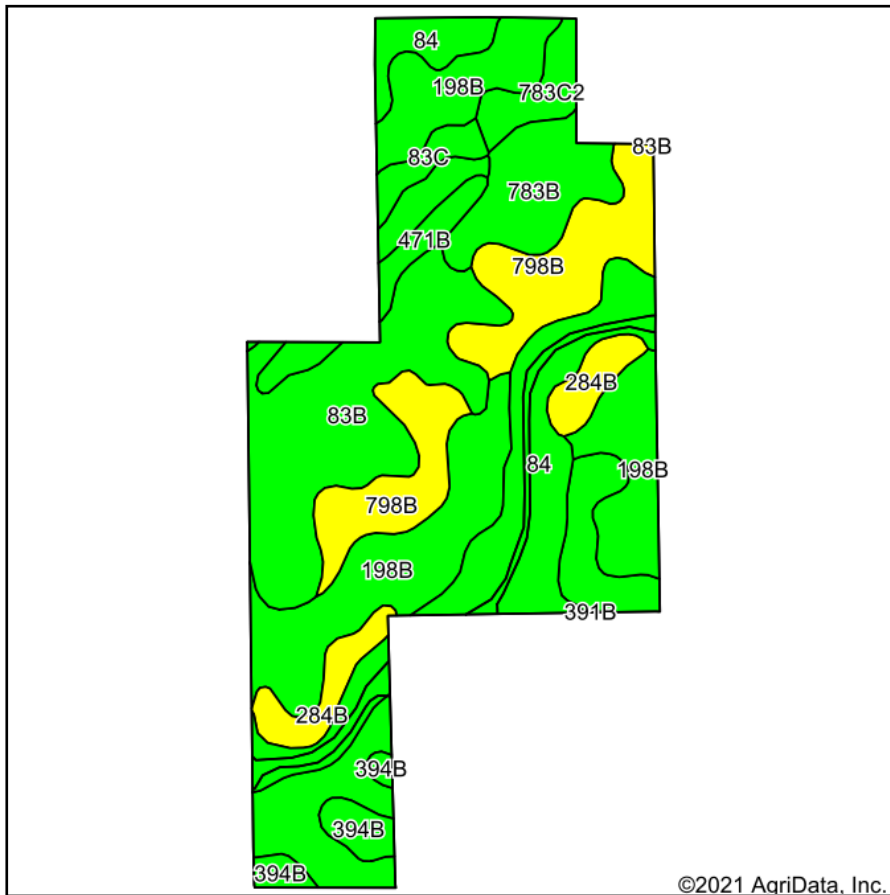

Soils data provided by USDA and NRCS.

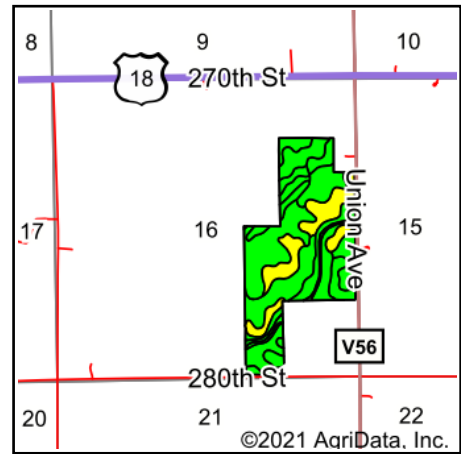

State: **Iowa**
 County: **Chickasaw**
 Location: **16-94N-11W**
 Township: **Fredericksburg**
 Acres: **122.05**
 Date: **9/7/2021**



Maps Provided By:



Area Symbol: IA037, Soil Area Version: 26

Code	Soil Description	Acres	Percent of field	CSR2 Legend	Non-Irr Class *c	CSR2**	*n NCCPI Overall
198B	Floyd loam, 1 to 4 percent slopes	33.67	27.6%		IIw	89	85
83B	Kenyon loam, 2 to 5 percent slopes	22.58	18.5%		Ile	90	90
84	Clyde clay loam, 0 to 3 percent slopes	20.13	16.5%		IIw	88	90
798B	Protivin loam, 1 to 4 percent slopes	16.64	13.6%		Ile	61	81
783B	Cresco loam, 2 to 5 percent slopes	7.87	6.4%		Ile	73	77
394B	Ostrander loam, 2 to 5 percent slopes	7.36	6.0%		Ile	88	78
284B	Flagler sandy loam, 2 to 5 percent slopes	5.55	4.5%		IIIe	49	62
471B	Oran loam, 2 to 5 percent slopes	3.11	2.5%		Iw	74	82
783C2	Cresco loam, 5 to 9 percent slopes, moderately eroded	3.07	2.5%		IIIe	78	82
83C	Kenyon loam, 5 to 9 percent slopes	2.07	1.7%		IIIe	85	89
Weighted Average						81.6	*n 84.1

**IA has updated the CSR values for each county to CSR2.

*n: The aggregation method is "Weighted Average using all components"

*c: Using Capabilities Class Dominant Condition Aggregation Method

Soils data provided by USDA and NRCS.