

# Tillable Soils Map

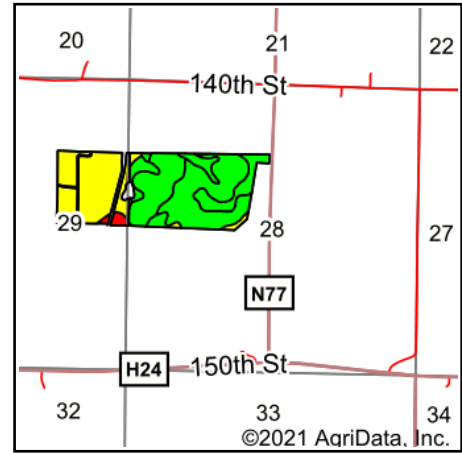

State: **Iowa**  
 County: **Adams**  
 Location: **28-73N-32W**  
 Township: **Colony**  
 Acres: **105.7**  
 Date: **10/8/2021**

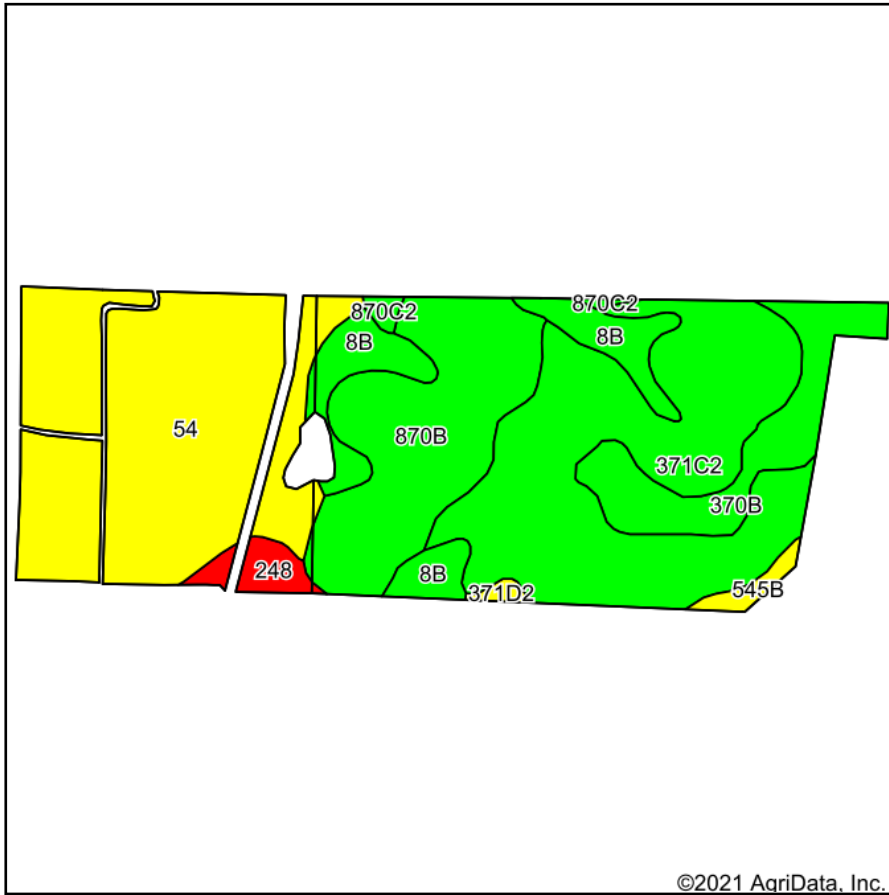

Maps Provided By:



Soils data provided by USDA and NRCS.

©2021 AgriData, Inc.

© AgriData, Inc. 2021

www.AgriDataInc.com

Area Symbol: IA003, Soil Area Version: 32

Code	Soil Description	Acres	Percent of field	CSR2 Legend	Non-Irr Class *c	*i Corn Bu	*i Soybeans Bu	CSR2**	CSR	*n NCCPI Overall	
54	Zook silty clay loam, 0 to 2 percent slopes, occasionally flooded	34.90	33.0%		IIw	190.4	55.2	67	70	63	
371C2	Sharpsburg-Nira silty clay loams, 5 to 9 percent slopes, eroded	31.92	30.2%		IIIe	168	48.7	83	64	81	
870B	Sharpsburg silty clay loam, terrace, 2 to 5 percent slopes	17.98	17.0%		Ile	80	23.2	91	87	91	
370B	Sharpsburg silty clay loam, 2 to 5 percent slopes	8.75	8.3%		Ile	225.6	65.4	91	87	93	
8B	Judson silty clay loam, dissected till plain, 2 to 5 percent slopes	8.19	7.7%		Ile	230.4	66.8	93	82	93	
248	Wabash silty clay loam, occasionally ponded, 0 to 2 percent slopes, occasionally flooded	1.95	1.8%		VIIIw	177.6	51.5	37	60	46	
545B	Zook-Ely-Gullied land complex, 2 to 5 percent slopes	0.98	0.9%		Ile	177.6	51.5	64	52	9	
870C2	Sharpsburg silty clay loam, terrace, 5 to 9 percent slopes, eroded	0.62	0.6%		IIIe	204.8	59.4	79	67	84	
371D2	Sharpsburg-Nira silty clay loams, 9 to 14 percent slopes, eroded	0.41	0.4%		IIIe	176	51	57	54	78	
<b>Weighted Average</b>						<b>2.42</b>	<b>170.5</b>	<b>49.4</b>	<b>79.4</b>	<b>73</b>	<b>*n 77.4</b>

\*\*IA has updated the CSR values for each county to CSR2.

\*i Yield data provided by the ISPAID Database version 8.1.1 developed by IA State University.

\*n: The aggregation method is "Weighted Average using all components"

\*c: Using Capabilities Class Dominant Condition Aggregation Method

Soils data provided by USDA and NRCS.