

Total Soils Map

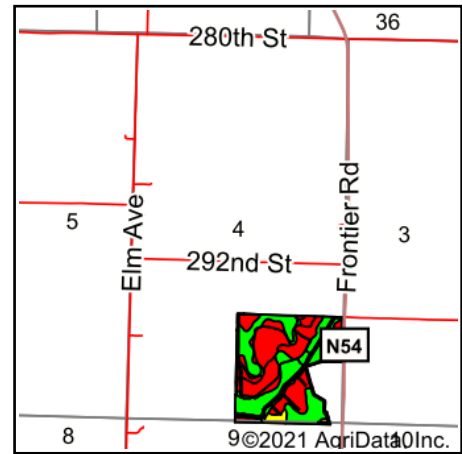

State: **Iowa**
 County: **Guthrie**
 Location: **4-78N-33W**
 Township: **Grant**
 Acres: **137.3**
 Date: **12/15/2021**

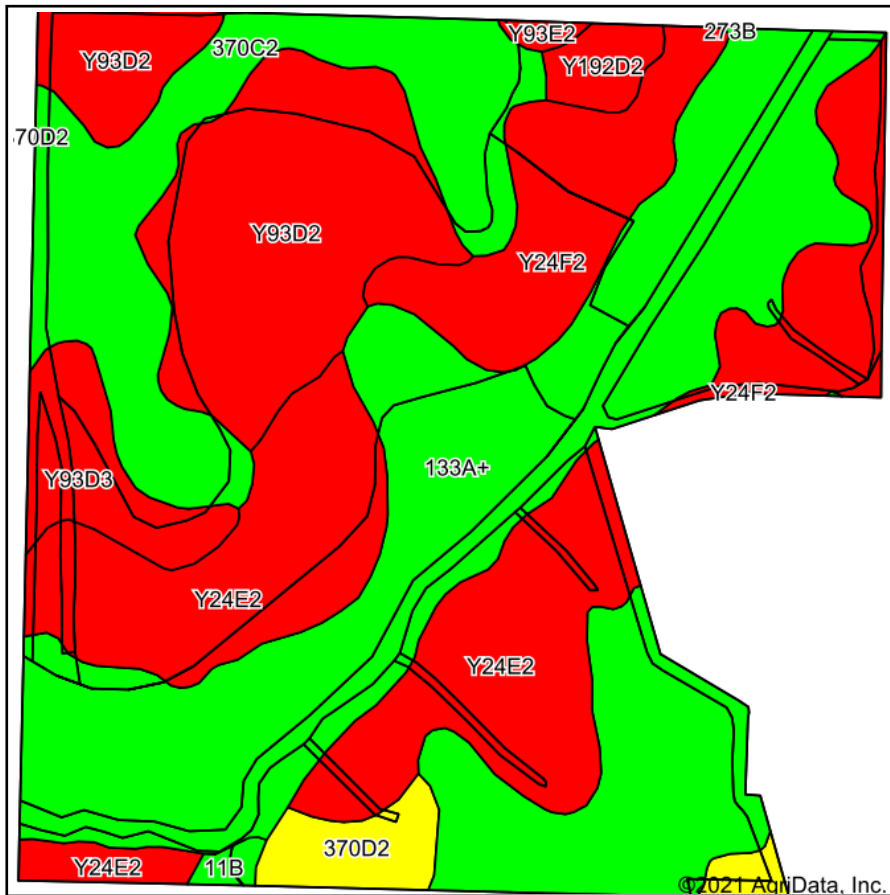

Maps Provided By:



Soils data provided by USDA and NRCS.

Area Symbol: IA077, Soil Area Version: 30

Code	Soil Description	Acres	Percent of field	CSR2 Legend	Non-Irr Class *c	*i Corn Bu	*i Soybeans Bu	CSR2**	CSR	*n NCCPI Overall	
133A+	Colo silt loam, deep loess, 0 to 2 percent slopes, overwash, occasionally flooded	36.72	26.7%		Ilw	204.8	59.4	78	85	85	
Y24E2	Shelby clay loam, dissected till plain, 14 to 18 percent slopes, eroded	31.49	22.9%		IVe	0	0	35		70	
370C2	Sharpsburg silty clay loam, 5 to 9 percent slopes, eroded	28.85	21.0%		IIIe	204.8	59.4	80	67	84	
Y93D2	Shelby-Adair clay loams, dissected till plain, 9 to 14 percent slopes, eroded	19.93	14.5%		IIIe	0	0	35		69	
Y24F2	Shelby clay loam, dissected till plain, 18 to 25 percent slopes, eroded	9.40	6.8%		VIe	0	0	20		55	
Y93D3	Shelby-Adair clay loams, dissected till plain, 9 to 14 percent slopes, severely eroded	4.65	3.4%		IVe	0	0	28		61	
370D2	Sharpsburg silty clay loam, 9 to 14 percent slopes, eroded	3.65	2.7%		IIIe	177.6	51.5	54	57	80	
Y192D2	Adair clay loam, dissected till plain, 9 to 14 percent slopes, eroded	1.70	1.2%		IVe	0	0	16		64	
11B	Colo-Judson silty clay loams, 0 to 5 percent slopes, occasionally flooded	0.51	0.4%		Ilw	216	62.6	80	68	87	
Y93E2	Shelby-Adair clay loams, dissected till plain, 14 to 18 percent slopes, eroded	0.40	0.3%		IVe	0	0	28		62	
Weighted Average						3.21	103.3	30	55.1	*-	*n 75.7

**IA has updated the CSR values for each county to CSR2.

*- CSR weighted average cannot be calculated on the current soils data, use prior data version for csr values.

*i Yield data provided by the ISPAID Database version 8.1.1 developed by IA State University.

*n: The aggregation method is "Weighted Average using all components"

*c: Using Capabilities Class Dominant Condition Aggregation Method

Soils data provided by USDA and NRCS.