

FSA Tillable Soils Map

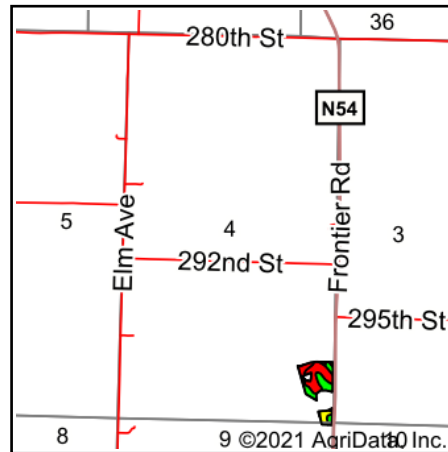

State: **Iowa**
 County: **Guthrie**
 Location: **4-78N-33W**
 Township: **Grant**
 Acres: **15.07**
 Date: **12/15/2021**

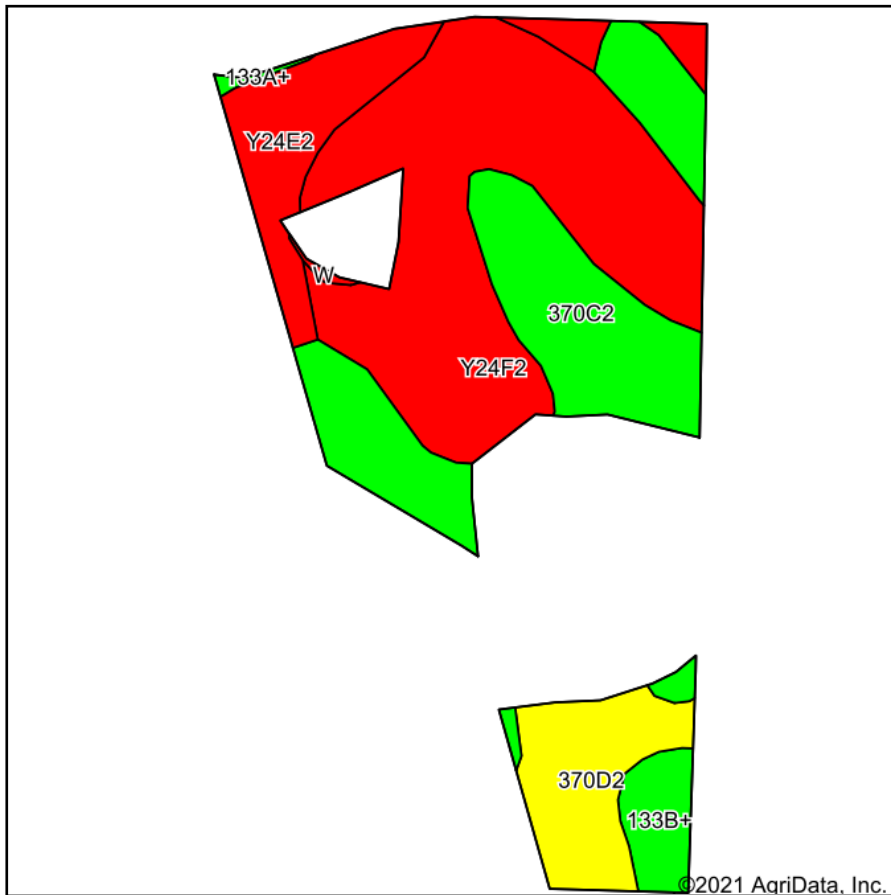

Area Symbol: IA077, Soil Area Version: 30

Code	Soil Description	Acres	Percent of field	CSR2 Legend	Non-Irr Class *c	*i Corn Bu	*i Soybeans Bu	CSR2**	CSR	*n NCCPI Overall
Y24F2	Shelby clay loam, dissected till plain, 18 to 25 percent slopes, eroded	6.61	43.9%	Red	Vle	0	0	20		55
370C2	Sharpsburg silty clay loam, 5 to 9 percent slopes, eroded	4.32	28.7%	Green	IIIe	204.8	59.4	80	67	84
Y24E2	Shelby clay loam, dissected till plain, 14 to 18 percent slopes, eroded	1.90	12.6%	Red	IVe	0	0	35		70
370D2	Sharpsburg silty clay loam, 9 to 14 percent slopes, eroded	1.61	10.7%	Yellow	IIIe	177.6	51.5	54	57	80
133B+	Colo silt loam, dissected till plain, 2 to 5 percent slopes, overwash, occasionally flooded	0.63	4.2%	Green	IIw	196.8	57.1	73	81	83
Weighted Average						4.40	85.9	24.9	44.9	*n 69

**IA has updated the CSR values for each county to CSR2.

*- CSR weighted average cannot be calculated on the current soils data, use prior data version for csr values.

*i Yield data provided by the ISPAID Database version 8.1.1 developed by IA State University.

*n: The aggregation method is "Weighted Average using all components"

*c: Using Capabilities Class Dominant Condition Aggregation Method

Soils data provided by USDA and NRCS.