

Tract 1 Tillable Soils Map

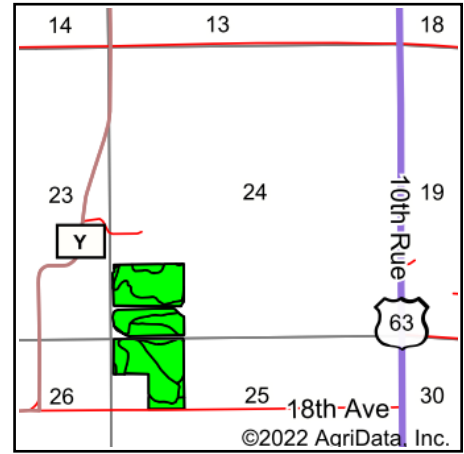

State: **Wisconsin**
 County: **St Croix**
 Location: **24-28N-17W**
 Township: **Rush River**
 Acres: **63.65**
 Date: **1/17/2022**

PC PEOPLES
 COMPANY
 INNOVATIVE. REAL ESTATE. SOLUTIONS.

Maps Provided By:

surety
 CUSTOMIZED ONLINE MAPPING
 © AgriData, Inc. 2021 www.AgriDataInc.com



Area Symbol: WI109, Soil Area Version: 17

Code	Soil Description	Acres	Percent of field	Non-Irr Class Legend	Non-Irr Class *c	Corn Bu	Soybeans Bu	*n NCCPI Overall
JsB	Jewett silt loam, sandy substratum, 2 to 6 percent slopes	22.29	35.0%		Ile	95	31	66
FdA	Floyd silt loam, 0 to 3 percent slopes	12.55	19.7%		Ilw	125	41	86
VaB	Vlasaty silt loam, 2 to 6 percent slopes	10.95	17.2%		Ile	130	43	82
LcA	Lawler silt loam, 0 to 3 percent slopes	10.87	17.1%		Ils	110	36	55
JsA	Jewett silt loam, sandy substratum, 0 to 2 percent slopes	4.39	6.9%		Ils	95	31	66
AoB	Antigo silt loam, 2 to 6 percent slopes	1.67	2.6%		Ile			57
HaA	Halder silt loam, 0 to 3 percent slopes	0.78	1.2%		Ilw	85	28	67
EmE	Emmert loamy sand, 12 to 35 percent slopes	0.09	0.1%		Vlls			9
SrA	Skyberg silt loam, 0 to 3 percent slopes	0.06	0.1%		Ilw	115	38	73
Weighted Average					2.01	106.8	35	*n 70.5

*n: The aggregation method is "Weighted Average using all components"

*c: Using Capabilities Class Dominant Condition Aggregation Method

Soils data provided by USDA and NRCS.