

Tract 2 Current Tillable Soils Map

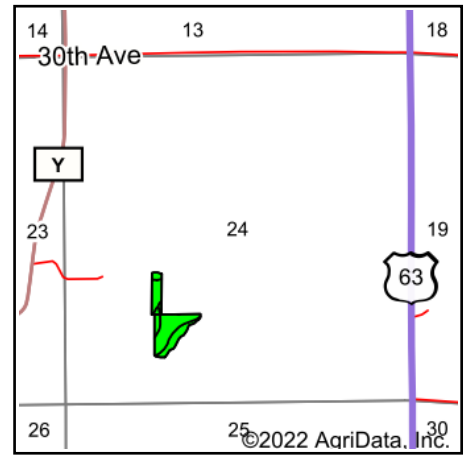

State: **Wisconsin**
 County: **St Croix**
 Location: **24-28N-17W**
 Township: **Rush River**
 Acres: **8.64**
 Date: **1/17/2022**

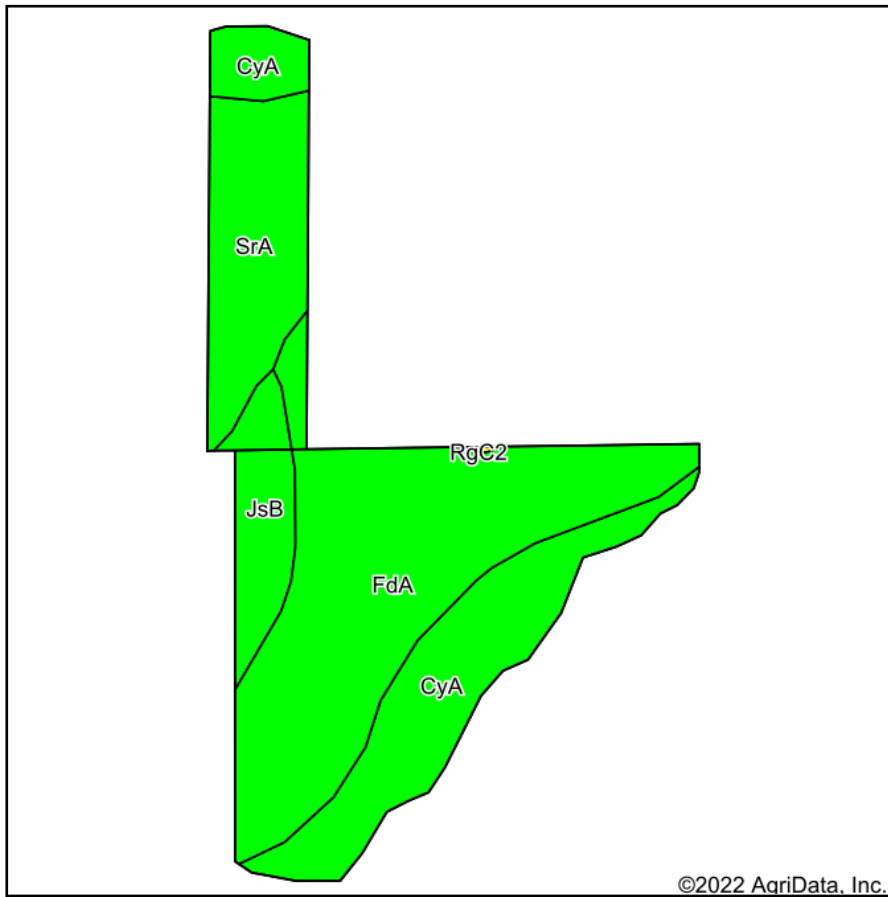

Maps Provided By:



Area Symbol: WI109, Soil Area Version: 17

Code	Soil Description	Acres	Percent of field	Non-Irr Class Legend	Non-Irr Class *c	Corn Bu	Soybeans Bu	*n NCCPI Overall
FdA	Floyd silt loam, 0 to 3 percent slopes	4.17	48.3%		Ilw	125	41	86
CyA	Clyde silt loam, 0 to 3 percent slopes	2.22	25.7%		Ilw	125	41	77
SrA	Skyberg silt loam, 0 to 3 percent slopes	1.50	17.4%		Ilw	115	38	73
JsB	Jewett silt loam, sandy substratum, 2 to 6 percent slopes	0.75	8.7%		Ile	95	31	66
Weighted Average					2.00	120.7	39.6	*n 79.7

*n: The aggregation method is "Weighted Average using all components"

*c: Using Capabilities Class Dominant Condition Aggregation Method

Soils data provided by USDA and NRCS.