

Tillable Soils Map

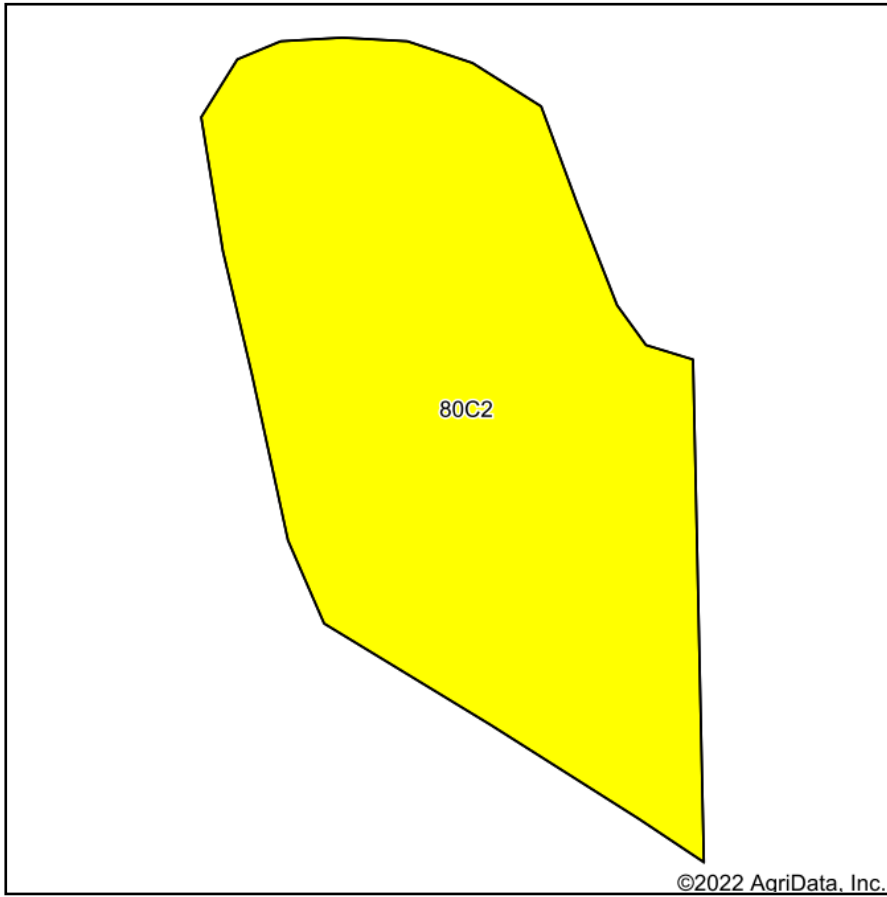

Soils data provided by USDA and NRCS.

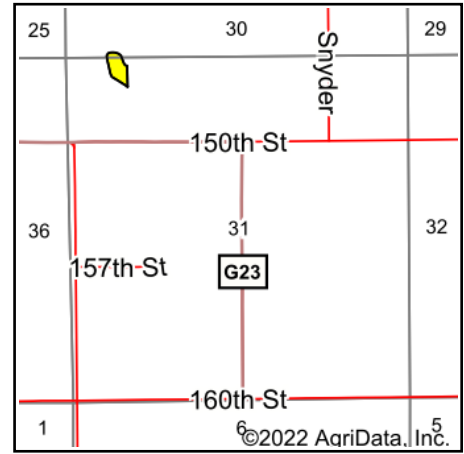

State: **Iowa**
 County: **Mahaska**
 Location: **31-77N-14W**
 Township: **Pleasant Grove**
 Acres: **2.47**
 Date: **1/17/2022**



Maps Provided By:



Area Symbol: IA123, Soil Area Version: 27						
Code	Soil Description	Acres	Percent of field	CSR2 Legend	CSR2**	CSR
80C2	Clinton silt loam, 5 to 9 percent slopes, eroded	2.47	100.0%		69	63
Weighted Average					69	63

**IA has updated the CSR values for each county to CSR2.
 Soils data provided by USDA and NRCS.