

# FSA Tillable Soils Map

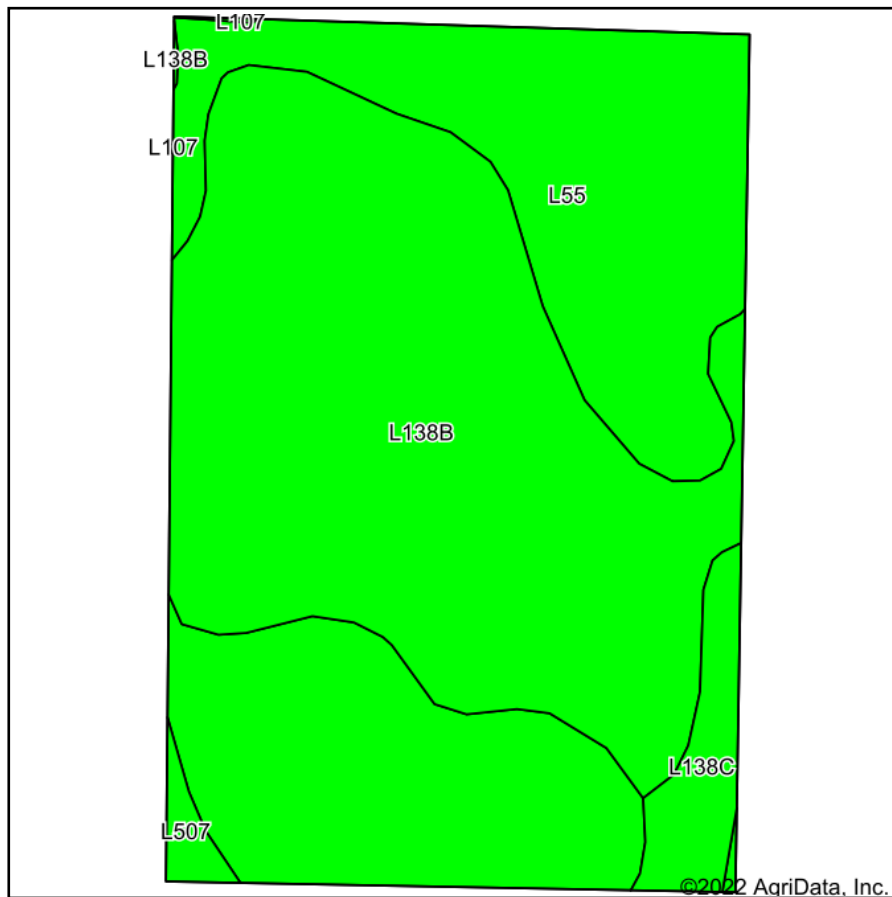

Soils data provided by USDA and NRCS.

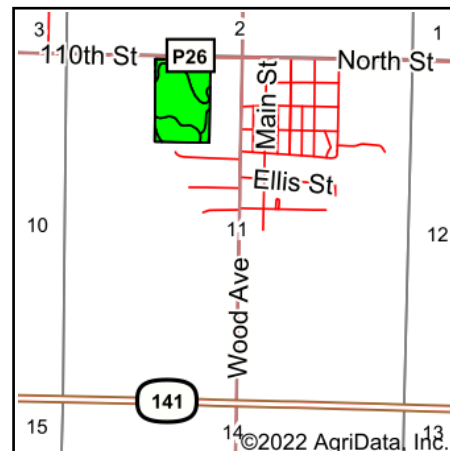

State: **Iowa**  
 County: **Guthrie**  
 Location: **11-81N-30W**  
 Township: **Richland**  
 Acres: **24.25**  
 Date: **2/15/2022**



Maps Provided By:



Area Symbol: IA077, Soil Area Version: 30

Code	Soil Description	Acres	Percent of field	CSR2 Legend	Non-Irr Class *c	*i Corn Bu	*i Soybeans Bu	CSR2**	CSR	*n NCCPI Overall
L138B	Clarion loam, Bemis moraine, 2 to 6 percent slopes	12.56	51.8%		Ile	220.8	64	88		80
L55	Nicollet loam, 1 to 3 percent slopes	10.51	43.3%		Ie	0	0	91		85
L138C	Clarion loam, Bemis moraine, 6 to 10 percent slopes	0.94	3.9%		IIle	0	0	84		77
L507	Canisteo clay loam, Bemis moraine, 0 to 2 percent slopes	0.24	1.0%		IIw	0	0	87		81
Weighted Average					1.61	114.4	33.1	89.1	*-	*n 82.1

\*\*IA has updated the CSR values for each county to CSR2.

\*- CSR weighted average cannot be calculated on the current soils data, use prior data version for csr values.

\*i Yield data provided by the ISPAID Database version 8.1.1 developed by IA State University.

\*n: The aggregation method is "Weighted Average using all components"

\*c: Using Capabilities Class Dominant Condition Aggregation Method

Soils data provided by USDA and NRCS.