

Est. Total Soils Map

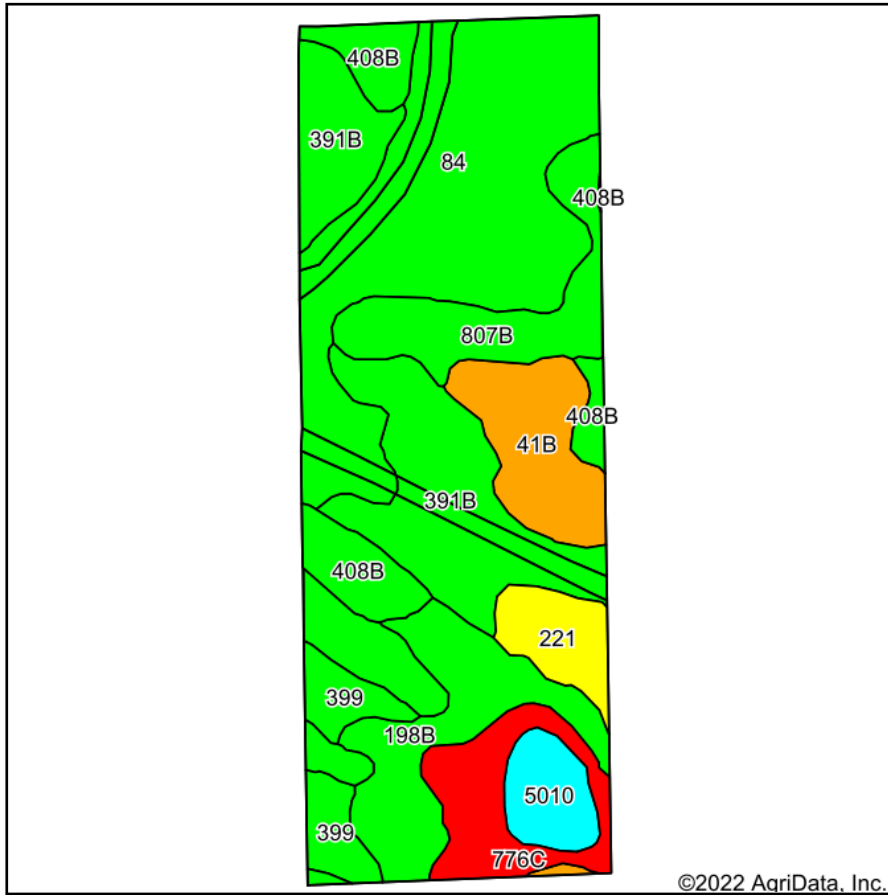

Soils data provided by USDA and NRCS.

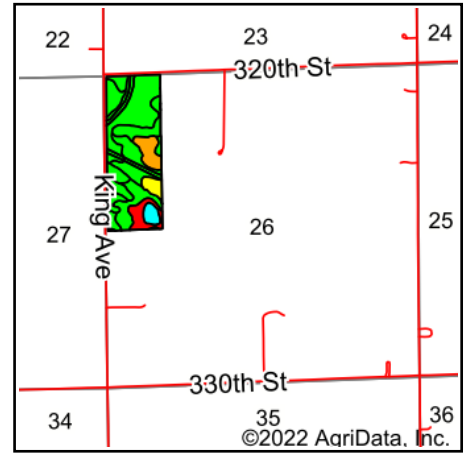

State: **Iowa**
 County: **Buchanan**
 Location: **26-87N-9W**
 Township: **Homer**
 Acres: **54.65**
 Date: **3/15/2022**

PC PEOPLES
 COMPANY
 INNOVATIVE. REAL ESTATE. SOLUTIONS.

Maps Provided By:

surety
 CUSTOMIZED ONLINE MAPPING
 © AgriData, Inc. 2021 www.AgriDataInc.com



Area Symbol: IA019, Soil Area Version: 27

Code	Soil Description	Acres	Percent of field	CSR2 Legend	Non-Irr Class *c	CSR2**
84	Clyde clay loam, 0 to 3 percent slopes	17.69	32.4%		IIw	88
391B	Clyde-Floyd complex, 1 to 4 percent slopes	9.88	18.1%		IIw	87
198B	Floyd loam, 1 to 4 percent slopes	5.52	10.1%		IIw	89
807B	Schley variant sandy loam, 1 to 4 percent slopes	4.31	7.9%		IIw	66
41B	Sparta loamy fine sand, 2 to 5 percent slopes	4.01	7.3%		IVs	39
408B	Olin fine sandy loam, 2 to 5 percent slopes	3.51	6.4%		IIe	74
776C	Lilah sandy loam, 2 to 9 percent slopes	3.41	6.2%		IVs	5
399	Readlyn silt loam, 1 to 3 percent slopes	2.29	4.2%		Iw	91
221	Klossner muck, 1 to 4 percent slopes	2.02	3.7%		IIIw	48
5010	Pits, sand and gravel	1.91	3.5%			0
241B	Burkhardt-Saude complex, 2 to 5 percent slopes	0.10	0.2%		IVe	33
Weighted Average					2.20	72

**IA has updated the CSR values for each county to CSR2.

*c: Using Capabilities Class Dominant Condition Aggregation Method
 Soils data provided by USDA and NRCS.