

Soils Map

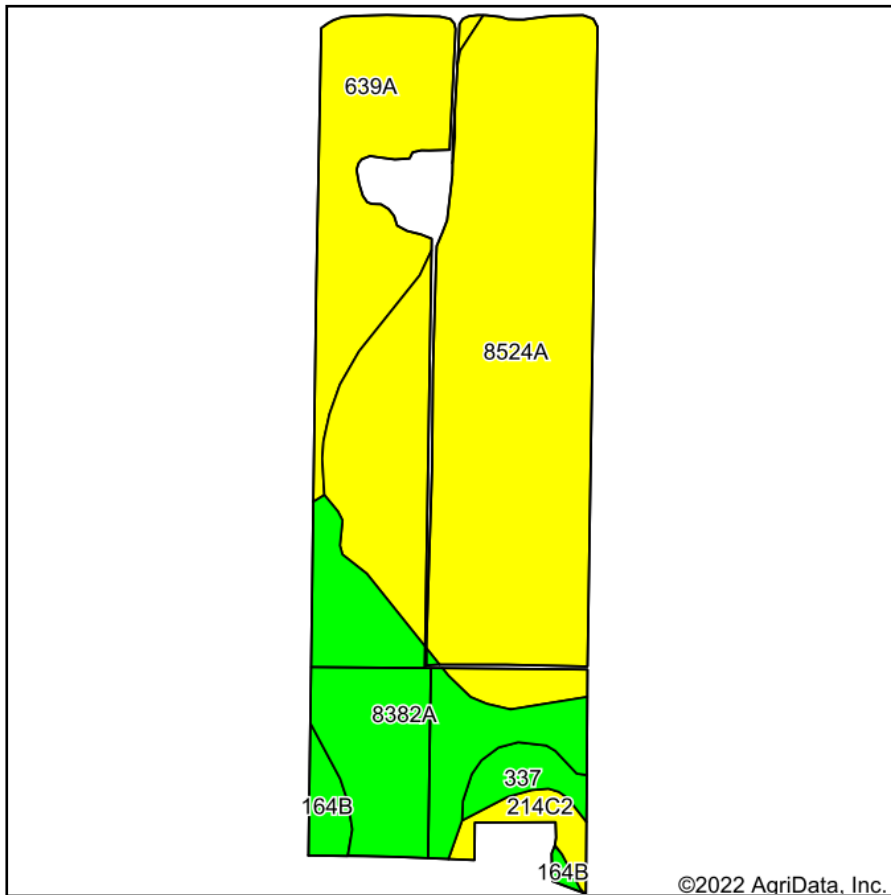

Soils data provided by USDA and NRCS.

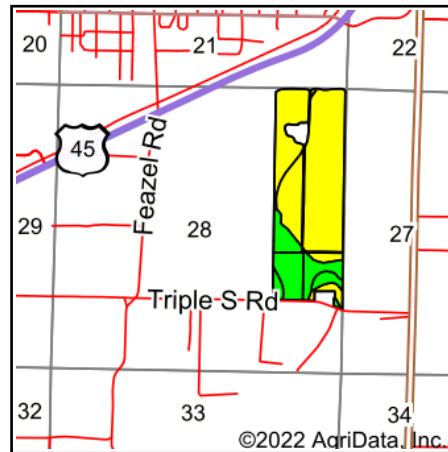

State: **Illinois**
 County: **Saline**
 Location: **28-9S-6E**
 Township: **Harrisburg**
 Acres: **113.51**
 Date: **3/24/2022**



Area Symbol: IL165, Soil Area Version: 16

Code	Soil Description	Acres	Percent of field	II. State Productivity Index Legend	Crop productivity index for optimum management
8524A	Zipp silty clay loam, 0 to 2 percent slopes, occasionally flooded	66.03	58.2%	Yellow	103
8382A	Belknap silt loam, 0 to 2 percent slopes, occasionally flooded	21.51	18.9%	Green	117
639A	Wynoose silt loam, bench, 0 to 2 percent slopes	18.34	16.2%	Yellow	95
337	Creal silt loam	2.81	2.5%	Green	110
**214C2	Hosmer silt loam, 5 to 10 percent slopes, eroded	2.51	2.2%	Yellow	**95
**164B	Stoy silt loam, 2 to 5 percent slopes	2.31	2.0%	Green	**108
Weighted Average					104.5

Table: Optimum Crop Productivity Ratings for Illinois Soil by K.R. Olson and J.M. Lang, Office of Research, ACES, University of Illinois at Champaign-Urbana. Version: 1/2/2012 Amended Table S2 B811

Crop yields and productivity indices for optimum management (B811) are maintained at the following NRES web site: <http://soilproductivity.nres.illinois.edu/>

** Indexes adjusted for slope and erosion according to Bulletin 811 Table S3

Soils data provided by USDA and NRCS. Soils data provided by University of Illinois at Champaign-Urbana.