

Total Soils Map Tract 2

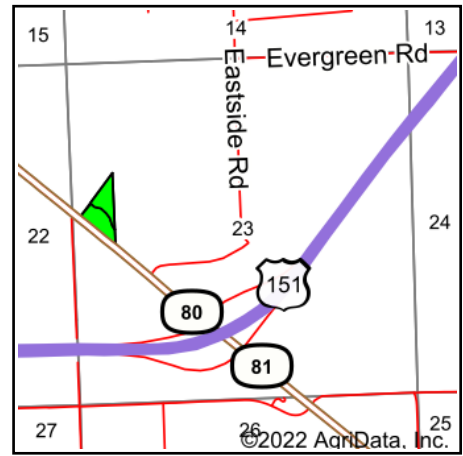

State: **Wisconsin**
 County: **Grant**
 Location: **23-3N-1W**
 Township: **Platteville**
 Acres: **6.8**
 Date: **3/29/2022**

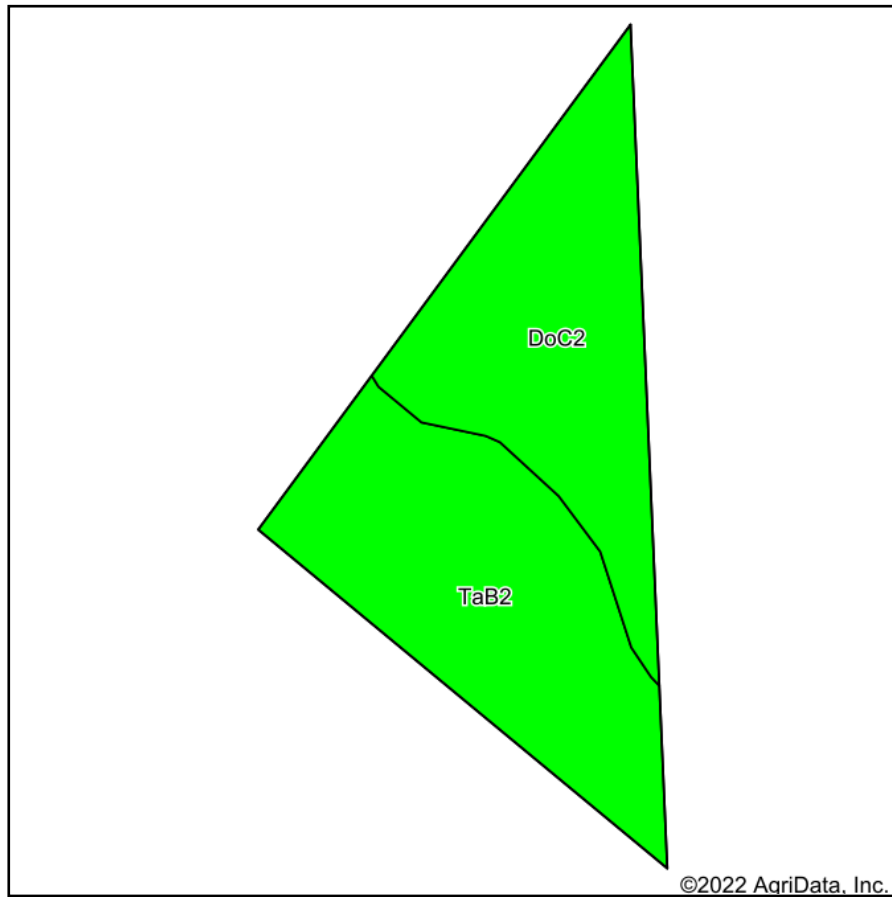

Maps Provided By:



Area Symbol: WI043, Soil Area Version: 16

Code	Soil Description	Acres	Percent of field	NCCPI Overall Legend	Non-Irr Class *c	*n NCCPI Overall
TaB2	Tama silt loam, driftless, 2 to 6 percent slopes, moderately eroded	3.59	52.8%		Ile	90
DoC2	Downs silt loam, 6 to 12 percent slopes, moderately eroded	3.21	47.2%		IIle	86
Weighted Average					2.47	*n 88.1

*n: The aggregation method is "Weighted Average using all components"

*c: Using Capabilities Class Dominant Condition Aggregation Method

Soils data provided by USDA and NRCS.