

Soils Map

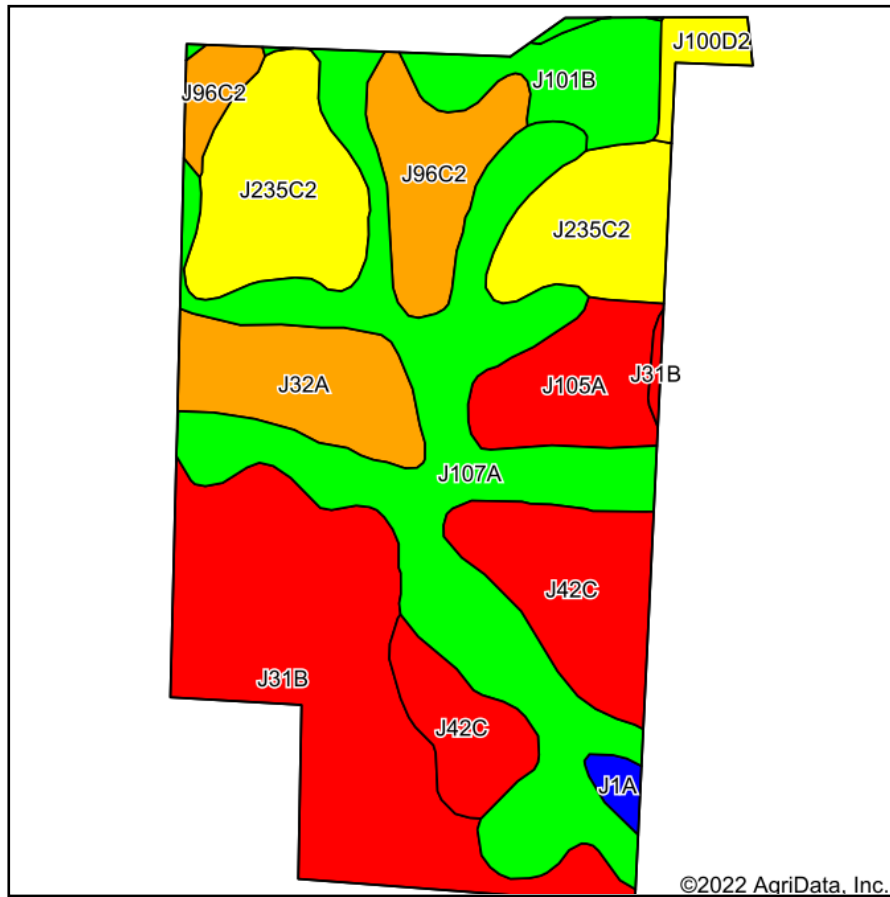

Soils data provided by USDA and NRCS.

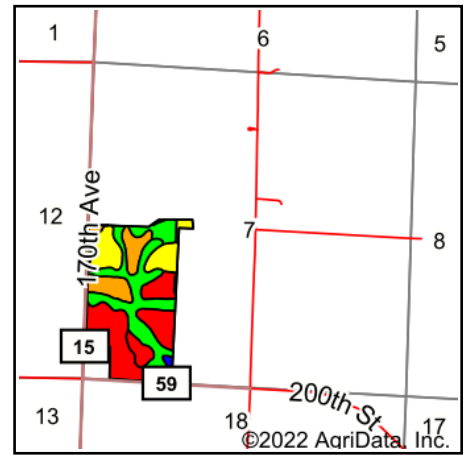

State: **Minnesota**
 County: **Lyon**
 Location: **7-110N-42W**
 Township: **Lyons**
 Acres: **85.19**
 Date: **6/28/2022**

PC PEOPLES
 COMPANY
 INNOVATIVE. REAL ESTATE. SOLUTIONS.

Maps Provided By:

surety
 CUSTOMIZED ONLINE MAPPING
 © AgriData, Inc. 2021 www.AgriDataInc.com



Area Symbol: MN083, Soil Area Version: 18

Code	Soil Description	Acres	Percent of field	PI Legend	Non-Irr Class *c	Irr Class *c	Range Production (lbs/acre/yr)	Productivity Index	Brome grass alfalfa hay Tons	Corn Bu	Oats Bu	Soybeans Bu	Spring wheat Bu	*n NCCPI Overall	*n NCCPI Corn	*n NCCPI Soy
J107A	Lakepark-Roliss-Parnell, depressional, complex, 0 to 3 percent slopes	23.30	27.4%		IIw		0	93	4.1	162	80	51	55	71	62	
J31B	Arvilla-Sandberg complex, 2 to 6 percent slopes	17.82	20.9%		IVs		0	39	1.9	68		21		31	31	
J235C2	Buse-Barnes-Arvilla complex, 6 to 12 percent slopes, moderately eroded	12.01	14.1%		IIIe		0	64	3.3	111	63	35	44	49	46	
J42C	Sandberg-Arvilla complex, 6 to 12 percent slopes	9.54	11.2%		Vis		0	38						32	31	
J96C2	Barnes-Buse complex, 6 to 12 percent slopes, moderately eroded	6.13	7.2%		IIIe		0	80	4	139	72	44	49	59	54	
J32A	Bigstone silty clay loam, depressional, 0 to 1 percent slopes	5.62	6.6%		IIIw		0	77	3.4	134	72	42	50	75	59	
J105A	Arvilla sandy loam, Till Prairie, 0 to 2 percent slopes	4.72	5.5%		IIIIs	IIIIs	2576	44						31	31	

J101B	Hokans-Svea complex, 1 to 4 percent slopes	4.27	5.0%		Ile		0	98	4.8	171	83	54	58	69	60
J100D2	Buse, eroded-Wilno complex, 12 to 18 percent slopes	1.17	1.4%		IVe		0	64	3	111	50	35	34	51	50
J1A	Parnell silty clay loam, depressional, 0 to 1 percent slopes	0.61	0.7%		IIIw		0	86	3.4	150	73	47	50	60	58
Weighted Average					3.24	*-	142.7	66.6	2.8	104.2	46.1	32.7	31.8	*n 51.9	*n 47

*n: The aggregation method is "Weighted Average using all components"

*c: Using Capabilities Class Dominant Condition Aggregation Method

*- Irr Class weighted average cannot be calculated on the current soils data due to missing data.

Soils data provided by USDA and NRCS.