

# Soils Map

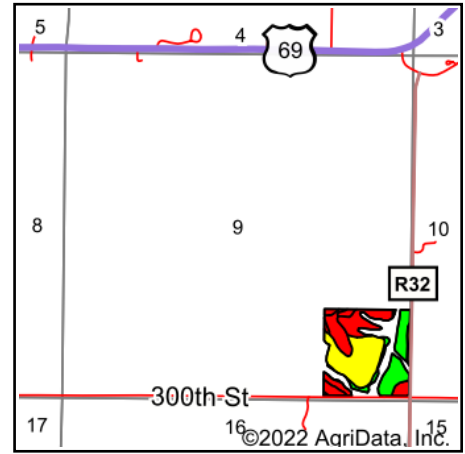

State: **Iowa**  
 County: **Decatur**  
 Location: **9-67N-26W**  
 Township: **New Buda**  
 Acres: **30.78**  
 Date: **5/25/2022**

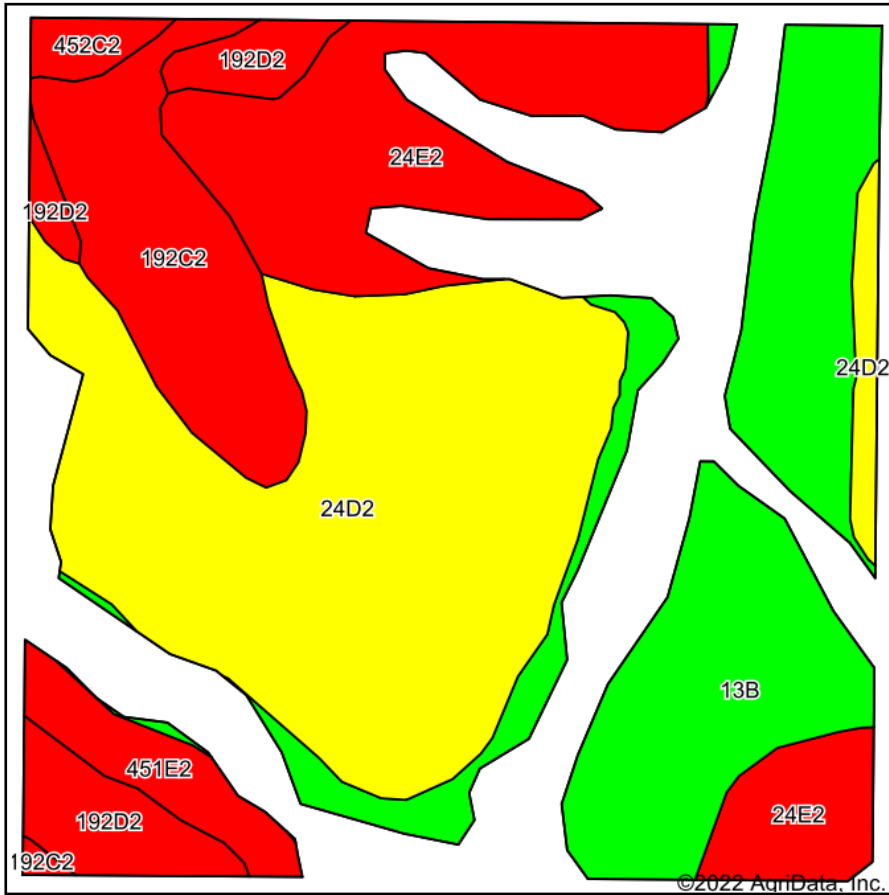

Maps Provided By:  
  
 CUSTOMIZED ONLINE MAPPING  
 © AgriData, Inc. 2021 www.AgriDataInc.com



Soils data provided by USDA and NRCS.

Area Symbol: IA053, Soil Area Version: 27

Code	Soil Description	Acres	Percent of field	CSR2 Legend	Non-Irr Class *c	CSR2**	CSR	*n NCCPI Overall	*n NCCPI Corn	*n NCCPI Small Grains	*n NCCPI Soybeans	
24D2	Shelby clay loam, 9 to 14 percent slopes, moderately eroded	11.18	36.3%		IIIe	51	48	71	71	57	55	
13B	Olmitz-Zook-Vesser complex, 0 to 5 percent slopes	7.79	25.3%		IIw	76	55	80	77	55	74	
24E2	Shelby clay loam, 14 to 18 percent slopes, moderately eroded	5.52	17.9%		IVe	40	38	68	68	53	51	
192C2	Adair clay loam, heavy till, 5 to 9 percent slopes, moderately eroded	3.24	10.5%		IIIe	29	30	68	68	56	47	
192D2	Adair clay loam, heavy till, 9 to 14 percent slopes, moderately eroded	1.67	5.4%		IVe	9	15	66	66	54	45	
451E2	Caleb loam, 14 to 18 percent slopes, moderately eroded	1.03	3.3%		VIe	31	23	74	74	54	54	
452C2	Lineville silt loam, 5 to 9 percent slopes, moderately eroded	0.35	1.1%		IIIe	46	31	70	70	54	49	
<b>Weighted Average</b>						<b>3.08</b>	<b>50</b>	<b>43.3</b>	<b>*n 72.2</b>	<b>*n 71.5</b>	<b>*n 55.4</b>	<b>*n 57.6</b>

\*\*IA has updated the CSR values for each county to CSR2.

\*n: The aggregation method is "Weighted Average using all components"

\*c: Using Capabilities Class Dominant Condition Aggregation Method

Soils data provided by USDA and NRCS.