

# Soils Map

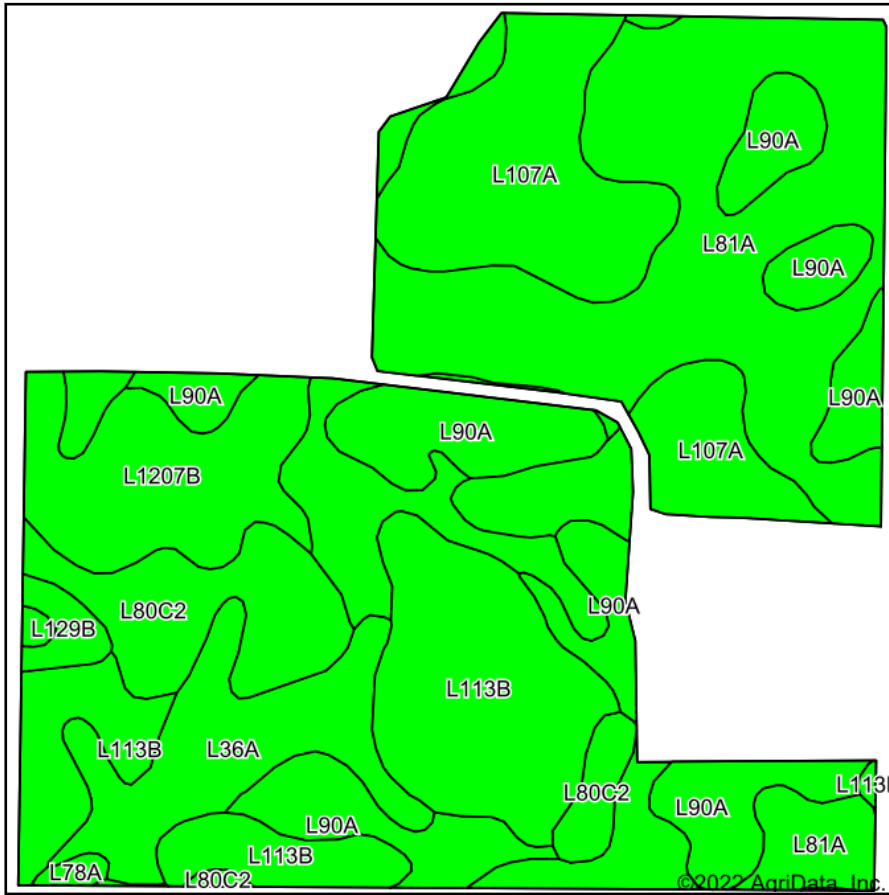

Soils data provided by USDA and NRCS.

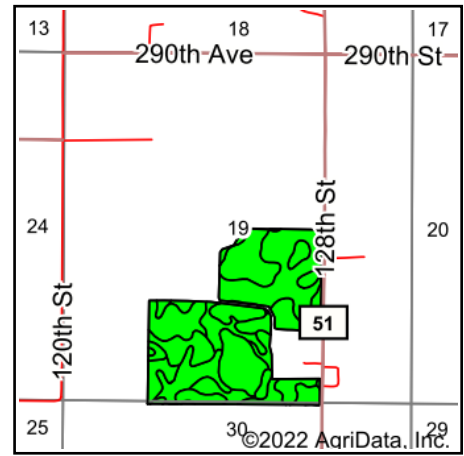

State: **Minnesota**  
 County: **Waseca**  
 Location: **19-106N-22W**  
 Township: **Otisco**  
 Acres: **117.05**  
 Date: **6/23/2022**

**PC PEOPLES**  
 COMPANY  
 INNOVATIVE. REAL ESTATE. SOLUTIONS.

Maps Provided By:

**surety**  
 CUSTOMIZED ONLINE MAPPING  
 © AgriData, Inc. 2021 www.AgriDataInc.com



Area Symbol: MN161, Soil Area Version: 16

Code	Soil Description	Acres	Percent of field	PI Legend	Productivity Index
L81A	Cordova clay loam, 0 to 2 percent slopes	35.79	30.6%		87
L90A	Le Sueur loam, 1 to 3 percent slopes	18.95	16.2%		97
L113B	Reedslake-Le Sueur complex, 1 to 6 percent slopes	17.83	15.2%		98
L107A	Canisteo-Glencoe complex, 0 to 2 percent slopes	17.37	14.8%		91
L1207B	Le Sueur-Reedslake-Cordova complex, 0 to 5 percent slopes	8.80	7.5%		95
L36A	Hamel, overwash-Hamel complex, 0 to 3 percent slopes	8.57	7.3%		97
L80C2	Lester loam, 6 to 10 percent slopes, moderately eroded	8.28	7.1%		76
L129B	Terril loam, 2 to 6 percent slopes	1.09	0.9%		99
L78A	Canisteo clay loam, 0 to 2 percent slopes	0.37	0.3%		93
Weighted Average					91.6

Soils data provided by USDA and NRCS.