

# Soils Map- Tillable acres

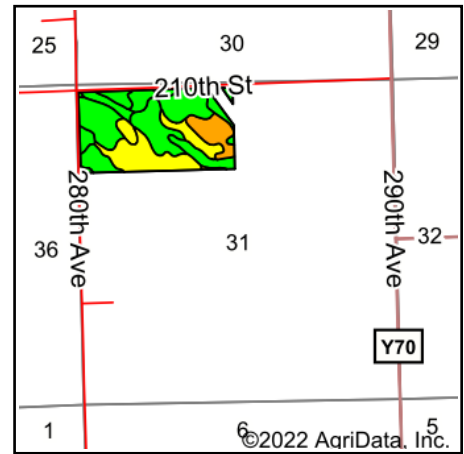

State: **Iowa**  
 County: **Clinton**  
 Location: **31-82N-4E**  
 Township: **De Witt**  
 Acres: **76.84**  
 Date: **7/25/2022**

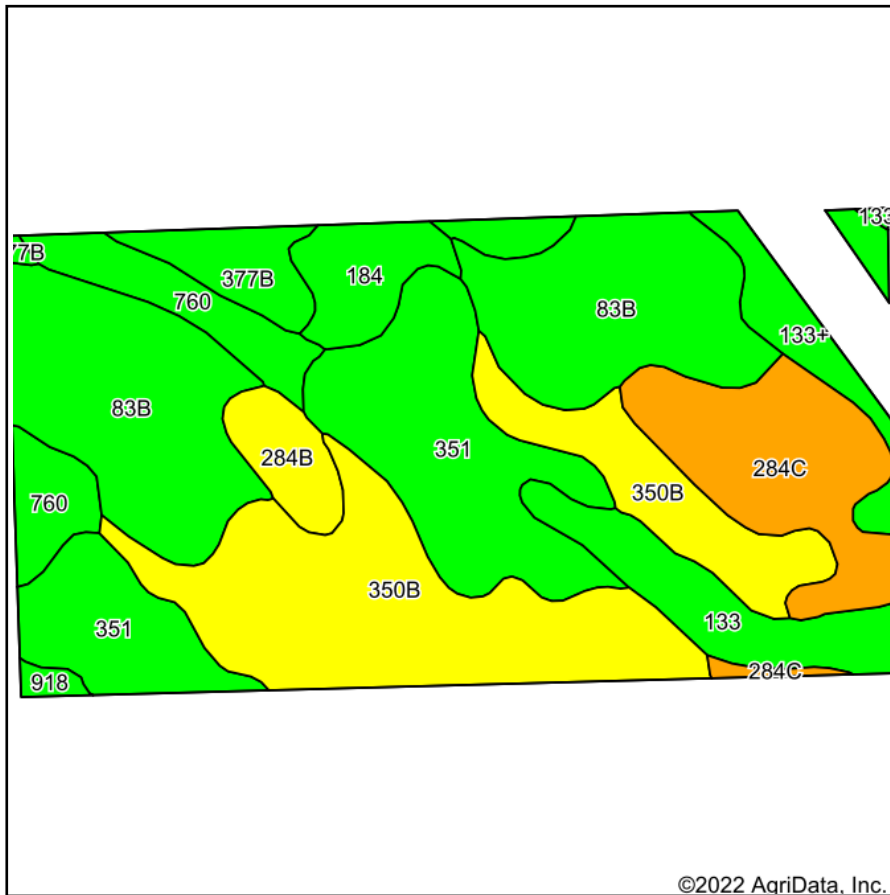

Maps Provided By:



Soils data provided by USDA and NRCS.

Area Symbol: IA045, Soil Area Version: 27

Code	Soil Description	Acres	Percent of field	CSR2 Legend	Non-Irr Class *c	*i Corn Bu	*i Alfalfa Tons	*i Soybeans Bu	CSR2**	Corn Bu	Oats Bu	Soybeans Bu	*n NCCPI Overall
350B	Waukegan silt loam, 2 to 5 percent slopes	17.90	23.3%		Ile	80.0	2.2	23.2	55				81
83B	Kenyon loam, 2 to 5 percent slopes	17.73	23.1%		Ile	225.6	6.3	65.4	90	210	91	61	87
351	Atterberry silt loam, sandy substratum, 0 to 2 percent slopes	13.66	17.8%		Iw	224.0	5.8	65.0	80				92
284C	Flagler sandy loam, 5 to 9 percent slopes	7.57	9.9%		IIle	80.0	2.2	23.2	46				66
133	Colo silty clay loam, 0 to 2 percent slopes, occasionally flooded	4.80	6.2%		IIw	204.8	4.3	59.4	78				77
760	Ansgar silt loam, 0 to 3 percent slopes	4.56	5.9%		IIw	216.0	4.5	62.6	80				97
377B	Dinsdale silt loam, 2 to 5 percent slopes	3.07	4.0%		Ile	232.0	6.5	67.3	95				87
184	Klinger silt loam, 1 to 4 percent slopes	2.64	3.4%		Iw	240.0	6.2	69.6	95				87
133+	Colo silt loam, 0 to 2 percent slopes, occasionally flooded, overwash	2.52	3.3%		IIw	204.8	4.3	59.4	78				82
284B	Flagler sandy loam, 1 to 5 percent slopes	2.04	2.7%		IIle	80.0	2.2	23.2	51				67
918	Garwin silty clay loam, sandy substratum, 0 to 2 percent slopes	0.35	0.5%		IIw	80.0	1.7	23.2	84				94
<b>Weighted Average</b>					<b>1.91</b>	<b>170.7</b>	<b>4.4</b>	<b>49.5</b>	<b>73.3</b>	<b>48.5</b>	<b>21</b>	<b>14.1</b>	<b>*n 83.7</b>

\*\*IA has updated the CSR values for each county to CSR2.

\*i Yield data provided by the ISPAID Database version 8.1.1 developed by IA State University.

\*n: The aggregation method is "Weighted Average using all components"

\*c: Using Capabilities Class Dominant Condition Aggregation Method

Soils data provided by USDA and NRCS.