

Latec Tile



8635 Hwy. 9 Lime Springs, Iowa 52155-8070
Tele. (563) 547-5115
Or (641) 985-4076

Client: Haley Ethel
Farm: Jamestown 16
Field: Latec Tile
Name: November, 2007
Date: 3/12/2020

North

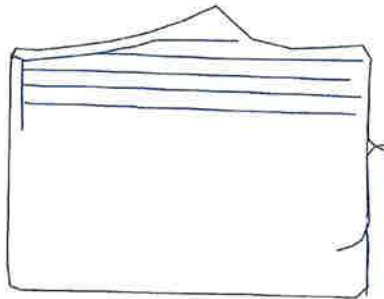
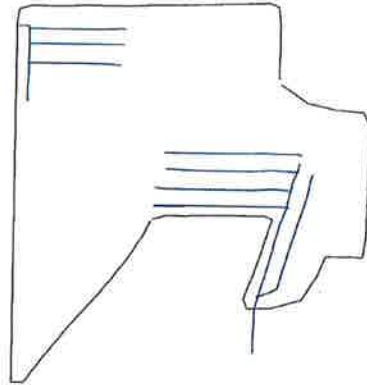
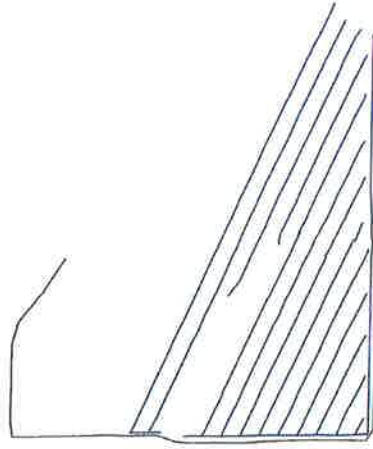

Customer: Marvin Haley		
Location: Howard County - Jamestown 16		
Scale: 350 feet	Spacing: 60	Date: 11/12/07

Mehmert Tiling, Inc.

Office and Shop
Phone [515] 985-4076
Saratoga, Iowa

Route 1
Lime Springs, Iowa 52155

Larry Mehmert
Res. Phone [319] 547-4809
Cresco, Iowa

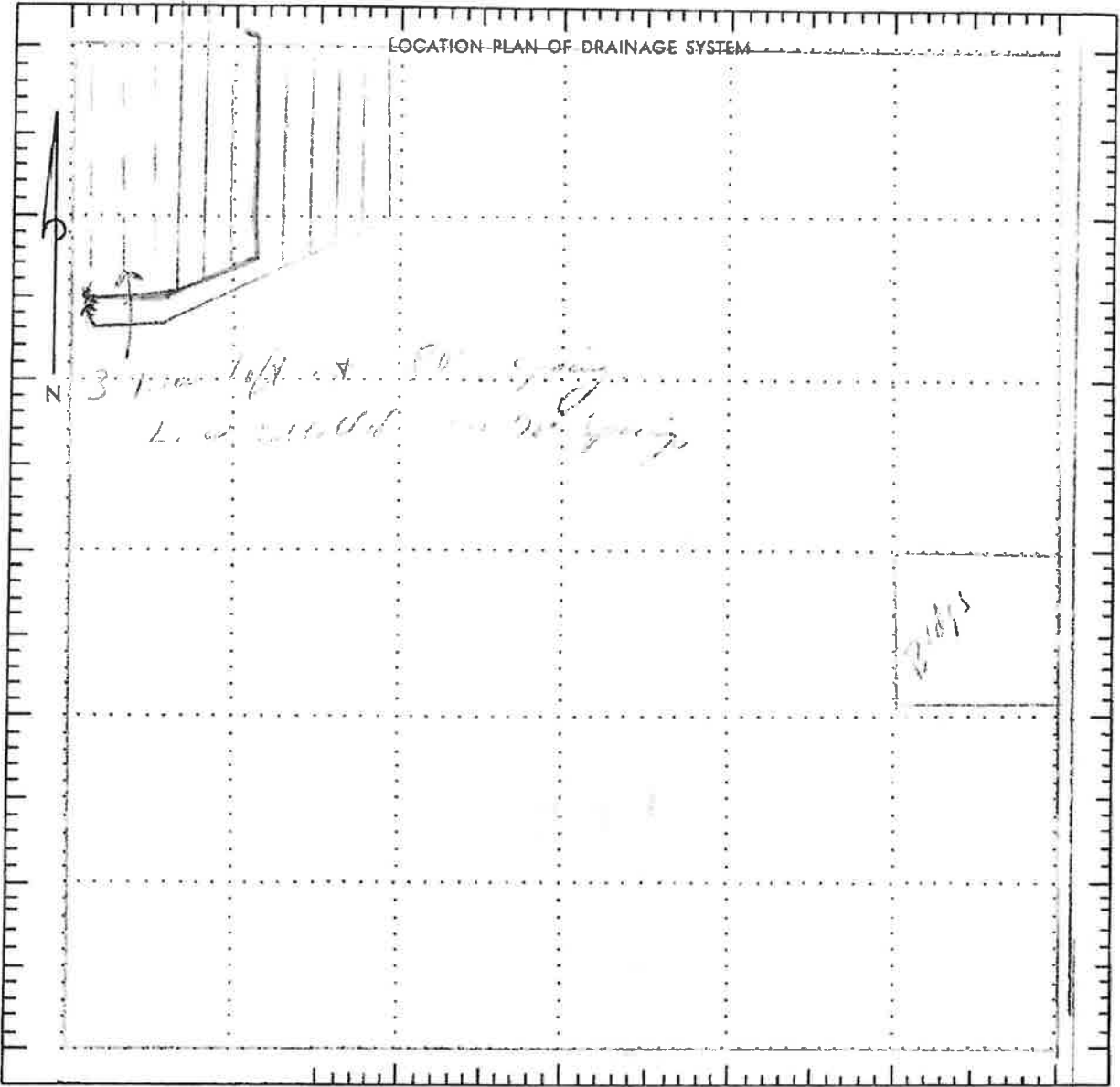

Scale: 1" = 440 feet

Spacing of laterals 70' 4 1/2"

OWNER Marvin Haley
TOWNSHIP Jamestown DATE 12/5/82
SECTION 16 TOWN RR2 Riceville
COUNTY Howard STATE Iowa

MATERIAL NEEDS
_____ 6"
_____ 5"
_____ 4"
_____ proposed 4' laterals

Tiling, backhoe and dozer work, Rock and fill
Link and Zor Tiling Plows-Sales and Service
Dependable. Efficient. Economical