

# FSA Tillable Soils Map

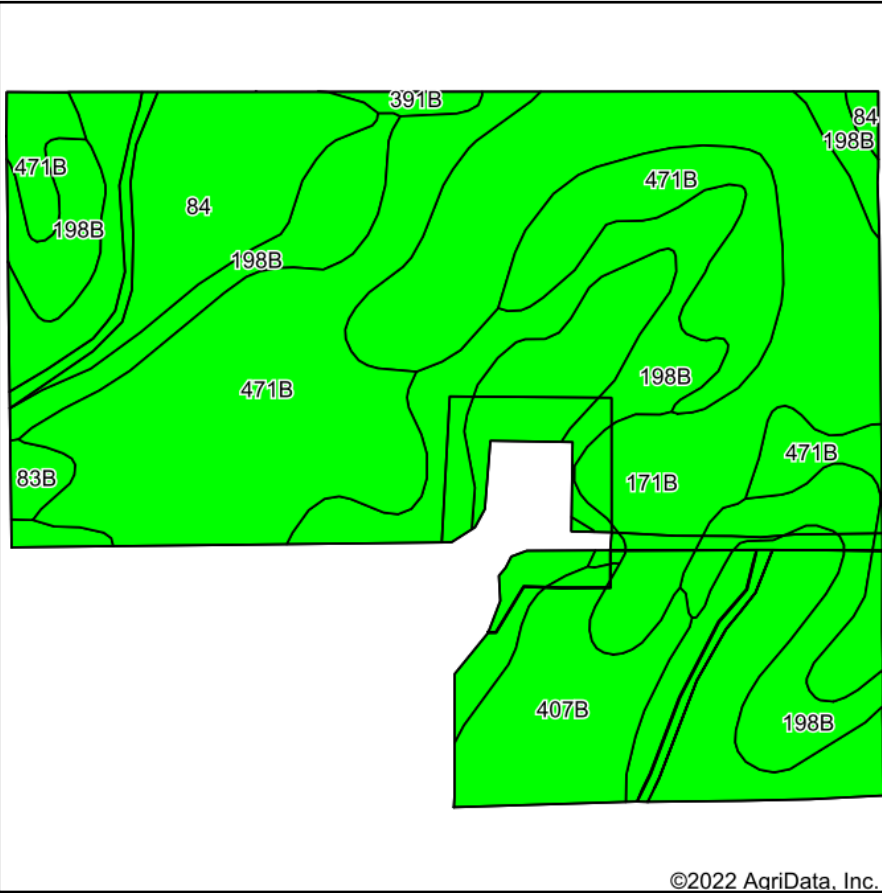

©2022 AgriData, Inc.

Soils data provided by USDA and NRCS.

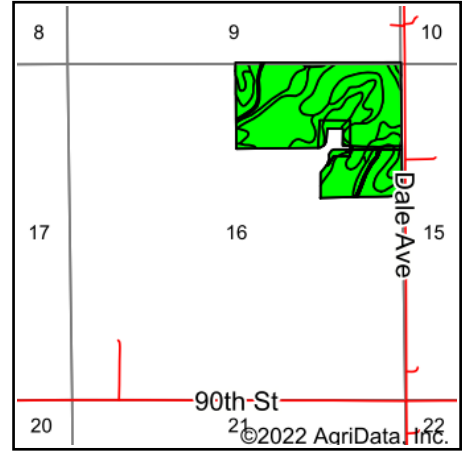

State: **Iowa**  
 County: **Howard**  
 Location: **16-99N-14W**  
 Township: **Jamestown**  
 Acres: **100.19**  
 Date: **7/21/2022**



Maps Provided By:



© AgriData, Inc. 2021

www.AgriDataInc.com



Area Symbol: IA089, Soil Area Version: 29

Code	Soil Description	Acres	Percent of field	CSR2 Legend	Non-Irr Class *c	CSR2**	CSR	*n NCCPI Overall	*n NCCPI Corn	*n NCCPI Soybeans	
471B	Oran loam, 2 to 5 percent slopes	27.59	27.5%		lw	74	78	80	80	59	
84	Clyde silty clay loam, 0 to 3 percent slopes	23.71	23.7%		llw	88	73	90	90	85	
198B	Floyd loam, 1 to 4 percent slopes	20.52	20.5%		llw	89	78	85	81	85	
171B	Bassett loam, 2 to 5 percent slopes	20.29	20.3%		lle	85	78	88	88	76	
407B	Schley silt loam, 1 to 4 percent slopes	6.77	6.8%		llw	81	70	96	96	86	
83B	Kenyon loam, 2 to 5 percent slopes	0.76	0.8%		lle	90	83	87	87	72	
391B	Clyde-Floyd complex, 1 to 4 percent slopes	0.55	0.5%		llw	87	70	88	86	85	
<b>Weighted Average</b>						<b>1.72</b>	<b>83.3</b>	<b>76.3</b>	<b>*n 86.2</b>	<b>*n 85.4</b>	<b>*n 76</b>

\*\*IA has updated the CSR values for each county to CSR2.

\*n: The aggregation method is "Weighted Average using all components"

\*c: Using Capabilities Class Dominant Condition Aggregation Method

Soils data provided by USDA and NRCS.