

# FSA Tillable Soils Map

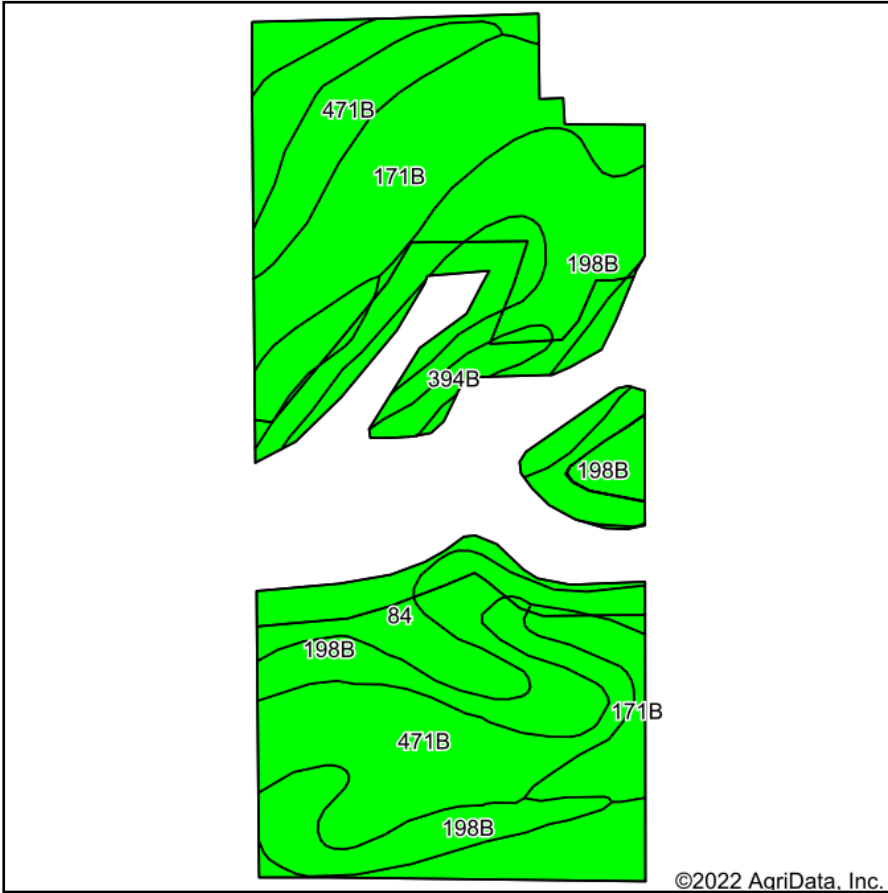

Soils data provided by USDA and NRCS.

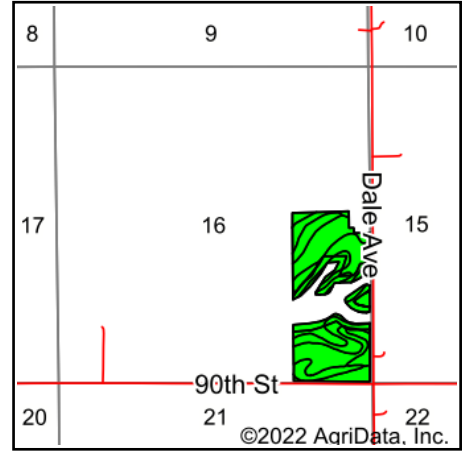

State: **Iowa**  
 County: **Howard**  
 Location: **16-99N-14W**  
 Township: **Jamestown**  
 Acres: **64.9**  
 Date: **7/21/2022**



Maps Provided By:



© AgriData, Inc. 2021

www.AgriDataInc.com



Area Symbol: IA089, Soil Area Version: 29

Code	Soil Description	Acres	Percent of field	CSR2 Legend	Non-Irr Class *c	CSR2**	CSR	*n NCCPI Overall	*n NCCPI Corn	*n NCCPI Soybeans	
198B	Floyd loam, 1 to 4 percent slopes	24.15	37.2%		Ilw	89	78	85	81	85	
471B	Oran loam, 2 to 5 percent slopes	14.76	22.7%		Iw	74	78	80	80	59	
171B	Bassett loam, 2 to 5 percent slopes	12.34	19.0%		Ile	85	78	88	88	76	
84	Clyde silty clay loam, 0 to 3 percent slopes	12.33	19.0%		Ilw	88	73	90	90	85	
394B	Ostrander loam, 2 to 5 percent slopes	1.32	2.0%		Ile	88	83	77	77	67	
<b>Weighted Average</b>						<b>1.77</b>	<b>84.6</b>	<b>77.2</b>	<b>*n 85.2</b>	<b>*n 83.7</b>	<b>*n 77</b>

\*\*IA has updated the CSR values for each county to CSR2.

\*n: The aggregation method is "Weighted Average using all components"

\*c: Using Capabilities Class Dominant Condition Aggregation Method

Soils data provided by USDA and NRCS.