

Soils Map

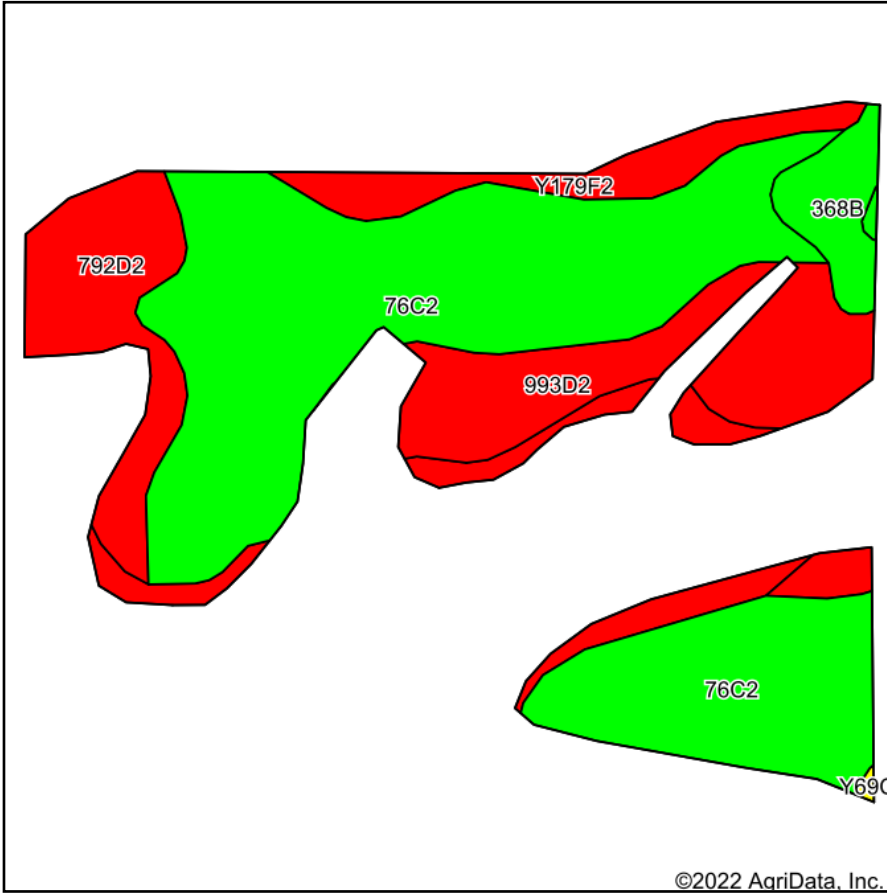

Soils data provided by USDA and NRCS.

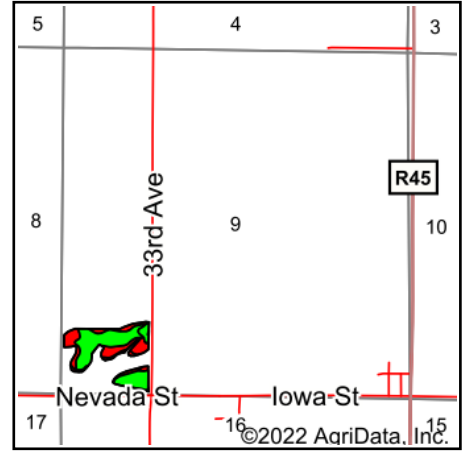

State: **Iowa**
 County: **Warren**
 Location: **9-75N-25W**
 Township: **Jackson**
 Acres: **16.17**
 Date: **7/27/2022**



Maps Provided By:



© AgriData, Inc. 2021

www.AgriDataInc.com



Area Symbol: IA181, Soil Area Version: 26

Code	Soil Description	Acres	Percent of field	CSR2 Legend	Non-Irr Class *c	CSR2**	CSR	*n NCCPI Overall	*n NCCPI Corn	*n NCCPI Small Grains	*n NCCPI Soybeans
76C2	Ladoga silt loam, dissected till plain, 5 to 9 percent slopes, eroded	9.22	57.0%		IIIe	75	65	78	78	69	66
993D2	Armstrong-Gara loams, 9 to 14 percent slopes, moderately eroded	2.56	15.8%		IVe	23	20	68	68	52	47
Y179F2	Gara loam, dissected till plain, 18 to 25 percent slopes, eroded	1.98	12.2%		VIIe	16		57	57	36	38
792D2	Armstrong loam, 9 to 14 percent slopes, moderately eroded	1.73	10.7%		IVe	7	13	65	65	51	43
368B	Macksburg silty clay loam, 2 to 5 percent slopes	0.68	4.2%		Ile	89	90	87	87	79	78
Weighted Average						3.71	52.9	*n 72.8	*n 72.8	*n 60.8	*n 57.6

**IA has updated the CSR values for each county to CSR2.

*- CSR weighted average cannot be calculated on the current soils data, use prior data version for csr values.

*n: The aggregation method is "Weighted Average using all components"

*c: Using Capabilities Class Dominant Condition Aggregation Method

Soils data provided by USDA and NRCS.