

Soils Map - Tract 4 - Total Acres

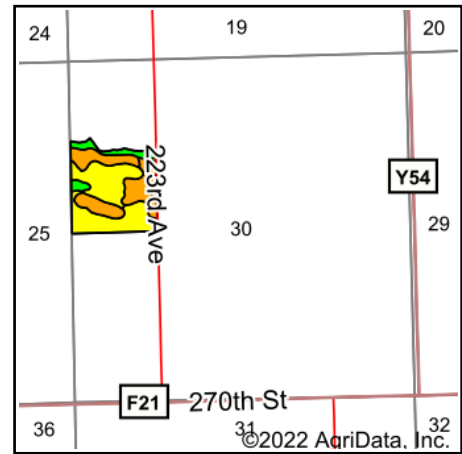

State: **Iowa**
 County: **Clinton**
 Location: **30-81N-3E**
 Township: **Orange**
 Acres: **39.5**
 Date: **9/15/2022**

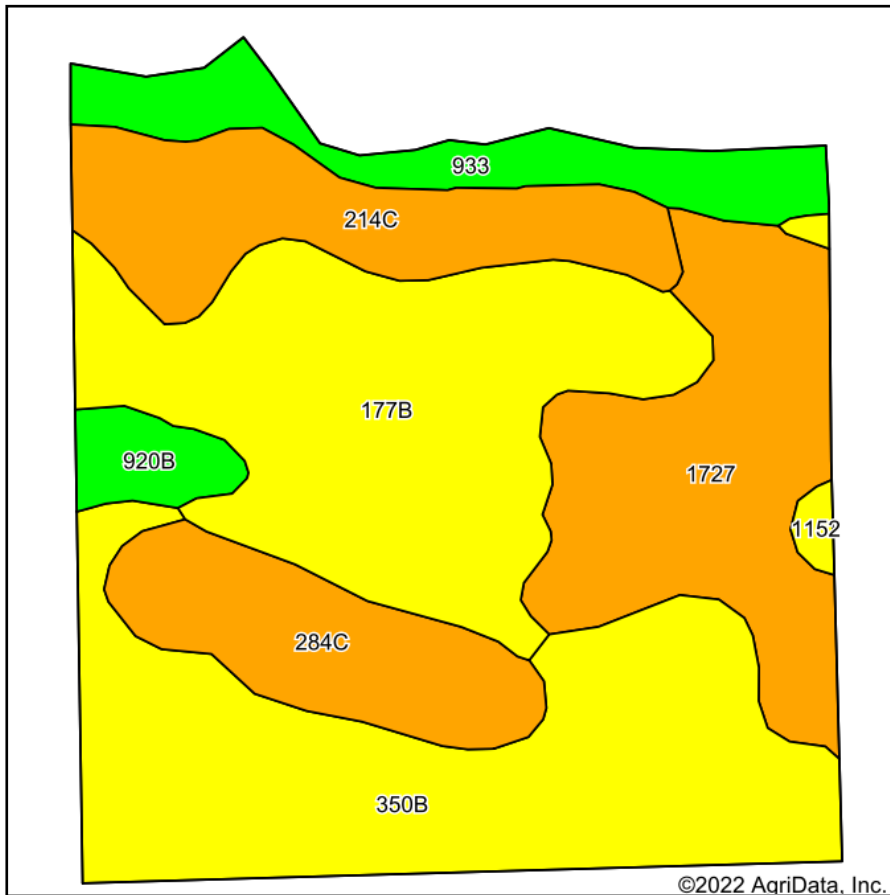

Soils data provided by USDA and NRCS.

Area Symbol: IA045, Soil Area Version: 27

Code	Soil Description	Acres	Percent of field	CSR2 Legend	Non-Irr Class *c	*i Corn Bu	*i Alfalfa Tons	*i Soybeans Bu	CSR2**	Corn Bu	Oats Bu	Soybeans Bu	*n NCCPI Overall	
350B	Waukegan silt loam, 2 to 5 percent slopes	10.66	27.0%		Ile	80.0	2.2	23.2	55				81	
177B	Saude loam, 2 to 5 percent slopes	10.11	25.6%		Ils	80.0	2.2	23.2	55				76	
1727	Udolpho loam, 0 to 2 percent slopes	6.58	16.7%		Ilw	80.0	1.7	23.2	48				83	
214C	Rockton loam, 20 to 30 inches to limestone, 5 to 9 percent slopes	4.45	11.3%		IIle	80.0	2.2	23.2	44				71	
284C	Flagler sandy loam, 5 to 9 percent slopes	3.60	9.1%		IIIle	80.0	2.2	23.2	46				66	
933	Sawmill silty clay loam, shallow loess, 0 to 2 percent slopes, occasionally flooded	2.89	7.3%		Ilw	204.8	4.3	59.4	78				77	
920B	Tama silt loam, sandy substratum, 2 to 5 percent slopes	0.93	2.4%		Ile	232.0	6.5	67.3	92				97	
1152	Marshan clay loam, 0 to 2 percent slopes, rarely flooded	0.28	0.7%		Ilw	80.0	1.7	23.2	54	90	57	30	82	
Weighted Average						2.20	92.7	2.4	26.9	54.3	0.6	0.4	0.2	*n 77.7

**IA has updated the CSR values for each county to CSR2.

*i Yield data provided by the ISPAID Database version 8.1.1 developed by IA State University.

*n: The aggregation method is "Weighted Average using all components"

*c: Using Capabilities Class Dominant Condition Aggregation Method

Soils data provided by USDA and NRCS.