

Soils Map

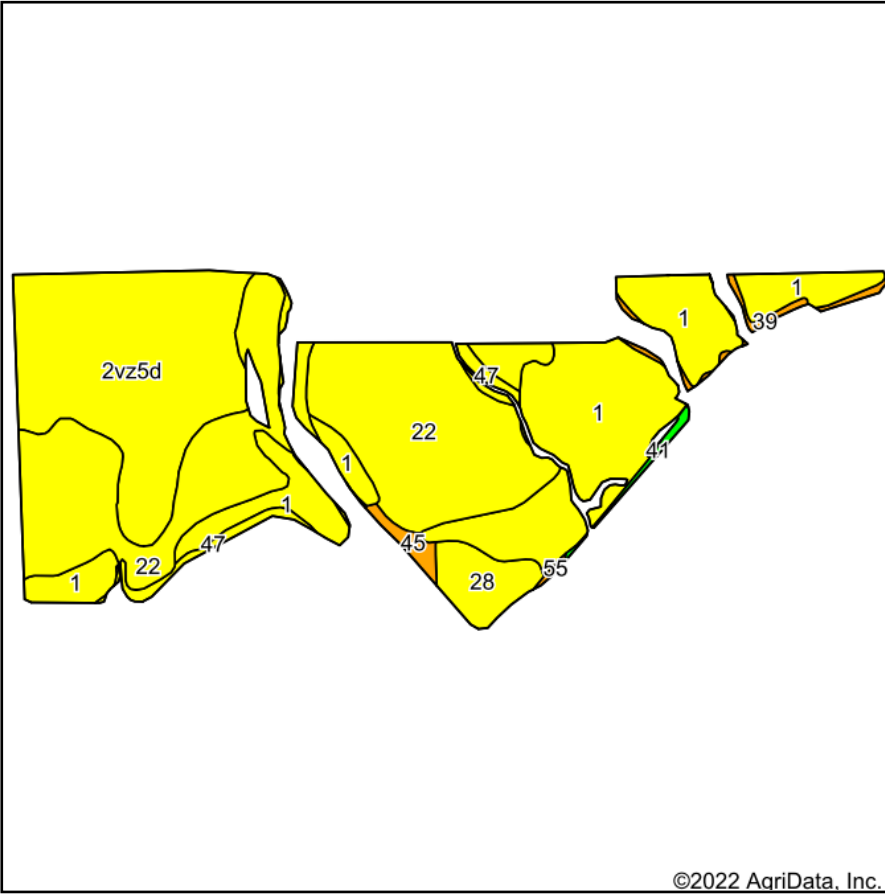

Soils data provided by USDA and NRCS.

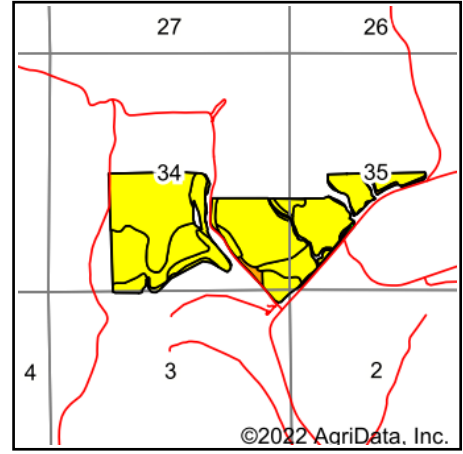

State: **Washington**
 County: **Whitman**
 Location: **34-18N-41E**
 Township: **Rock Lake**
 Acres: **251.89**
 Date: **8/25/2022**



Maps Provided By:



Area Symbol: WA075, Soil Area Version: 19

Code	Soil Description	Acres	Percent of field	Non-Irr Class Legend	Non-Irr Class *c	*n NCCPI Overall
22	Calouse silt loam, 7 to 25 percent slopes	89.96	35.7%		IVe	40
1	Almota silt loam, 7 to 25 percent slopes	73.28	29.1%		IVe	29
2vz5d	Athena silt loam, 7 to 25 percent slopes	68.99	27.4%		IVe	40
28	Chard silt loam, 15 to 25 percent slopes	8.80	3.5%		IVe	22
47	Kuhl-Asotin complex, 7 to 30 percent slopes	4.65	1.8%		VIIs	14
39	Gwin-Linville complex, 30 to 65 percent slopes	2.51	1.0%		VIIe	5
45	Kuhl-Alpowa complex, 30 to 65 percent slopes	2.24	0.9%		VIIe	4
41	Hermiston silt loam	1.15	0.5%		IIIs	33
55	Linville silt loam, 30 to 65 percent slopes	0.31	0.1%		VIIe	7
Weighted Average					4.09	*n 34.9

*n: The aggregation method is "Weighted Average using all components"

*c: Using Capabilities Class Dominant Condition Aggregation Method

Soils data provided by USDA and NRCS.