

# Soils Map

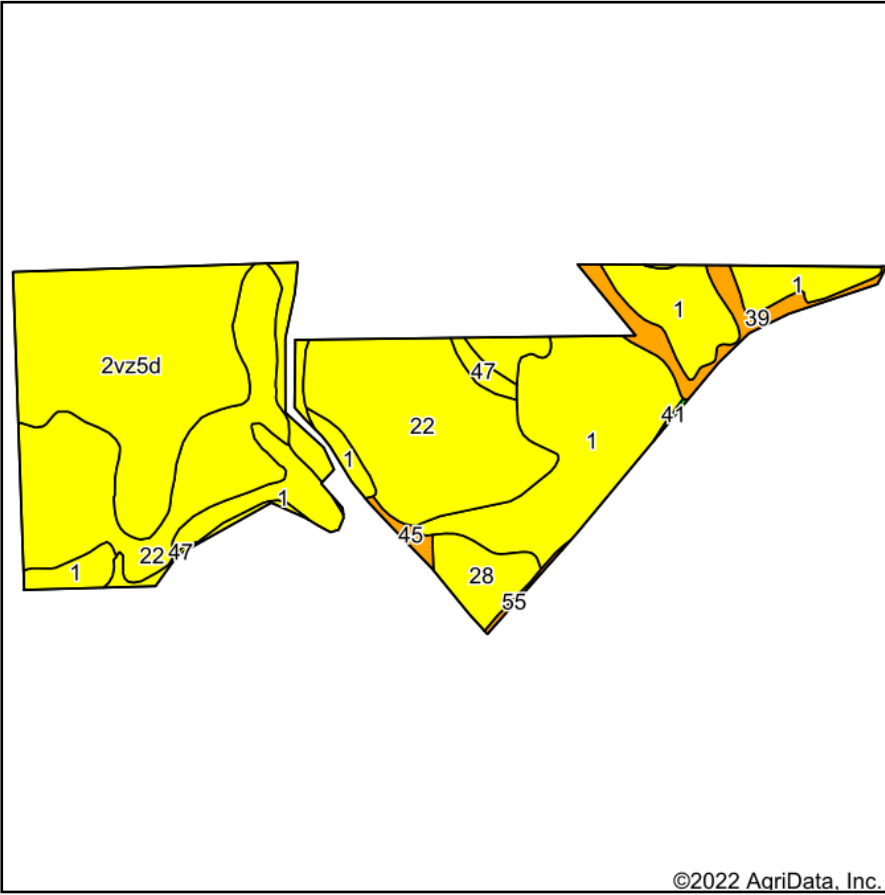

Soils data provided by USDA and NRCS.

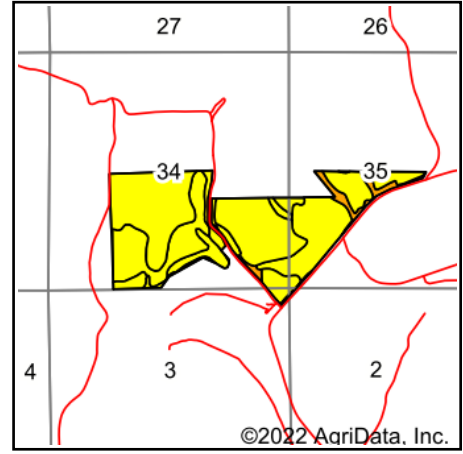

State: **Washington**  
 County: **Whitman**  
 Location: **34-18N-41E**  
 Township: **Rock Lake**  
 Acres: **261**  
 Date: **9/12/2022**



Maps Provided By:



© AgriData, Inc. 2021

www.AgriDataInc.com



Area Symbol: WA075, Soil Area Version: 19

Code	Soil Description	Acres	Percent of field	Non-Irr Class Legend	Non-Irr Class *c	*n NCCPI Overall
22	Calouse silt loam, 7 to 25 percent slopes	90.46	34.7%		IVe	40
1	Almota silt loam, 7 to 25 percent slopes	74.51	28.5%		IVe	29
2vz5d	Athena silt loam, 7 to 25 percent slopes	71.28	27.3%		IVe	40
39	Gwin-Linville complex, 30 to 65 percent slopes	9.14	3.5%		VIIe	5
28	Chard silt loam, 15 to 25 percent slopes	8.95	3.4%		IVe	22
47	Kuhl-Asotin complex, 7 to 30 percent slopes	4.21	1.6%		VIIs	14
45	Kuhl-Alpowa complex, 30 to 65 percent slopes	1.65	0.6%		VIIe	4
55	Linville silt loam, 30 to 65 percent slopes	0.57	0.2%		VIIe	7
41	Hermiston silt loam	0.23	0.1%		IIIs	33
<b>Weighted Average</b>					<b>4.16</b>	<b>*n 34.3</b>

\*n: The aggregation method is "Weighted Average using all components"

\*c: Using Capabilities Class Dominant Condition Aggregation Method

Soils data provided by USDA and NRCS.