

SOUTHWEST PART  
NORTHEAST PART  
**DARLINGTON**  
**SHULLSBURG**

NORTHWEST PART  
**GRATIOT** T.2N.-R.3E.

Refer to page 46 for keyed parcels

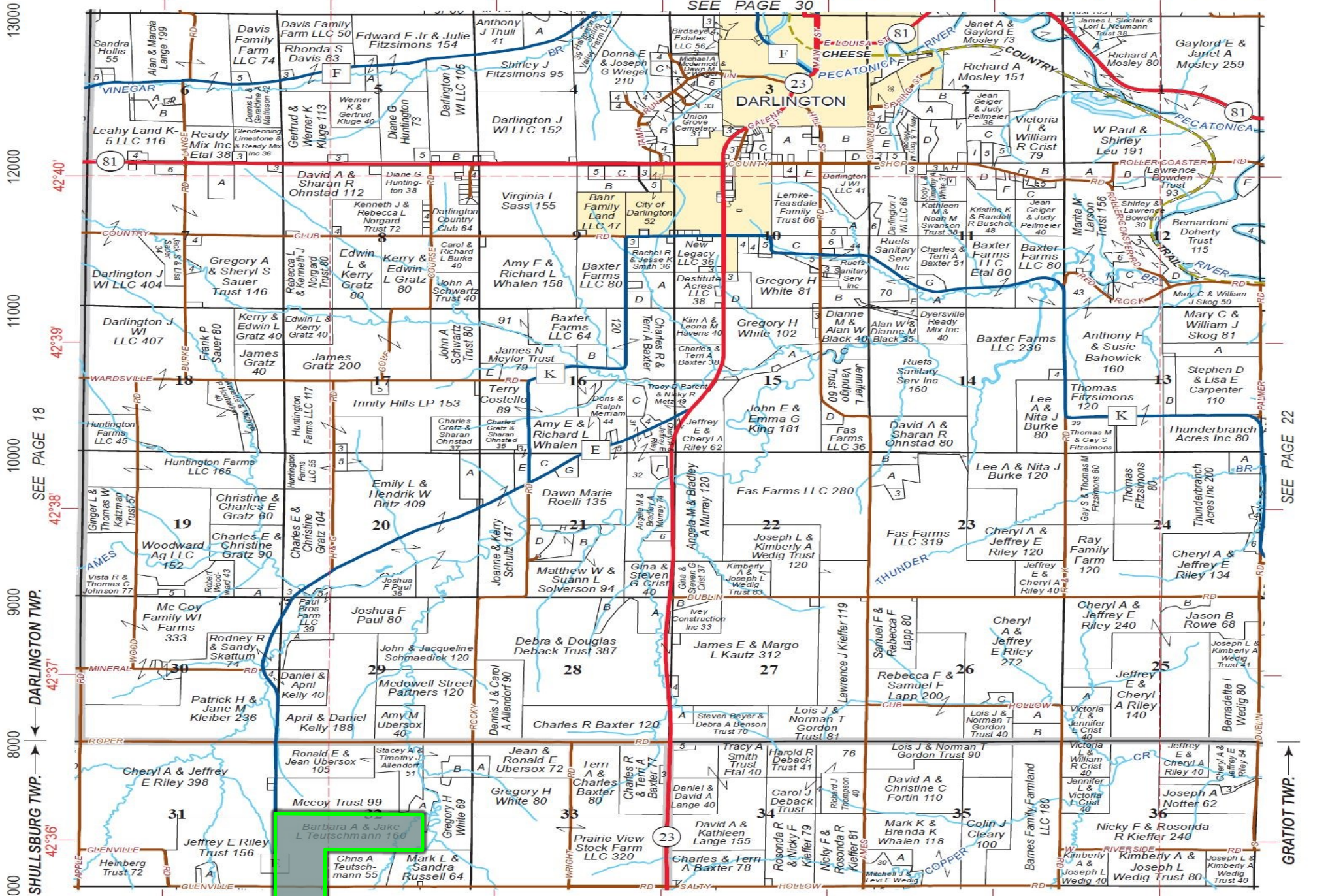
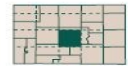

13000  
12000  
11000  
10000  
9000  
8000  
7000

42°40'  
42°39'  
42°38'  
42°37'  
42°36'

90°11' 90°10' 90°09' 90°08' 90°07' 90°06' 90°05'

© 2020 Rockford Map Publs., Inc.

SEE PAGE 10

Lafayette County, WI

SEE PAGE 22  
GRATIOT TWP.

SEE PAGE 18  
DARLINGTON TWP.  
SHULLSBURG TWP.

SEE PAGE 30