

Tillable Soils Map

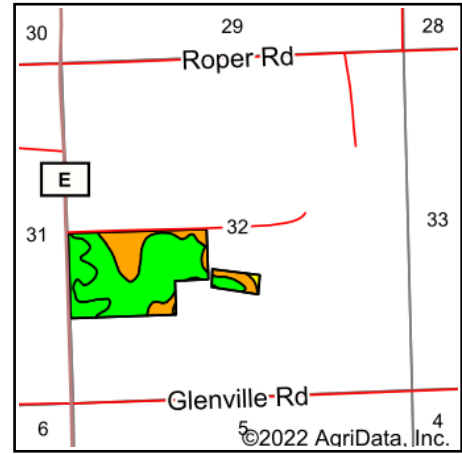

State: **Wisconsin**
 County: **Lafayette**
 Location: **32-2N-3E**
 Township: **Shullsburg**
 Acres: **63.75**
 Date: **9/2/2022**

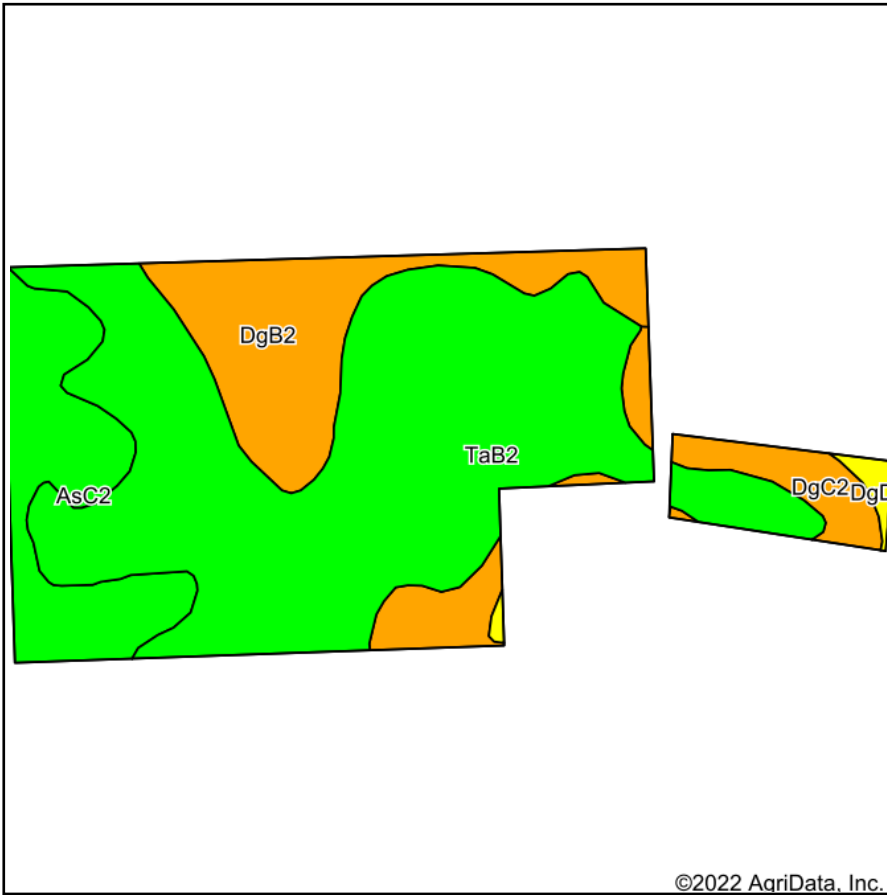

Maps Provided By:



Soils data provided by USDA and NRCS.

Area Symbol: WI065, Soil Area Version: 18

Code	Soil Description	Acres	Percent of field	NCCPI Overall Legend	Non-Irr Class	*n NCCPI Overall
TaB2	Tama silt loam, driftless, 2 to 6 percent slopes, moderately eroded	38.50	60.4%		Ile	90
DgB2	Dodgeville silt loam, 2 to 6 percent slopes, moderately eroded	10.18	16.0%		Ile	63
AsC2	Ashdale silt loam, 6 to 12 percent slopes, moderately eroded	9.05	14.2%		IIIe	84
DgC2	Dodgeville silt loam, 6 to 12 percent slopes, moderately eroded	5.40	8.5%		IIIe	62
DgD2	Dodgeville silt loam, 12 to 20 percent slopes, moderately eroded	0.62	1.0%		IVe	57
Weighted Average					2.25	*n 82.1

*n: The aggregation method is "Weighted Average using all components"
 Soils data provided by USDA and NRCS.